

The background of the entire advertisement is a close-up, high-contrast image of flames. The fire is dark red and orange, with bright yellow and white highlights at the tips of the tongues of fire. The flames are swirling and rising, creating a sense of intense heat and movement. The overall color palette is dominated by dark reds, oranges, and blacks, with the bright colors of the fire providing a stark contrast.

**TAMLYN®**  
FAMILY. VALUE. SERVICE.

# XTREMEINTERIOR FIRE RATED PROFILES

**TAMLYN®**

Address: 13623 Pike Rd, Stafford, TX 77477 Phone: USA Toll Free (800) 334-1676 Fax: (281) 499-8948 E-mail: [info@tamlyn.com](mailto:info@tamlyn.com)  
[www.tamlyn.com](http://www.tamlyn.com)

**XtremeInterior: Fire Rated Profiles**  
**MZRFR - FIRE RATED Z MOLD**

Contact Marcus Armenta - 562.484.8752  
 www.tamlyn.com

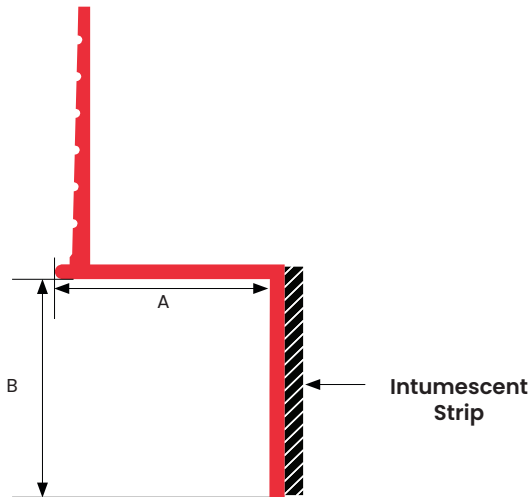

**XtremeInterior by Tamlyn** is proud to be the first to offer **Fire Rated Profiles** to enhance our extensive catalog of extruded aluminum trim! The addition of a factory applied intumescent strip along the back wall of the profile enables drywall designs to achieve 1 hour and 2 hour fire ratings without the requirement of an extra layer of drywall. The intumescent strip expands when exposed to increased heat during a fire and will completely seal off the gap in drywall preventing the passage of fire.

**XtremeInterior Fire Rated Profiles** have been 3rd party fire tested per ASTM E119, Standard Test Methods for Fire Test of Building Construction and Materials are listed under report number WFCi Report #20091.

PATENT NUMBER: 9,371,644

**DESIGN FEATURES**

Versatile shadow line piece. Ideal for transitioning between drywall and other materials or drywall and floors. Ridged face provided for tape and float and pre-punched holes for easy install (hole placement may vary). Can be used in conjunction with drywall, panel installation and wrapped surface finishes such as fabric or vinyl wall coverings.

Available in 10' length. 6063 T5 aluminum with standard clear anodized or primed finish. Anodized color and powder coating finishes available with custom color matching.

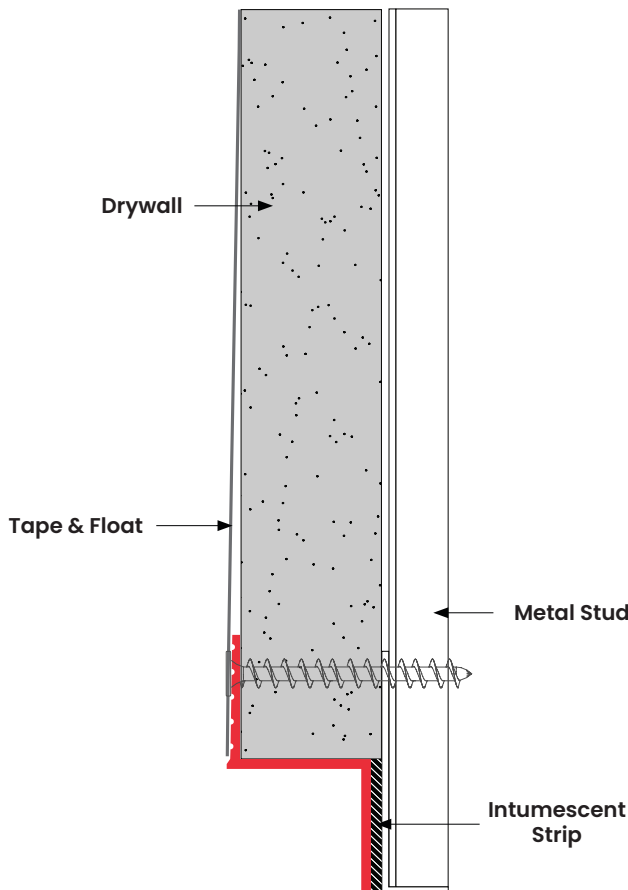

ITEM ID	A	B
MZRFR14-14	1/4"	1/4"
MZRFR5-12	1/2"	1/2"
MZRFR5-100	1/2"	1"
MZRFR-14	5/8"	1/4"
MZRFR-12	5/8"	1/2"
MZRFR-100	5/8"	1"

**XtremeInterior: Fire Rated Profiles**  
**MCRFR - FIRE RATED C MOLD**

Contact Marcus Armenta - 562.484.8752  
 www.tamlyn.com

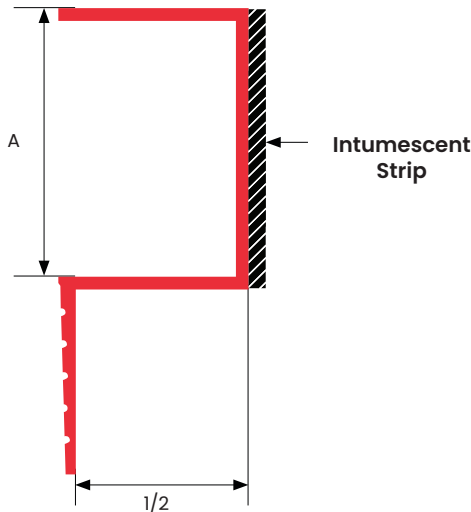

**XtremeInterior by Tamlyn** is proud to be the first to offer **Fire Rated Profiles** to enhance our extensive catalog of extruded aluminum trim! The addition of a factory applied intumescent strip along the back wall of the profile enables drywall designs to achieve 1 hour and 2 hour fire ratings without the requirement of an extra layer of drywall. The intumescent strip expands when exposed to increased heat during a fire and will completely seal off the gap in drywall preventing the passage of fire.

**XtremeInterior Fire Rated Profiles** have been 3rd party fire tested per ASTM E119, Standard Test Methods for Fire Test of Building Construction and Materials are listed under report number WFCi Report #20091.

PATENT NUMBER: 9,371,644

**DESIGN FEATURES**

Clean finish design with reveal detail for drywall terminations at ceilings, windows, doors and other material transitions. Can be installed horizontally or vertically. Can be used in conjunction with 5/8" drywall, panel installation and with wrapped surface finishes such as fabric or vinyl wall coverings. Ridged faces for tape & float and pre-punched holes for easy install (hole placement may vary).

Available in 10' length. 6063 T5 aluminum with standard clear anodized or primed finish. Anodized color and powder coating finishes available with custom color matching.

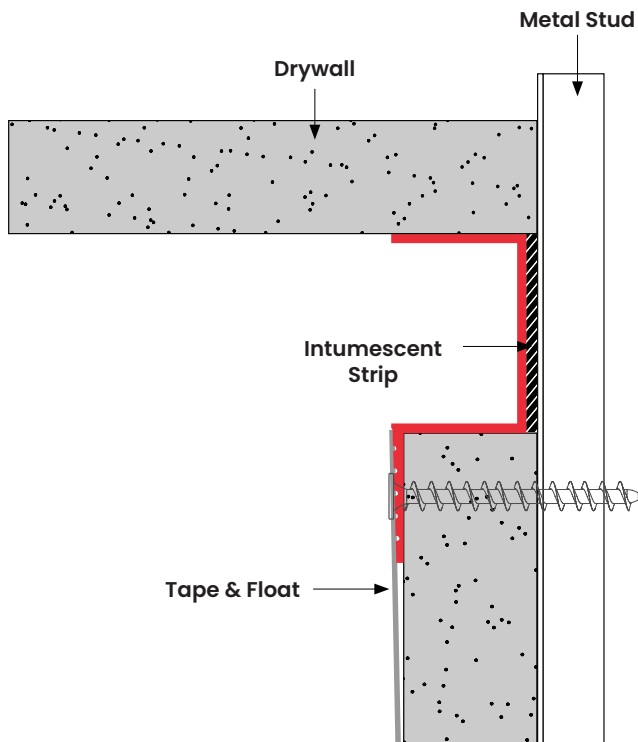

ITEM ID	A	B
MCRFR-12	1/2"	5/8"
MCRFR-58	5/8"	5/8"
MCRFR5-14	1/4"	1/2"
MCRFR5-12	1/2"	1/2"
MCRFR5-100	1"	1/2"

**XtremeInterior: Fire Rated Profiles**  
**RVFR - FIRE RATED REVEAL**

Contact Marcus Armenta - 562.484.8752  
 www.tamlyn.com

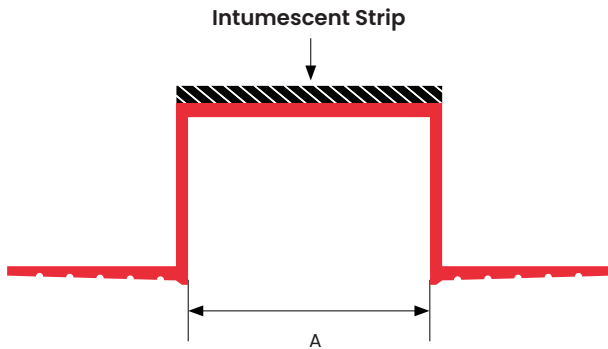

**XtremeInterior by Tamlyn** is proud to be the first to offer **Fire Rated Profiles** to enhance our extensive catalog of extruded aluminum trim! The addition of a factory applied intumescent strip along the back wall of the profile enables drywall designs to achieve 1 hour and 2 hour fire ratings without the requirement of an extra layer of drywall. The intumescent strip expands when exposed to increased heat during a fire and will completely seal off the gap in drywall preventing the passage of fire.

**XtremeInterior Fire Rated Profiles** have been 3rd party fire tested per ASTM E119, Standard Test Methods for Fire Test of Building Construction and Materials are listed under report number WFCi Report #20091.

PATENT NUMBER: 9,371,644

**DESIGN FEATURES**

Creates a minimalist shadow line with simple reveal space that allows installation vertically, horizontally or diagonally. Can be used in conjunction with 5/8" drywall, panel installation and wrapped surface finishes such as fabric or vinyl wall coverings. Ridged faces for tape & float and pre-punched holes for easy install (hole placement may vary).

Available in 10' length. 6063 T5 aluminum with standard clear anodized or primed finish. Anodized color and powder coating finishes available with custom color matching.

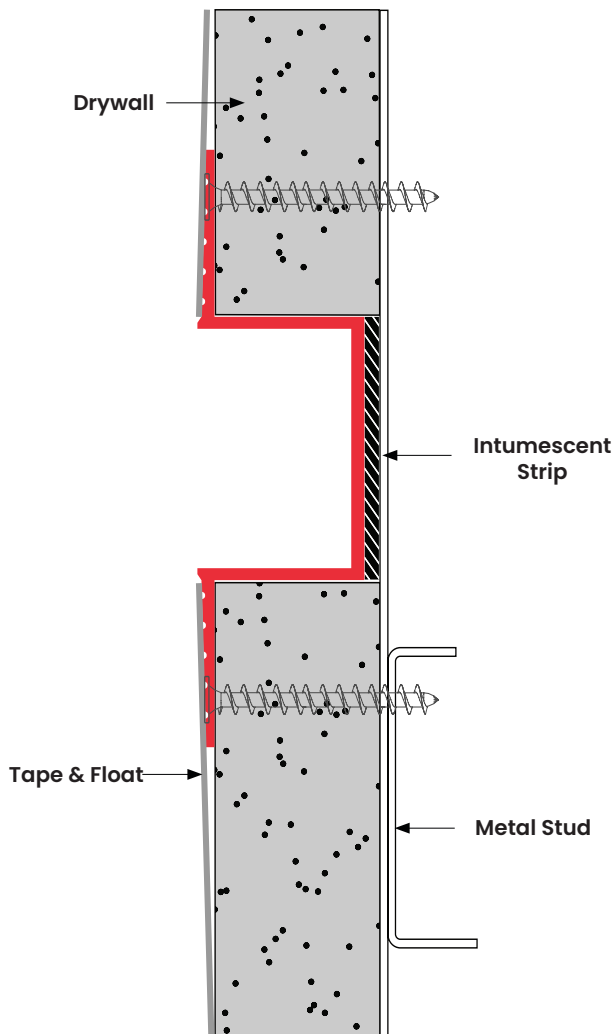

ITEM ID	A
RVFR14	1/4"
RVFR12	1/2"
RVFR100	1"

**XtremeInterior: Fire Rated Profiles**

Contact Marcus Armenta - 562.484.8752  
 www.tamlyn.com

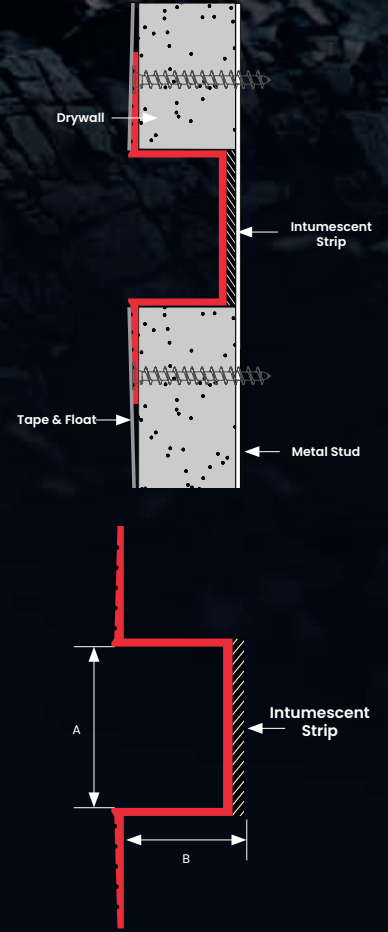
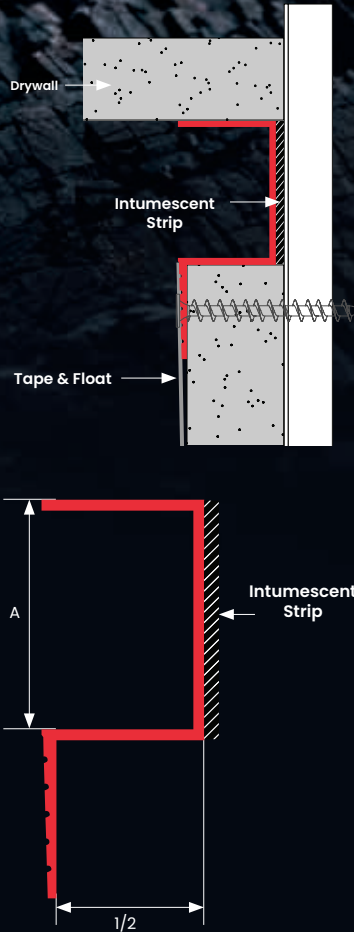
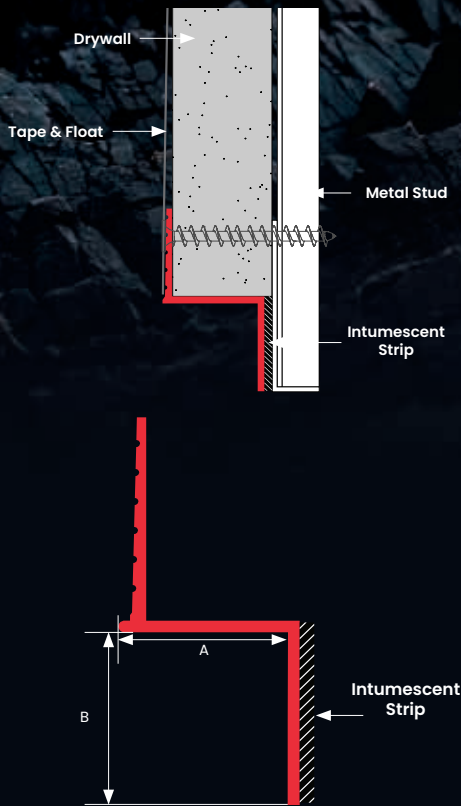

ITEM ID	A	B
MZRFR14-14	1/4"	1/4"
MZRFR5-12	1/2"	1/2"
MZRFR5-100	1/2"	1"
MZRFR-14	5/8"	1/4"
MZRFR-12	5/8"	1/2"
MZRFR-100	5/8"	1"

ITEM ID	A	B
MCRFR-12	1/2"	5/8"
MCRFR-58	5/8"	5/8"
MCRFR5-14	1/4"	1/2"
MCRFR5-12	1/2"	1/2"
MCRFR5-100	1"	1/2"

ITEM ID	A
RVFR14	1/4"
RVFR12	1/2"
RVFR100	1"

**XtremeInterior by Tamlyn** is proud to be the first to offer **Fire Rated Profiles** to enhance our extensive catalog of extruded aluminum trim! The addition of a factory applied intumescent strip along the back wall of the profile enables drywall designs to achieve 1 hour and 2 hour fire ratings without the requirement of an extra layer of drywall. The intumescent strip expands when exposed to increased heat during a fire and will completely seal off the gap in drywall preventing the passage of fire.

**XtremeInterior Fire Rated Profiles** have been 3rd party fire tested per ASTM E119, Standard Test Methods for Fire Test of Building Construction and Materials are listed under report number WFCi Report #20091.

PATENT NUMBER: 9,371,644