

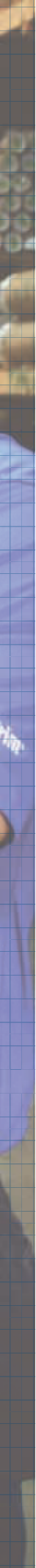

TAMLYN®

FAMILY. VALUE. SERVICE.

TAMLYN® is celebrating over 50 years of excellence in the building supply industry! In May 1971 Ron Tamlyn, Sr. and his wife Jean borrowed \$800 and began the company in a small shack in the back yard of their modest home in Bellaire, Texas. Ron Tamlyn, Sr. was the company's president from 1971 until his son, Tom Tamlyn, took the reins as president in 1990. TAMLYN has become a multi-million dollar, international business with a full product line to match. Tom Tamlyn retired in late 2022 and Miguel Gonzales now serves as CEO and President. TAMLYN remains family-owned and operated to this day. Our history is one of quality, innovation, and proven performance.



XTREMETRIM[®]

Exterior Aluminum Trim

Best Practice

While we design all our XtremeTrim® with drainage paths for vertical runs and shingle fashion for horizontal profiles, its primary design is for aesthetics. XtremeTrim®, including water management profiles, will not stop all water from penetrating the surface of the cladding. The primary insurance of moisture mitigation for the building envelope is your wrap, preferably a drainable wrap. Other options are to create a rainscreen utilizing furring along with your wrap. We recommend that you consult your siding manufacturer for best practice application when installing XtremeTrim® with their siding. As all building professionals know, water is the most significant factor in the premature deterioration of buildings, and why proper steps should always be taken to protect the envelope.

All standard XtremeTrim® profiles do not form a moisture management system. The architect, builder, designer and contractor are responsible for designing and installing a code compliant building envelope. Below are the current code minimum requirements.

Tamlyn XtremeTrim® products are not part of an EIFS system and not designed or intended to be used in an EIFS or similar system.

INTERNATIONAL RESIDENTIAL CODE**WALL COVERING – SECTION R703 EXTERIOR COVERING****R703.1 General.**

Exterior walls shall provide the building with a weather-resistant exterior wall envelope. The exterior wall envelope shall include flashing as described in Section R703.8

The exterior wall envelope shall be designed and constructed in such a manner that prevents the accumulation of water within the wall assembly by providing a water-resistant barrier behind the exterior veneer as required by Section R703.2 and a means of draining water that enters the assembly to the exterior.

R703.8. Flashing.

Approved corrosion-resistant flashing shall be applied shingle-fashion in such a manner to prevent entry of water into the wall cavity or penetration of water to the building structural framing components. The flashing shall extend to the surface of the exterior wall finish. Approved corrosion-resistant flashings shall be installed at all of the following locations.

EXTERIOR WALLS – SECTION 1403 PERFORMANCE REQUIREMENTS**IBC 1403.2:**

Weather protection. Exterior walls shall provide the building with a weather resistant exterior wall envelope. The exterior wall envelope shall include flashing, as described in Section 1405.3. The exterior wall envelope shall be designed and constructed in such a manner as to prevent the accumulation of water within the wall assembly by providing a water-resistant barrier behind the exterior veneer, as described in Section 1404.2, and a means for draining water that enters the assembly to the exterior. Protection against condensation in the exterior wall assembly shall be provided in accordance with the International Energy Conservation Code.

Before Installing

Review construction documents to ensure correct layout and placement of trim. Visually inspect building wrap or rainscreen (where applicable) for proper installation.

An inside corner is the best place to start installing XtremeTrim®.

Cutting

Use a non-ferrous carbide miter saw blade when cutting XtremeTrim®.

Fasteners and Fastening

Stainless steel fasteners are recommended. XtremeTrim® profiles may be secured in place with a few SS nails until fastened through panels and into studs during panel or plank fastening per siding manufacturer's instructions.

Incorrect Installation

Do not install Horizontal trims in a manner where the exterior flange can catch water. Never install vertical or corner trim profiles horizontally.

Notes

Please follow siding manufacturer's best practice guides when installing. XtremeTrim® profiles DO NOT form a moisture management system. The architect and builder are responsible for designing and installing a code compliant building envelope. Before installing XtremeTrim® best practices is to use either a drainable wrap or rainscreen assembly, to meet code or possible requirements of siding manufacturer.

Limited Warranty

Tamlyn warrants defective-free products for a period of 10 years for the original purchaser unless otherwise stated for the specific product ordered. Tamlyn products are further warranted as to adequacy of design, provided products are properly specified and installed. This warranty does not apply in the event products are altered in any way or are improperly installed. Liability is limited to replacement of products proven to be defective. Tamlyn has made no other warranty, express or implied, regarding its products, including but not limited to, any warranty regarding merchantability or fitness for a specific purpose. Any claim that a product is defective must be brought within one (1) month of the date of installation of such products by the original purchaser. Customer hereby agrees that no other incidental or consequential damages are the responsibility of Tamlyn.

The following voids any warranty regarding Tamlyn products:

- Product has been improperly installed
- Accepted siding installation methods have not been followed
- Building codes have not been followed
- The building envelope has not been properly installed
- Products not installed by a contractor/installer with common knowledge of the building industry

Responsibility remains with the architect or engineer, contractor and owner for the design, application and proper installation of each Tamlyn product. Specifier and user shall determine the suitability of products for specific application and assume all responsibilities in connection there within.

Aluminum does not rust, however it does corrode. XtremeTrim® has a protective coating to cover the bare aluminum. When making cuts on XtremeTrim® recoating will be required at ends, surface scratches or when performing form cuts. Failure to do this voids your warranty. For answers to your technical questions on recoating consult your local paint manufacturer before installation.

Please follow siding manufacturers best practice application when installing any Tamlyn accessory. XtremeTrim® profiles do not form a moisture management system, the architect and builder are responsible for designing and installing a code compliant building envelope. XtremeTrim® products are not part of an Exterior Insulation Finishing System (EIFS) and are not designed or intended to be used in an EIFS or similar system.

INTRODUCTION

REVEAL SYSTEM..... 8
 2-PIECE SYSTEM..... 9
 BEAD SYSTEM..... 10
 FLAT SYSTEM..... 11
 LAP SIDING SYSTEM..... 12
 XTREMETRIM® BASIC INSTALLATION..... 13-14
 SHAPE FINDER..... 15-17

2 PIECE PROFILES

RVC Vertical Reveal 24
RVC Transition Vertical Reveal 25
SHC Vertical Siding H Mold 26
COCR Reveal Open Outside Corner 27
COCLP Low Profile Outside Corner 28
CICLP Low Profile Inside Corner 29
JMC Panel J Mold 30
JMC Plank J Mold 31

VERTICAL PROFILES

RV Vertical Reveal 34
RVT Vertical Reveal Transition 35
SHM Vertical Siding H Mold 36
SHM Vertical Siding H Mold Transition 37
BRV Vertical Bead Reveal 38
VR V Groove Reveal 39
TM Vertical T Mold 40
PV Projected Vertical 41

HORIZONTAL PROFILES

XZH Standard Horizontal Z 44
RH Horizontal Reveal 45
BRH Horizontal Bead Reveal 46
XZS Basic Horizontal Z 47

OUTSIDE CORNERS

XOCR Reveal Open Outside Corner 50
XOCR Reveal Open Outside Corner Transition ... 51
XOCR-135 135° Reveal Open Outside Corner 52
XOCRM Reveal Outside Corner Minimum Face 53
XOCRMA Multi-Angle Outside Corner 54
XOCLP Low Profile Outside Corner 55
XOCLP Low Profile Outside Corner Transition 56
XOCLP-135 135° Low Profile Outside Corner 57
XOCW Reveal W Outside Corner 58
XOCBT Butted Outside Corner 59
XOCX Bold X 60
XOCB Bullnose Outside Corner 61
XOCAS Panel Asymmetrical Square 62
XOCAT Panel Asymmetrical Tapered 63
XOCBL Blunt Panel Outside Corner 64
XOCRB Blunt Reveal Outside Corner 65
XOCDR Double Reveal Outside Corner 66
XOCSR Square Reveal Outside Corner 67
XOCBN Batten Panel Outside Corner 68
XOC 3-1/2" Outside Corner..... 69

INSIDE CORNERS

XIC W Inside Corner 73
XIC W Inside Corner Transition 74
XICLP Low Profile Inside Corner 75
XICLP Low Profile Inside Corner Transition 76
XICLP-135 135° Low Profile Inside Corner..... 77
XICR Reveal Inside Corner 78
XICRMA Multi-Angle Inside Corner 79
XICB Bullnose Inside Corner 80
XICBL Panel Blunt Inside Corner 81
XICBP Projected Bullnose Inside Corner 82

TERMINATION PROFILES

JMH Standard J Mold 86
JMR Reveal J Mold 87
JMS Basic J Mold 88
FR F Reveal 89
F F Trim 90
XL L Transition Trim 91

SPECIALTY PROFILES

XHM Soffit H Mold 94
XS Starter Strip 95
XWF Window/Head Flashing 96

SPECIAL ORDER ITEMS

..... 97

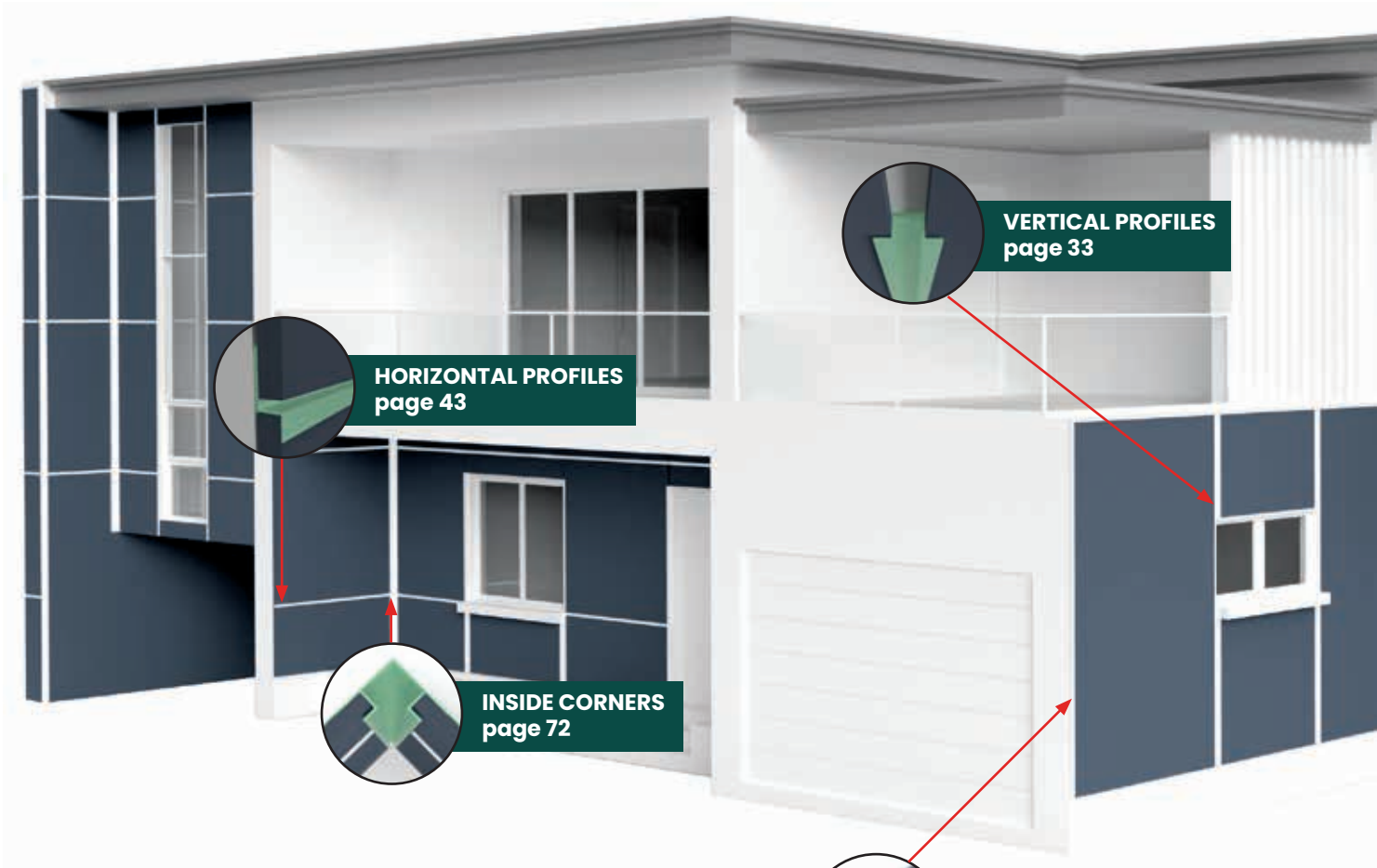

HORIZONTAL PROFILES
page 43

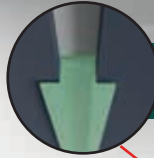

VERTICAL PROFILES
page 33



INSIDE CORNERS
page 72

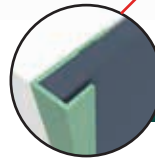

TERMINATION PROFILES
page 85

TAMLYN®

FAMILY. VALUE. SERVICE.

Tamlyn® continues to lead the way in selection and choice for extruded aluminum trims to complement siding materials of all types.

Tamlyn® has made it possible to aesthetically trim almost any type of siding product with our wide range of depth options. And we have provided these in choices of primed, clear anodized, specialty anodized, or color matched to satisfy whatever the project requires.

XtremeTrim® has thousands of design and color options, allowing architects and users to dramatically improve their building aesthetics and create modern architectural lines. Sustainable, durable, non-combustible, lightweight, easy to use. Tamlyn® has our own team of in-house architects to aid and assist the process of selecting and assuring the correct profile for the specific application or desired aesthetic effect.

But Tamlyn® does not stop there in the selection and leadership process. Tamlyn® has the ability and materials in-house to provide appropriate non-extruded fabrication from sheet stock of almost any shape profile, or color that may be needed on the project.

Ever run short a few pieces on a big job to finish, get paid and avoid huge delay or project fines? Contact TAMLYN® and put our XtremeService to the test.

When Doing It Right Matters®

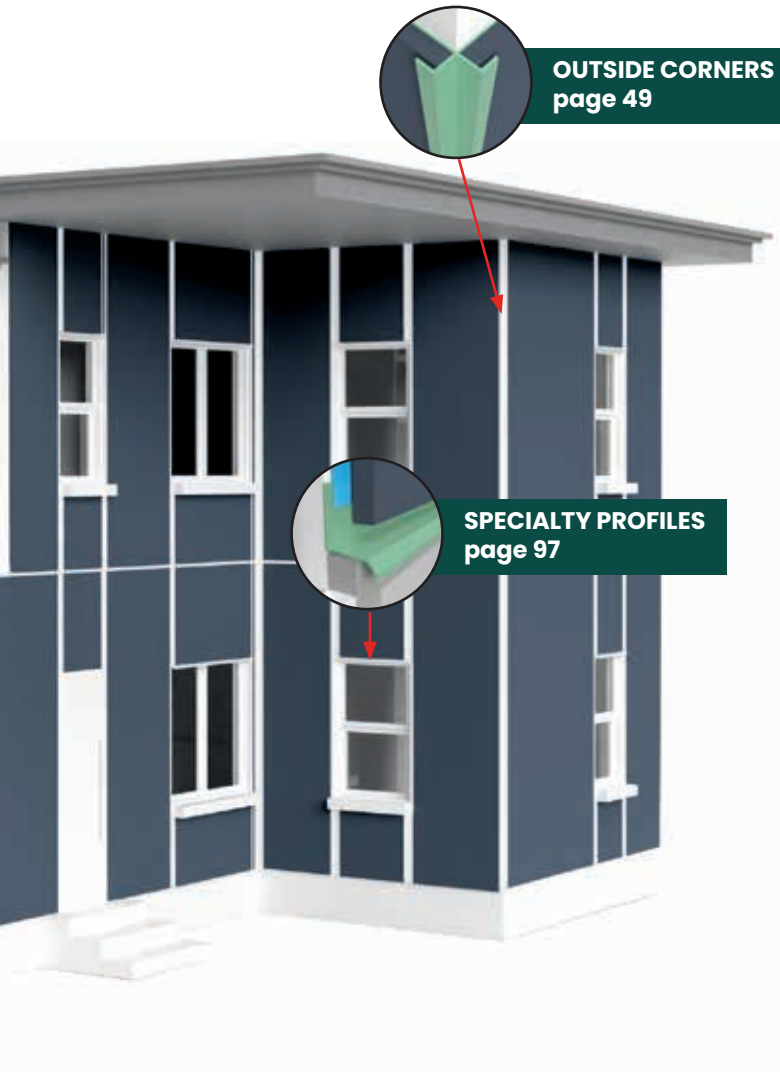

OUTSIDE CORNERS
page 49

SPECIALTY PROFILES
page 97

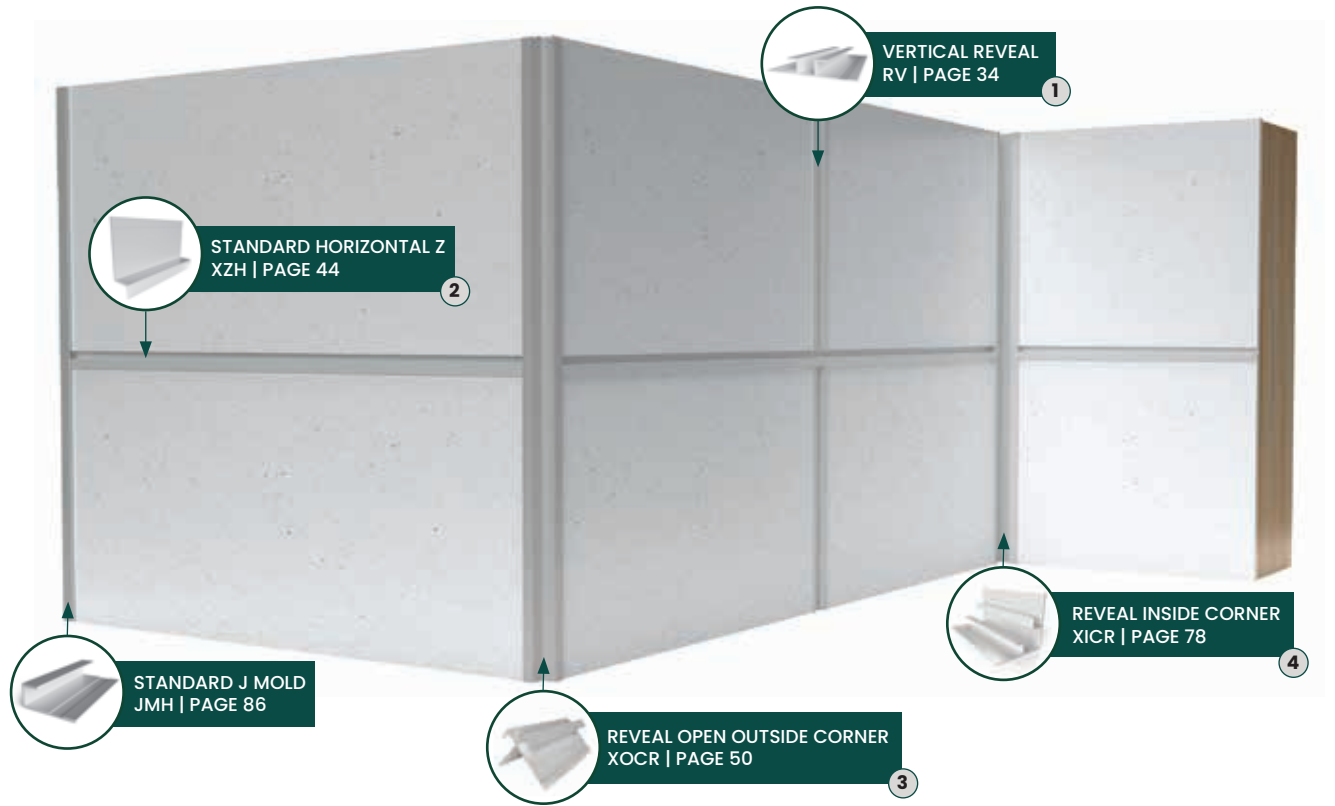

STANDARD



HORIZONTAL REVEAL

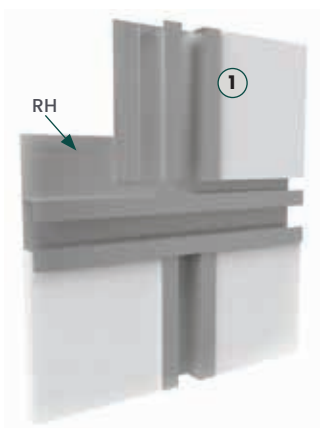

LOW PROFILE

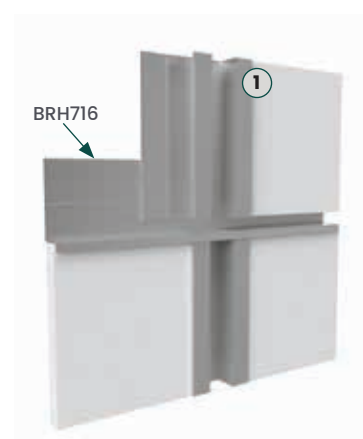

VERTICAL CONTINUOUS

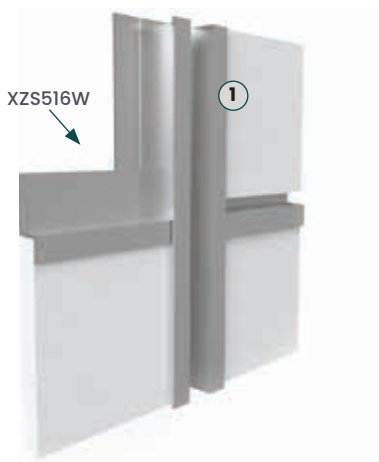

OUTSIDE CORNER OPTION WITH XZH

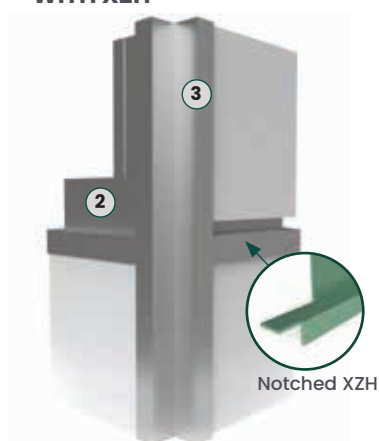

OPTIONAL INSIDE CORNER XICLP516



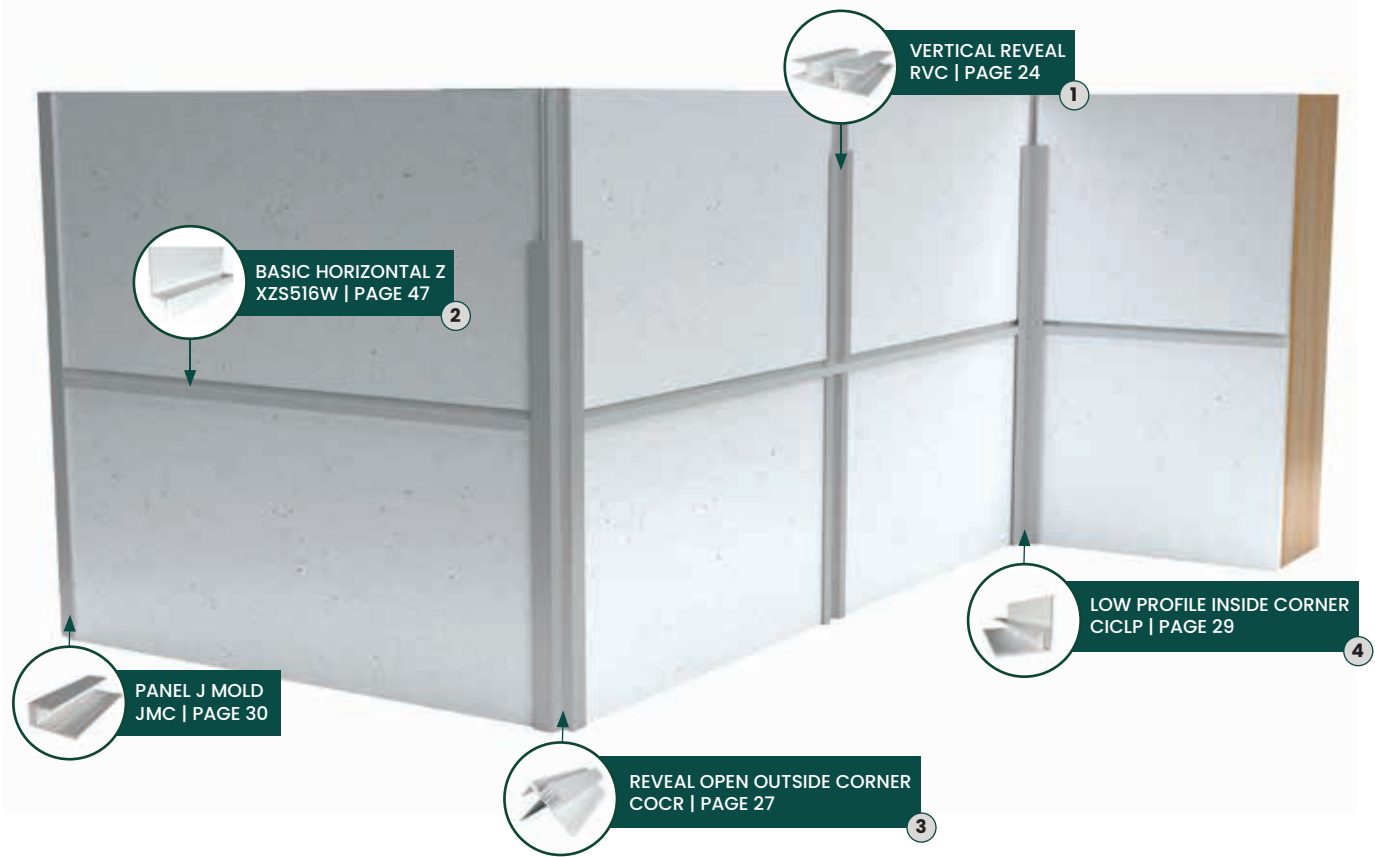

STANDARD

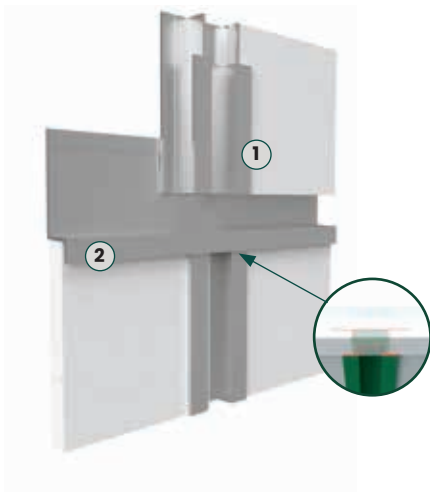

INSIDE CORNER



OUTSIDE CORNER



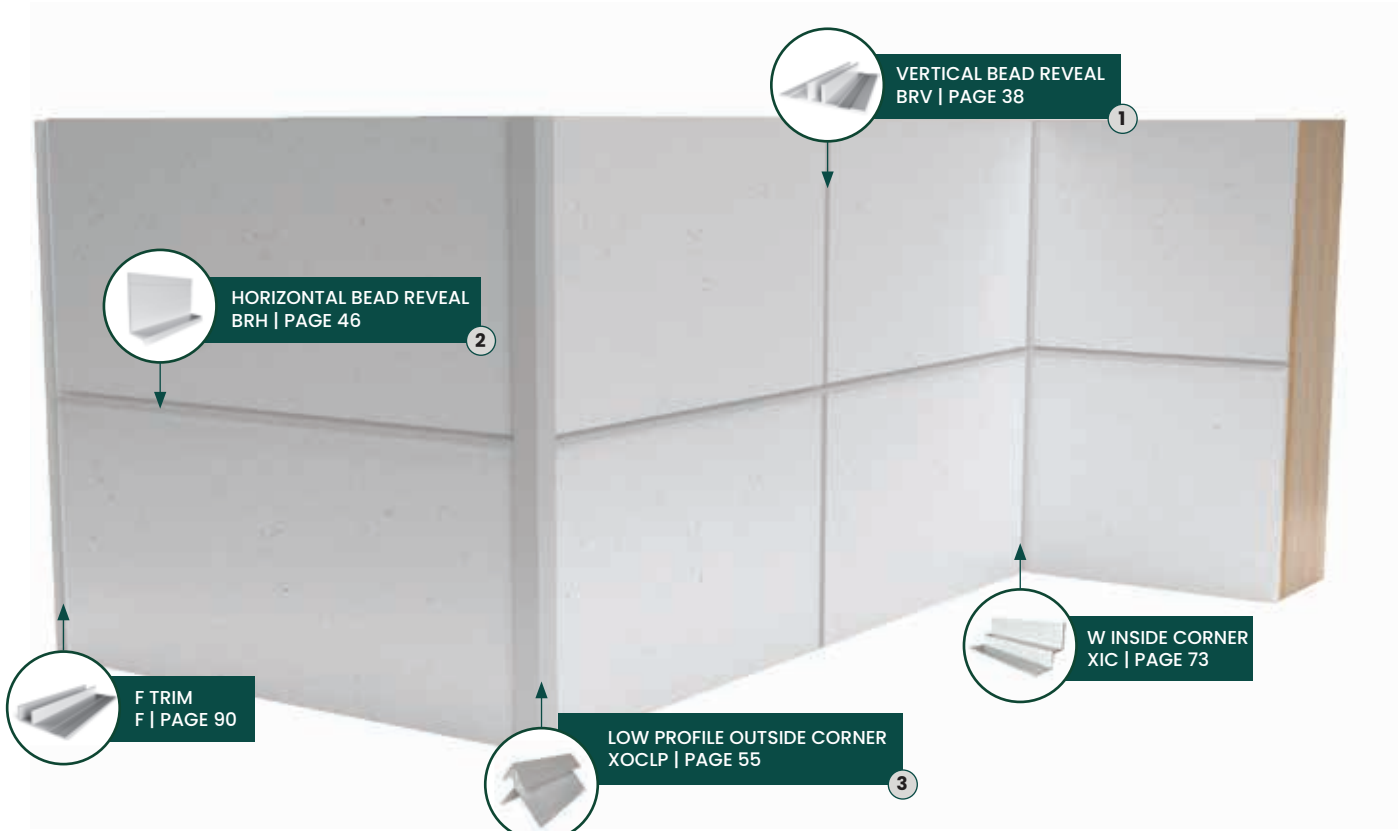

STANDARD 1/4" 1/2" AND 1" BEAD



BRV1516



MITERED CORNER

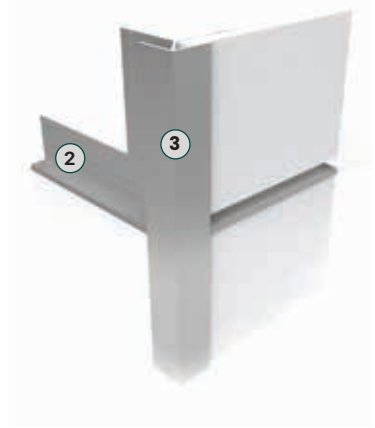

BATTEN CORNER FOR 1/2" BEAD

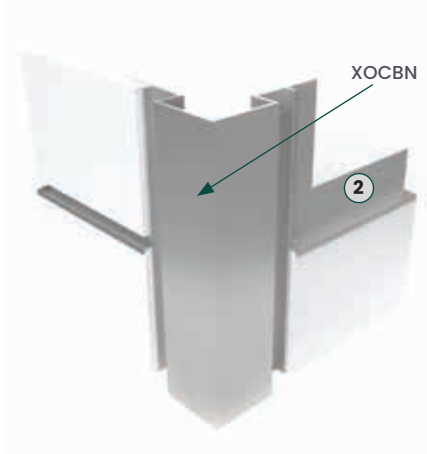

XOCRM



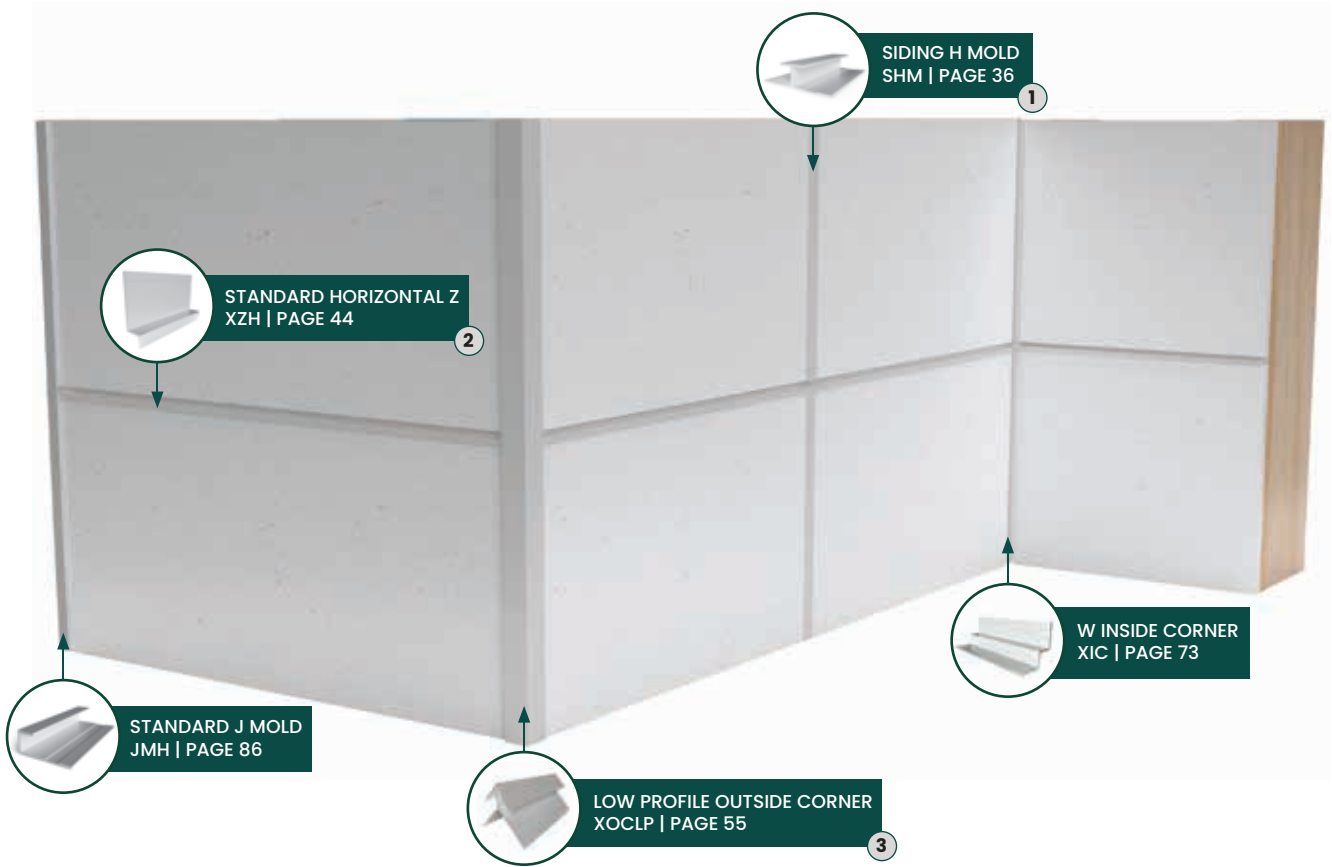

H MOLD

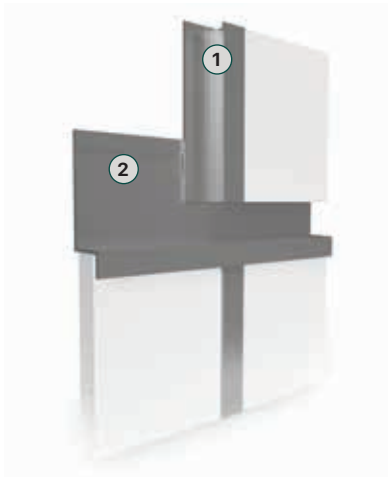

T MOLD

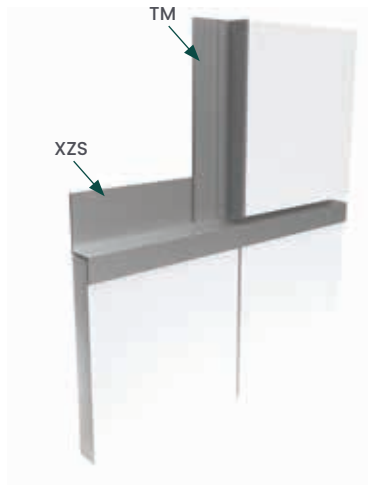

OUTSIDE CORNER

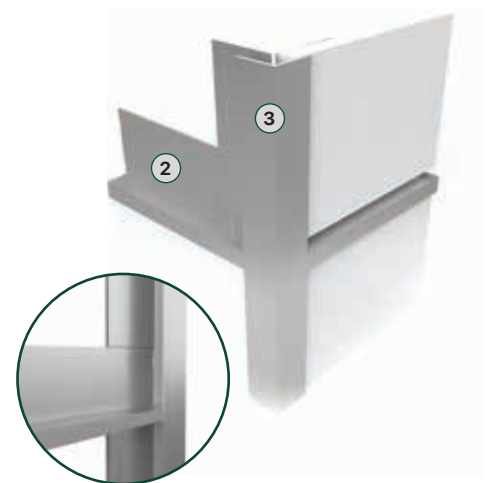



OUTSIDE CORNER

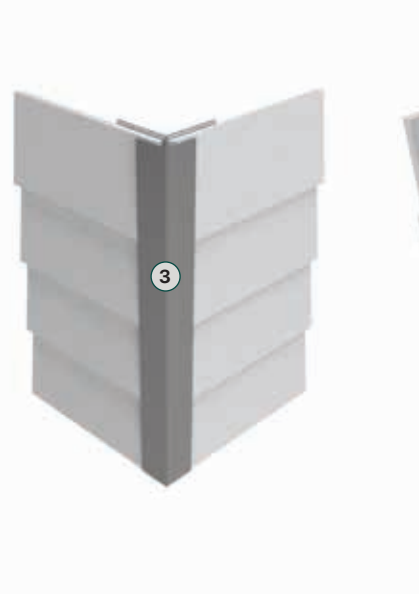

INSIDE CORNER



STARTER STRIP AT OUTSIDE CORNER



TOOLS



CHOP/MITER SAW
with an all-purpose blade
designed to cut non-
ferrous metals



METAL SNIPS
straight cut



NAIL GUN
fasteners must be
corrosion resistant
galvanized



DRILL
with stainless steel
fasteners



LEVEL
helps ensure that lines
are entirely straight.

- Review and follow **local building code**
- Refer to panel/siding manufacturer install instructions for **fastening, substrate requirements and clearances**
- Store in a **dry area** protected from weather
- Refer to **Construction Documents** for profile layout

STARTING POINT.

- Install Inside Corner.
- Install first panel into corner - leveling and adjusting as needed



INSTALL SUBSEQUENT PANELS AND VERTICAL TRIMS ALONG A HORIZONTAL PATTERN.

- Note: Trims are not structural



INSTALL PANELS AND VERTICAL TRIMS TO NEXT CORNER, THEN INSTALL HORIZONTAL TRIM AND MOVE UPWARDS.

- Fasten one side





AT INTERSECTION OF HORIZONTAL TO INSIDE AND OUTSIDE CORNER, FOR BETTER FINISH AESTHETICS, NOTCHING TECHNIQUES MAY BE USED.

- Outside corner with notched XZH (Horizontal Z)
- Outside corner notched with RH (Horizontal Reveal)

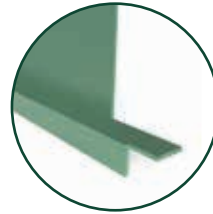

Outside corner with notched XZH

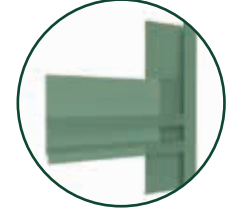

Outside corner notched with RH



WHEN INSTALLING WITH HORIZONTAL Z MOST DESIGNS CALL FOR 1/2" CORRESPONDING REVEAL; WHICH IS ACHIEVED BY HOLDING NEXT COURSE OF PANELS AND VERTICAL TRIM UP OFF THE HORIZONTAL.

- A small cut off of the vertical reveal can be used as a spacer

FINISHED PRODUCT



2-PIECE PROFILES

Vertical Reveal (2-Piece) RVC	p. 24	Transition Vertical Reveal (2-Piece) RVC	p. 25	Vertical Siding H Mold (2-Piece) SHC	p. 26	Reveal Open Outside Corner (2-Piece) COCR	p. 27	Low Profile Outside Corner (2-Piece) COCLP	p. 28
----------------------------------	-------	---	-------	---	-------	--	-------	---	-------



Low Profile Inside Corner (2-Piece) CICLP	p. 29	Panel J Mold (2-Piece) JMC	p. 30	Plank J Mold (2-Piece) JMC	p. 31
--	-------	-------------------------------	-------	-------------------------------	-------



VERTICAL PROFILES

Vertical Reveal RV	p. 34	Vertical Reveal Transition RVT	p. 35	Vertical Siding H Mold SHM	p. 36	Vertical Siding H Mold Transition SHM	p. 37	Vertical Bead Reveal BRV	p. 38
-----------------------	-------	-----------------------------------	-------	-------------------------------	-------	--	-------	-----------------------------	-------



V Groove Reveal VR	p. 39	Vertical T Mold TM	p. 40	Projected Vertical Reveal PV	p. 41
-----------------------	-------	-----------------------	-------	---------------------------------	-------



HORIZONTAL PROFILES

Standard Horizontal Z XZH	p. 44	Horizontal Reveal RH	p. 45	Horizontal Bead Reveal BRH	p. 46	Basic Horizontal Z XZS	p. 47
------------------------------	-------	-------------------------	-------	-------------------------------	-------	---------------------------	-------

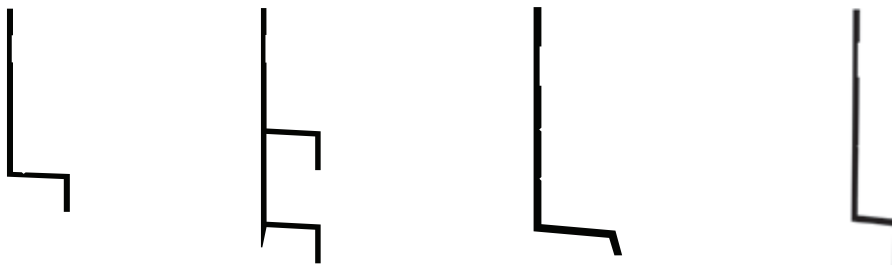

OUTSIDE CORNERS

Reveal Open Outside Corner p. 50 XOCR	Reveal Open Outside Corner Transition p. 51 XOCR	135° Reveal Open Outside Corner p. 52 XOCR-135	Reveal Outside Corner Minimum Face p. 53 XOCRM	Multi-Angle Outside Corner p. 54 XOCRMA
---	--	--	--	---

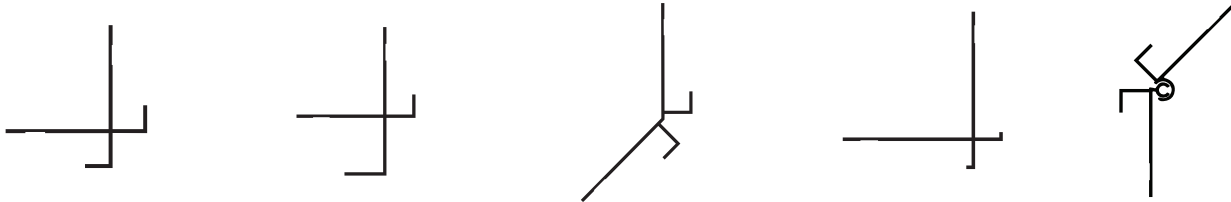

Low Profile Outside Corner p. 55 XOCLP	Low Profile Outside Corner Transition p. 56 XOCLP	135° Low Profile Outside Corner p. 57 XOCLP-135	Reveal W Outside Corner p. 58 XOCW	Butted Outside Corner p. 59 XOCBT
--	---	---	--	---

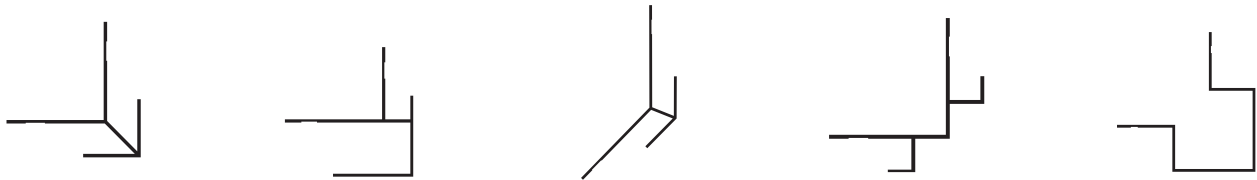

Bold X Outside Corner p. 60 XOCX	Bullnose Outside Corner p. 61 XOCB	Panel Asymmetrical Square p. 62 XOCAS	Panel Asymmetrical Tapered p. 63 XOCAT	Blunt Panel Outside Corner p. 64 XOCBL
--	--	---	--	--

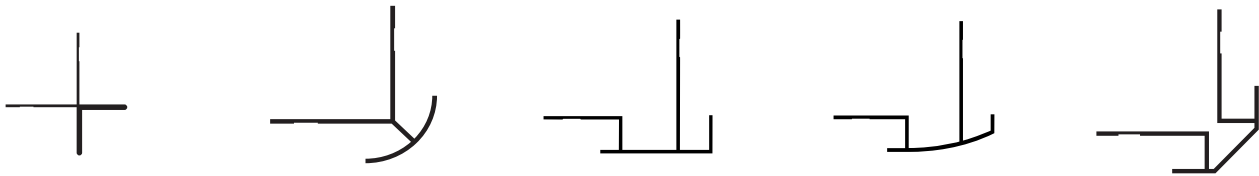

Blunt Panel Reveal Outside Corner p. 65 XOCRB	Double Reveal Outside Corner p. 66 XOCDR	Square Reveal Outside Corner p. 67 XOCSSR	Batten Panel Outside Corner p. 68 XOCBN	3-1/2" Outside Corner p. 69 XOC
---	--	---	---	---------------------------------------

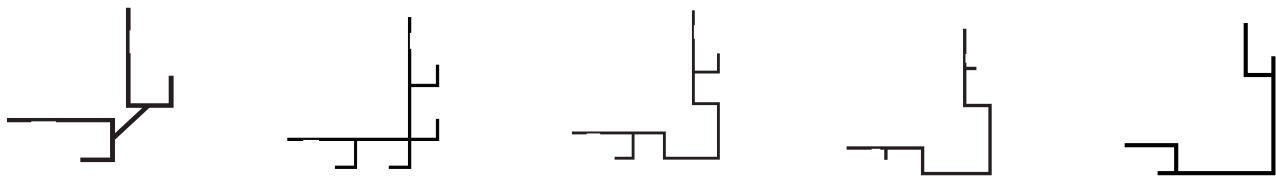

INSIDE CORNERS

W Inside Corner p. 73 XIC	W Inside Corner Transition p. 74 XIC	Low Profile Inside Corner p. 75 XICLP	Low Profile Inside Corner Transition p. 76 XICLP	135° Low Profile Inside Corner p. 77 XICLP-135
---------------------------------	--	---	--	--

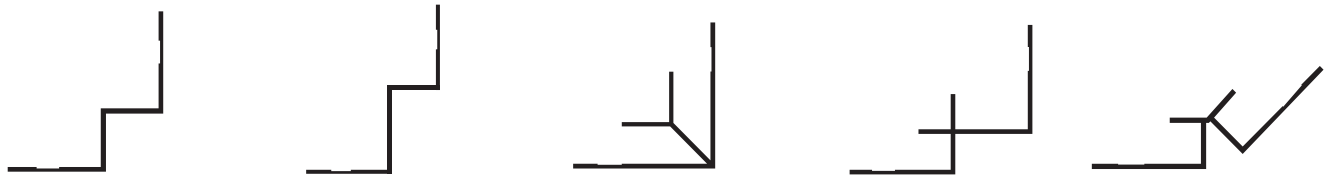

Reveal Inside Corner p. 78 XICR	Multi-Angle Inside Corner p. 79 XICRMA	Bullnose Inside Corner p. 80 XICB	Panel Blunt Inside Corner p. 81 XICBL	Projected Bullnose Inside Corner p. 82 XICBP
---------------------------------------	--	---	---	--

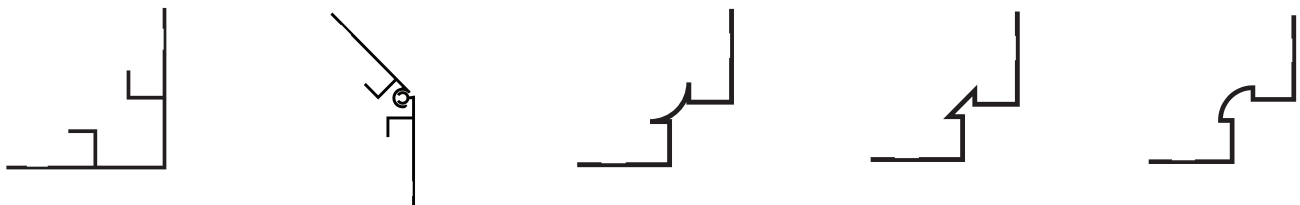

TERMINATION PROFILES

Standard J Mold	p. 86 JMH	Reveal J Mold	p. 87 JMR	Basic J Mold	p. 88 JMS	F Reveal	p. 89 FR	F Trim	p. 90
-----------------	--------------	---------------	--------------	--------------	--------------	----------	-------------	--------	-------



L Trim	p. 90 XL
--------	-------------



SPECIALTY PROFILES

Soffit H Mold	p. 94 XHM	Starter Strip	p. 95 XS	Window/Head Flashing	p. 96 XWF
---------------	--------------	---------------	-------------	----------------------	--------------

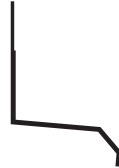





CRESCENT

20

NOW OPEN
APARTMENT RESIDENCES

NOW OPEN
APARTMENT RESIDENCES

PRIMED FINISH STANDARD

XtremeTrim® extruded profiles are provided standard with a primed finish using a proprietary primer suitable for field painting using most paint materials. Ideal application is with a direct-to-metal alkyd enamel. Consult your local paint manufacturers for best practice and proper paint selection and application.

ANODIZED FINISHES

Tamlyn stocks Clear Anodized (Architectural 202R1) in almost all extruded profiles. In addition, other anodized finishes such as Dark Bronze, Medium Bronze, Light Bronze, or Black are available as special order. All anodized finishes are provided within an industry range of color consistency and can vary slightly from item to item.

Special order anodized colors are subject to specific minimum set up fees and cost depending upon quantity. Anodizing is an electrochemical conversion process that deposits an oxide film on the aluminum profile. A natural oxidation process occurs on all bare aluminum, however, producing the oxidation process artificially through anodizing creates a thicker, harder, and more durable oxide film which is an extremely durable finish resistant to most forms of airborne corrosion.

ANODIZED SPECIFICATIONS

Standard Clear Anodized – Architectural 202R1 medium etch (AA-M32CA21). Thickness of anodic coating shall be tested in accordance with ASTM B-244-68.

Color Anodized Finish – two step impregnated color Class II Architectural of 0.40-0.70 mils (AAM12C22A33) Thickness of anodic coating shall be tested in accordance with ASTM B-244-68.

Tamlyn also provides Clear Anodized fabricated profiles in 0.040 sheet stock to compliment the extruded Clear Anodized profiles.

POWDER COATING

Powder coating is an advanced method of applying finish to products. The powder used for the process is a mixture of finely ground particles of pigment and resin, which is sprayed onto a surface to be coated. The charged powder particles adhere to the electrically grounded surfaces until heated and fused into a smooth coating in a curing oven. The result is a uniform, durable, high-quality, and attractive finish.

Powder coating gives the longest-lasting and most color-durable quality finishes available. Powder coated surfaces are more resistant to chipping, scratching, fading, and wearing than other finishes.

Tamlyn powder coats in-house to match all major pre-finished siding colors. Quantity limits apply for custom color powder coat processing.

TRADITIONAL WET PAINT PROCESSING

Tamlyn also can provide traditional wet paint process for custom colors. This is advantageous often for smaller volume orders. The color control and matching can be precisely managed to assure consistency throughout a job or project. Minimum quantity limits apply for all color matches.

Colors shown are illustrated as accurately as printing methods will permit. Please utilize actual product samples for true color comparison.

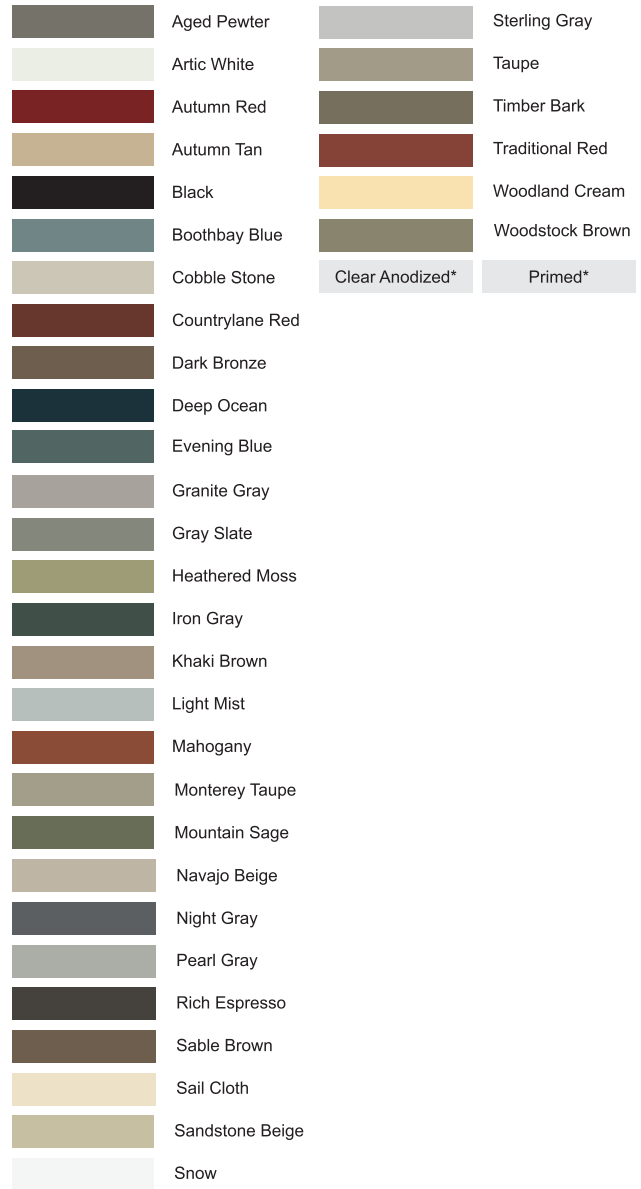

Any other color you imagine is also available from TAMLYN. Want to match a school or corporate color scheme, we can make it happen!

With all color processes there is an allowable variance tolerance that applies to painting and use of dissimilar substrate materials to which paint is applied. Pre-matched colors on many siding products are considered to be stock matched from TAMLYN and do not require signed match approval for processing. Any other colors must have signed/accepted hand matches completed prior to order processing/acceptance. The colors above are examples of the majority of current ready matched shades. Almost any other color can be matched. There are quantity minimums for all orders of color processing. Paint variances from lot to lot WILL occur and on large projects it is recommended that all color items be ordered at one time.



A NEW ERA IN APARTMENT LIVING
FUTUREWORKS PARKING

FUTUREWORKS PARKING

STEELWORKS PARKING → STEELWORKS PARKING →

STEELWORKS PARKING



2 PIECE SYSTEM

RVC

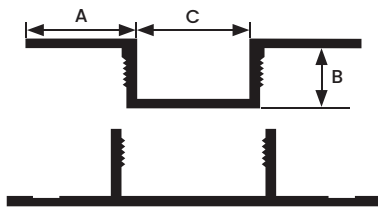
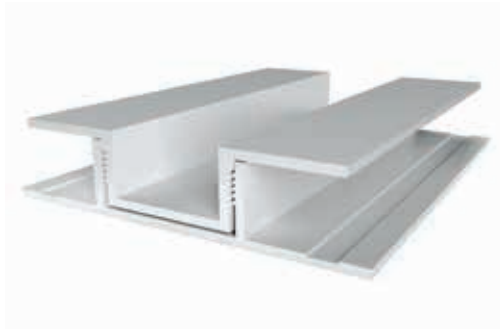

All measurements are nominal

ITEM ID	A	B	C
RVC516	1/2"	5/16"	1/2"
RVC34	5/8"	3/4"	3/4"

All parts are 10' Length unless otherwise indicated

DESIGN FEATURES

Designed to create a uniform, aesthetically consistent vertical reveal between siding. The 2-Piece design permits application of the base part first and then installation of the cover cap at a later time. In tight fit situations this may be more convenient than using the standard vertical reveal. However, due to the natural expansion and contraction of aluminum, all 2-Piece RVC caps must be secured by either adhesive or screw or pop rivet.

Recommended adhesive needs to meet these requirements:

Tensile Strength: ASTM D412 - 475 psi

Lap Shear Strength: ASTM D1002 - 550 psi

MATERIAL

6063-T5 .045" ± .005 extruded aluminum alloy with proprietary coating that protects against harsh weather conditions and allows for paint adhesion. For all other finish options refer to page 20.

NOTES

Do not install XtremeTrim® Vertical Reveal on horizontal applications where the exterior flange can catch/hold water.

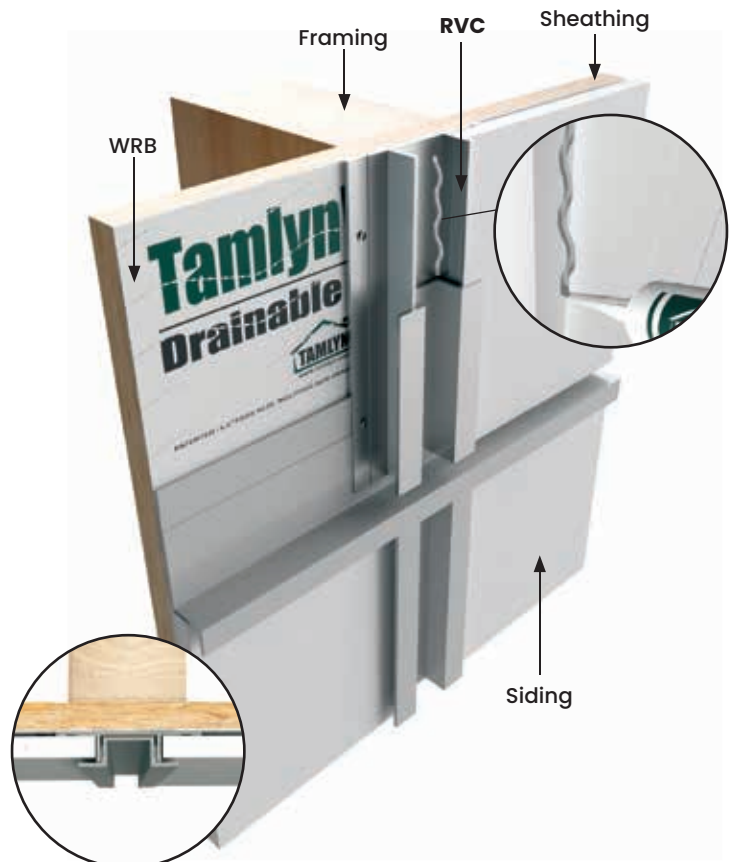

DESIGN FEATURES

Designed to create a uniform, aesthetically consistent vertical reveal at transitions between panel and lap siding. The 2-Piece design permits application of the base part first and then installation of the cover cap at a later time. In tight fit situations this may be more convenient than using the standard vertical reveal. However, due to the natural expansion and contraction of aluminum, all 2-Piece RVC caps must be secured by either adhesive or screw or pop rivet.

Recommended adhesive needs to meet these requirements:

Tensile Strength: ASTM D412 - 475 psi

Lap Shear Strength: ASTM D1002 - 550 psi

MATERIAL

6063-T5 .045" ± .005 extruded aluminum alloy with proprietary coating that protects against harsh weather conditions and allows for paint adhesion. For all other finish options refer to page 20.

NOTES

Do not install XtremeTrim® Transition Vertical Reveal on horizontal applications where the exterior flange can catch/hold water.

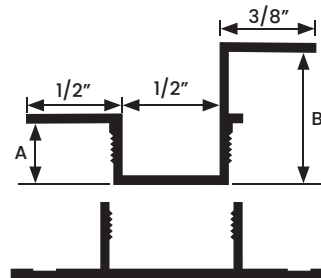

All measurements are nominal

ITEM ID	A	B
RVC51634	5/16"	3/4"

All parts are 10' Length unless otherwise indicated

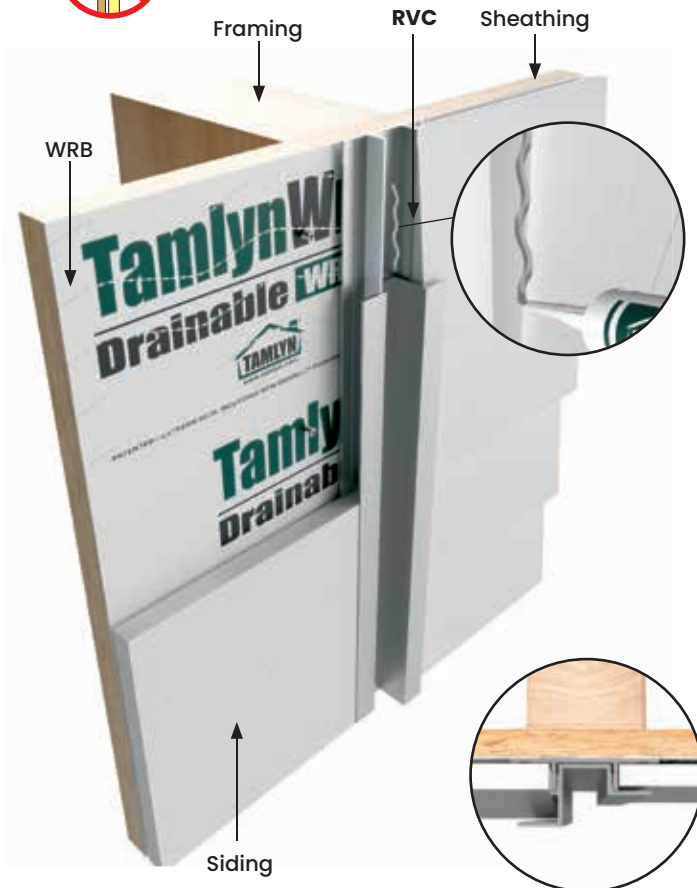

SHC

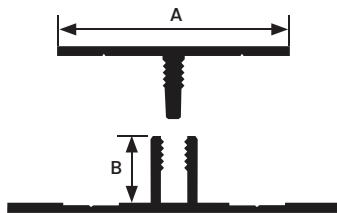
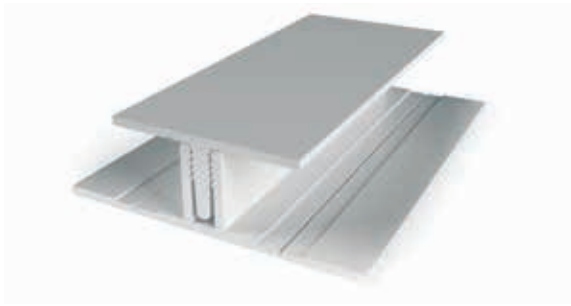

All measurements are nominal

ITEM ID	A	B
SHC516	1"	5/16"

All parts are 10' Length unless otherwise indicated

DESIGN FEATURES

Designed to cover vertical joints in siding. Provides a smooth seam. The 2-Piece design permits application of the base part first and then installation of the cover cap at a later time. In tight fit situations this may be more convenient than using the standard vertical reveal. However, due to the natural expansion and contraction of aluminum, all 2-Piece SHC caps must be secured by adhesive.

Recommended adhesive needs to meet these requirements:

Tensile Strength: ASTM D412 - 475 psi

Lap Shear Strength: ASTM D1002 - 550 psi

MATERIAL

6063-T5 .045" ± .005 extruded aluminum alloy with proprietary coating that protects against harsh weather conditions and allows for paint adhesion. For all other finish options refer to page 20.

NOTES

Do not install XtremeTrim® Siding H Mold on horizontal applications where the exterior flange can catch/hold water.

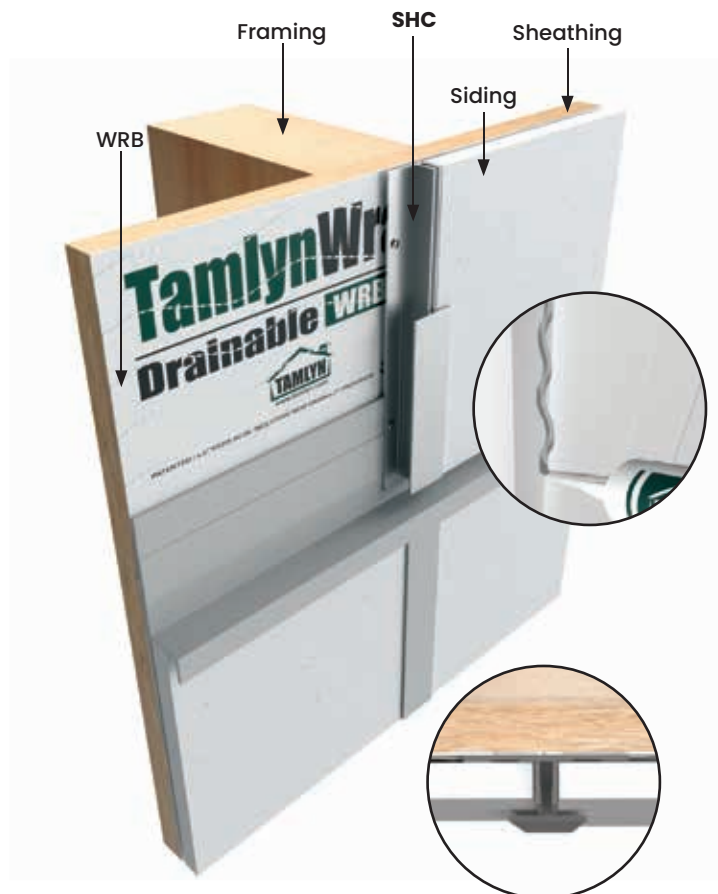

COCR

DESIGN FEATURES

Provides a clean open outside corner which complement the Vertical Reveal System. The 2 Piece design permits application of the base part first and then installation of the cover cap at a later time. In tight fit situations this may be more convenient than using the standard outside corner. However, due to the natural expansion and contraction of aluminum, all 2-Piece COCR caps must be secured by either adhesive or pop rivet.

Recommended adhesive needs to meet these requirements:

Tensile Strength: ASTM D412 - 475 psi

Lap Shear Strength: ASTM D1002 - 550 psi

MATERIAL

6063-T5 .045" ± .005 extruded aluminum alloy with proprietary coating that protects against harsh weather conditions and allows for paint adhesion. For all other finish options refer to page 20.

NOTE

Do not install XtremeTrim® Reveal Open Outside Corner on horizontal applications where the exterior flange can catch/hold water.

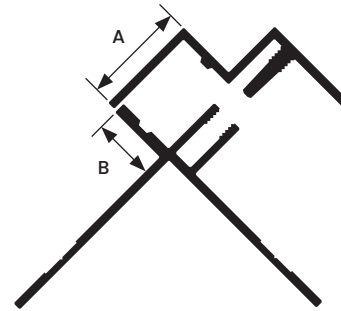

All measurements are nominal

ITEM ID	A	B
COCR516	5/8"	3/8"

All parts are 10' Length unless otherwise indicated

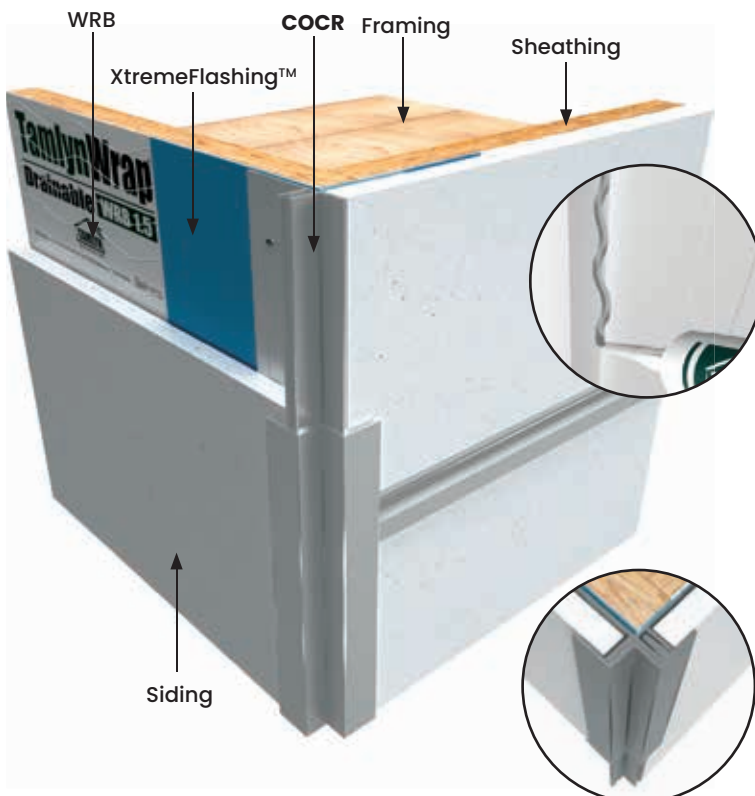

COCLP

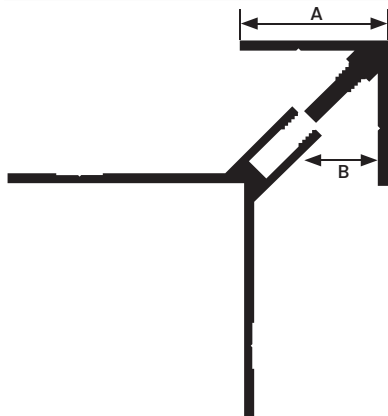

All measurements are nominal

ITEM ID	A	B
COCLP516	3/4"	3/8"

All parts are 10' Length unless otherwise indicated

DESIGN FEATURES

Clean outside corner for vertical siding panels. Works well with all vertical options. The 2-Piece design permits application of the base part first and then installation of the cover cap at a later time. In tight fit situations this may be more convenient than using the standard outside corner. However, due to the natural expansion and contraction of aluminum, all 2-Piece COCLP caps must be secured by adhesive.

Recommended adhesive needs to meet these requirements:

Tensile Strength: ASTM D412 - 475 psi

Lap Shear Strength: ASTM D1002 - 550 psi

MATERIAL

6063-T5 .045" ± .005 extruded aluminum alloy with proprietary coating that protects against harsh weather conditions and allows for paint adhesion. For all other finish options refer to page 20.

NOTE

Do not install XtremeTrim® Low Profile Outside Corner on horizontal applications where the exterior flange can catch/hold water.

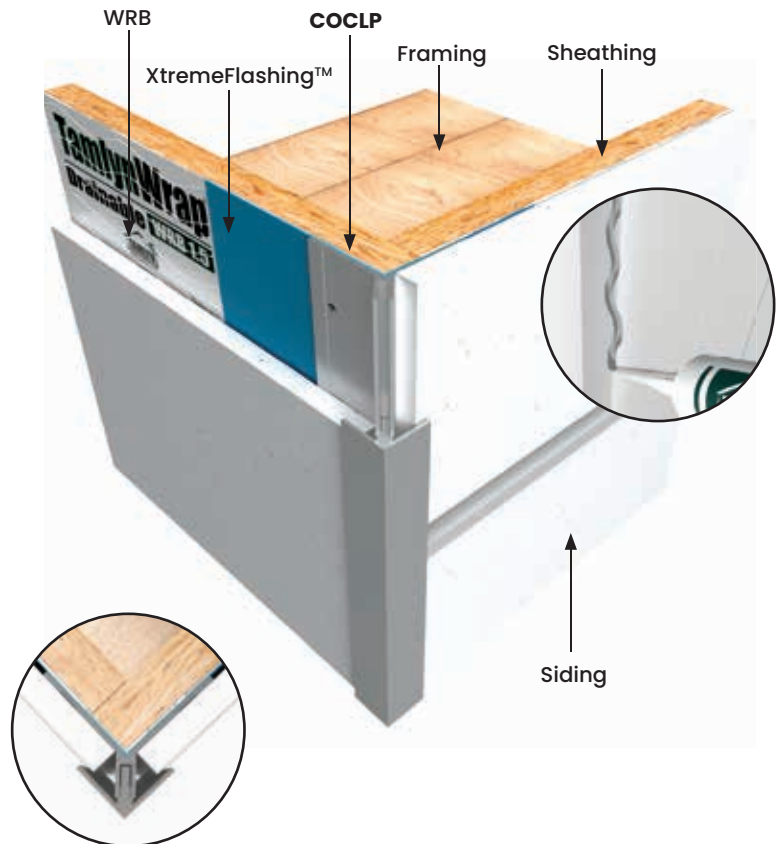

DESIGN FEATURES

Produces a clean, durable inside corner for siding panels. The 2-Piece design permits application of the base part first and then installation of the cover cap at a later time. In tight fit situations this may be more convenient than using the standard inside corner. However, due to the natural expansion and contraction of aluminum, all 2-Piece CICLP caps must be secured by adhesive.

Recommended adhesive needs to meet these requirements:

Tensile Strength: ASTM D412 - 475 psi

Lap Shear Strength: ASTM D1002 - 550 psi

MATERIAL

6063-T5 .045" ± .005 extruded aluminum alloy with proprietary coating that protects against harsh weather conditions and allows for paint adhesion.

For all other finish options refer to page 20.

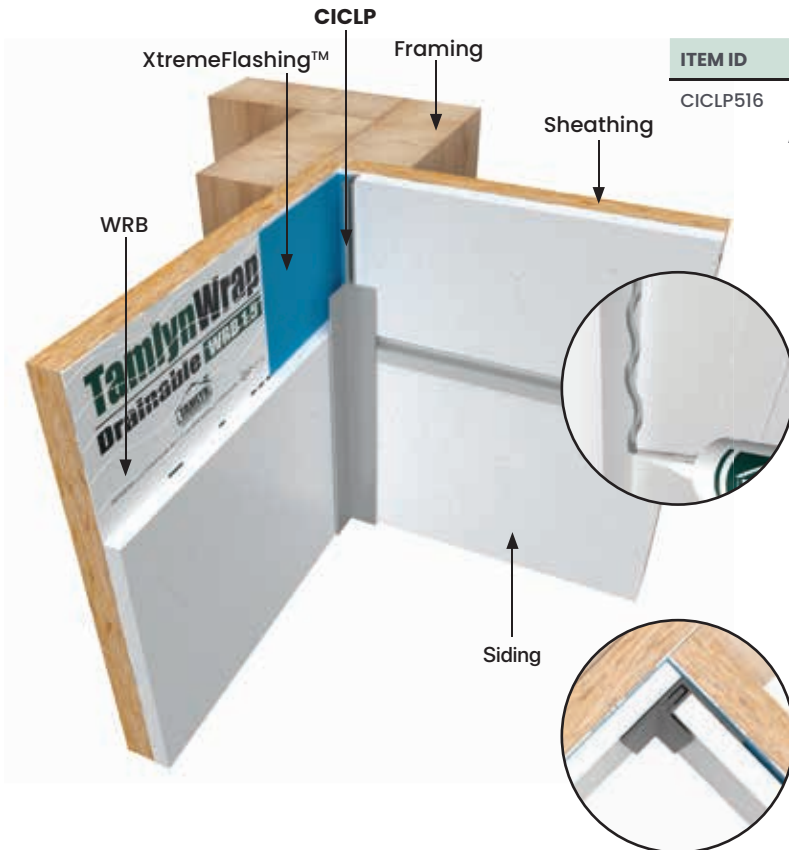
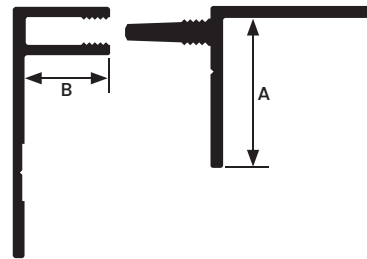

All measurements are nominal

ITEM ID	A	B
CICLP516	5/8"	3/8"

All parts are 10' Length unless otherwise indicated

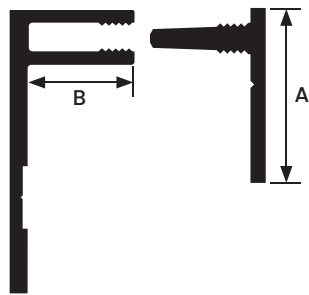
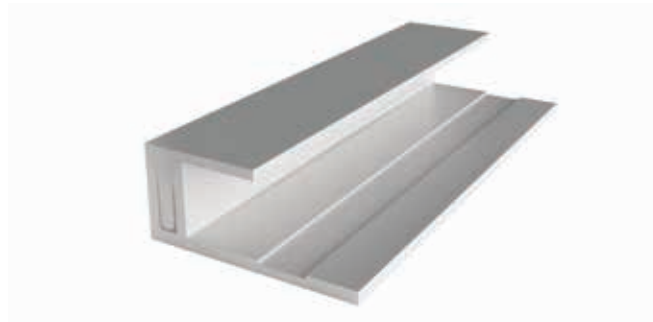

All measurements are nominal

ITEM ID	A	B
JMC516	5/8"	3/8"

All parts are 10' Length unless otherwise indicated

DESIGN FEATURES

Provides a clean finish at openings, edges of panels and at material transitions. The 2-Piece design permits application of the base part first and then installation of the cover cap at a later time. In tight fit situations this may be more convenient than using the standard termination profile. However, due to the natural expansion and contraction of aluminum, all 2-Piece JMC caps must be secured by adhesive.

Recommended adhesive needs to meet these requirements:

Tensile Strength: ASTM D412 - 475 psi

Lap Shear Strength: ASTM D1002 - 550 psi

MATERIAL

6063-T5 .045" ± .005 extruded aluminum alloy with proprietary coating that protects against harsh weather conditions and allows for paint adhesion. For all other finish options refer to page 20.

NOTE

Do not install XtremeTrim® J Mold on horizontal applications where the exterior flange can catch/hold water.

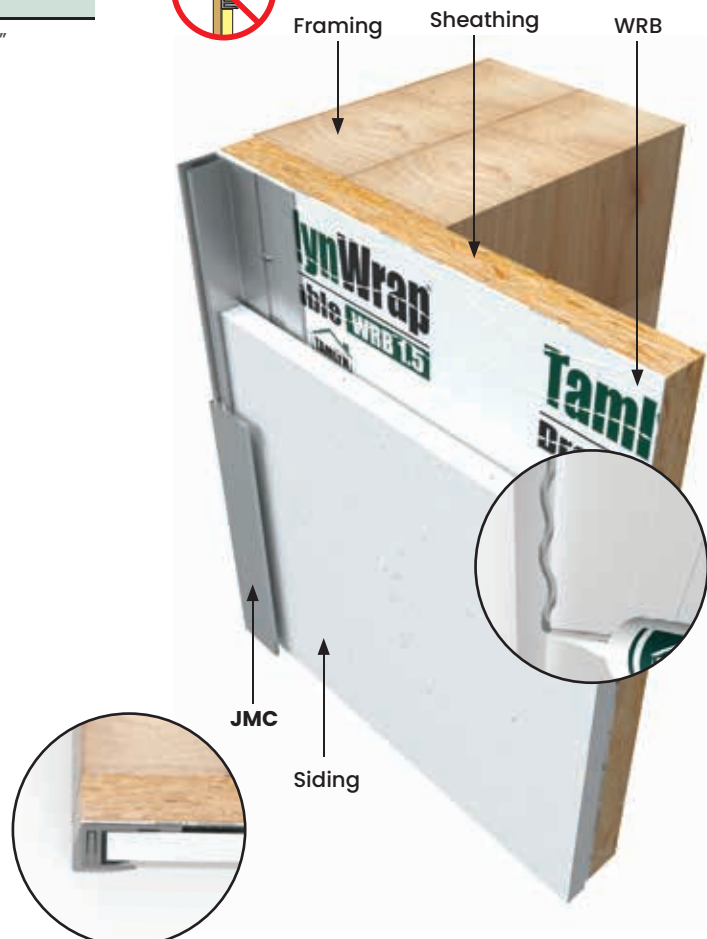

DESIGN FEATURES

Provides a clean finish at openings, edges of planks and at material transitions. The 2-Piece design permits application of the base part first and then installation of the cover cap at a later time. In tight fit situations this may be more convenient than using the standard termination profile. However, due to the natural expansion and contraction of aluminum, all 2-Piece JMC caps must be secured by adhesive.

Recommended adhesive needs to meet these requirements:

Tensile Strength: ASTM D412 - 475 psi

Lap Shear Strength: ASTM D1002 - 550 psi

MATERIAL

6063-T5 .045" ± .005 extruded aluminum alloy with proprietary coating that protects against harsh weather conditions and allows for paint adhesion. For all other finish options refer to page 20.

NOTE

Do not install XtremeTrim® J Mold on horizontal applications where the exterior flange can catch/hold water.

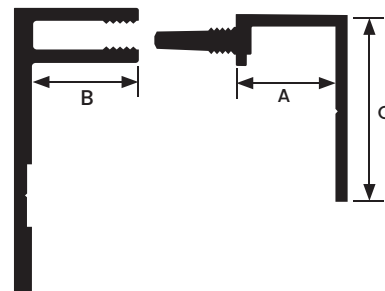

All measurements are nominal

ITEM ID	A	B	C
JMC34	3/8"	3/8"	3/4"

All parts are 10' Length unless otherwise indicated

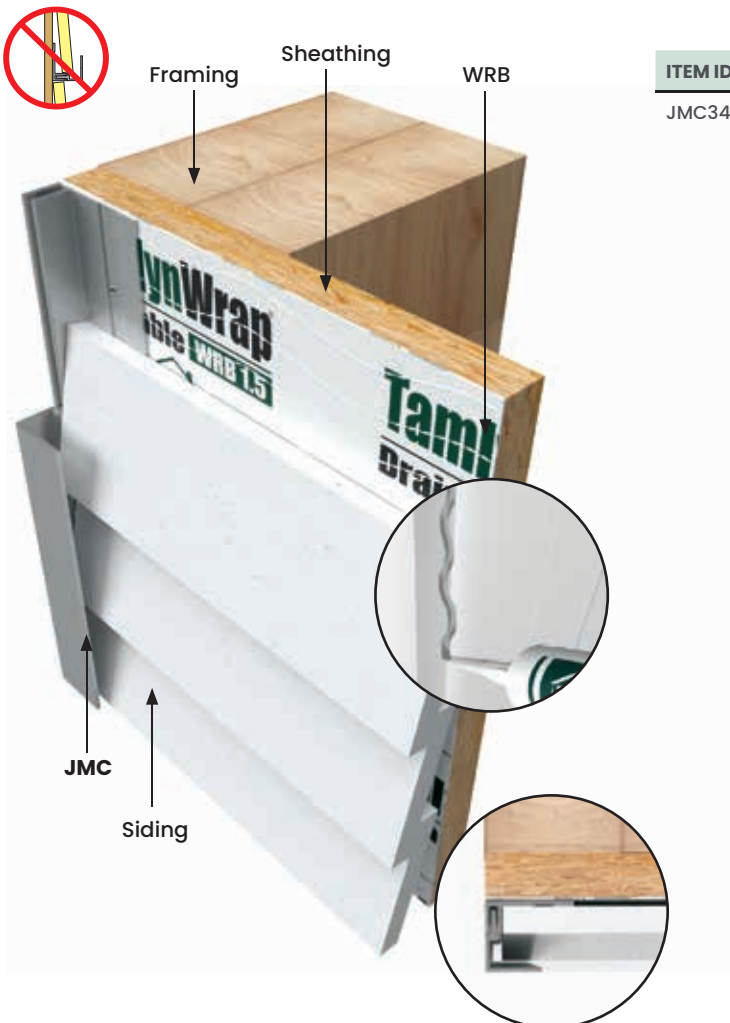

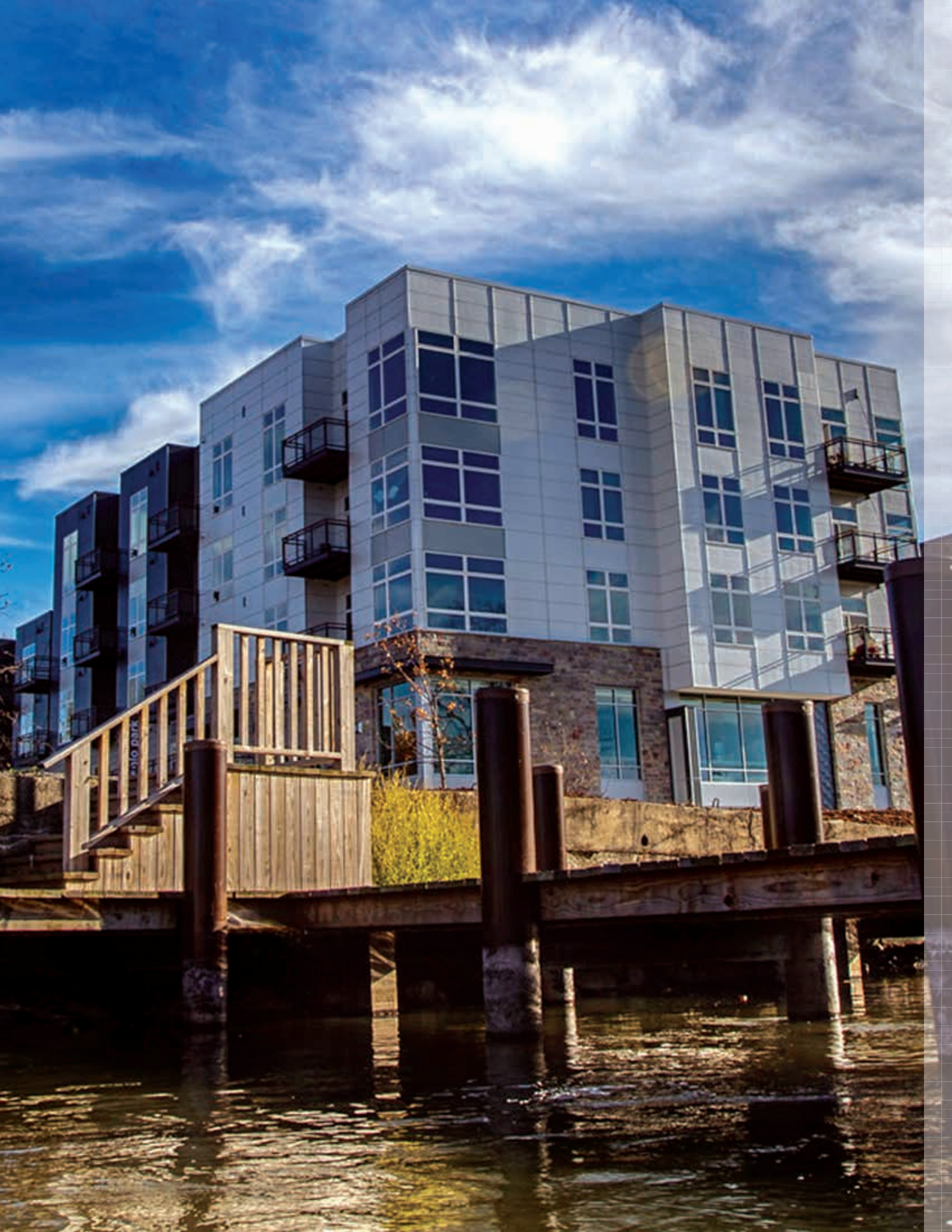

VERTICAL PROFILES

RV

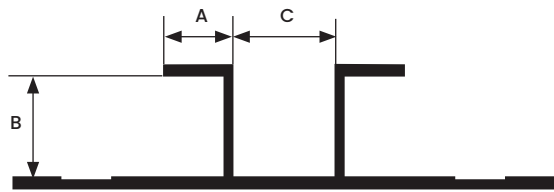

All measurements are nominal

ITEM ID	A	B	C
RV516*	3/8"	3/8"	1/2"
RV716	3/8"	7/16"	1/2"
RV58	1/2"	5/8"	5/8"
RV34	5/8"	3/4"	3/4"

All parts are 10' Length unless otherwise indicated

*In Stock in BLACK ANODIZED

DESIGN FEATURES

Designed to create a uniform, aesthetically consistent open vertical reveal between panel, lap siding, or other materials.

MATERIAL

6063-T5 .050" ± .005 extruded aluminum alloy with proprietary coating that protects against harsh weather conditions and allows for paint adhesion. For all other finish options refer to page 20.

NOTES

Do not install XtremeTrim® Vertical Reveal on horizontal applications where the exterior flange can catch/hold water.



RVT

DESIGN FEATURES

Designed to create a uniform, aesthetically consistent open vertical reveal between the transition from panel to lap siding.

MATERIAL

6063-T5 .050" ± .005 extruded aluminum alloy with proprietary coating that protects against harsh weather conditions and allows for paint adhesion. For all other finish options refer to page 20.

NOTES

Do not install XtremeTrim® Transition Vertical Reveal on horizontal applications where the exterior flange can catch/hold water.

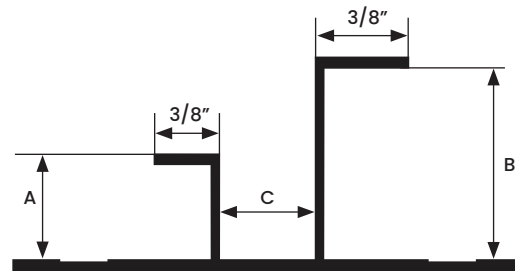
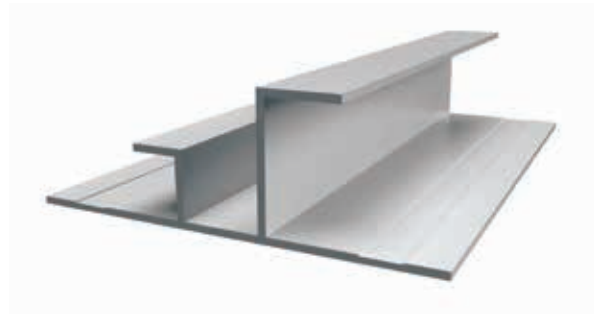

All measurements are nominal

ITEM ID	A	B	C
RVT51634	3/8"	3/4"	1/2"

All parts are 10' Length unless otherwise indicated



SHM

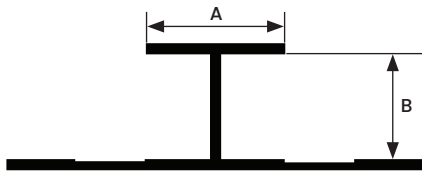
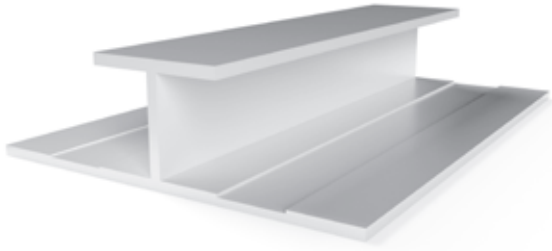

All measurements are nominal

ITEM ID	A	B
SHM516	1/2"	3/8"
SHM716	3/4"	7/16"
SHM58	3/4"	5/8"
SHM34	3/4"	3/4"
SHM1	1"	1"

All parts are 10' Length unless otherwise indicated

DESIGN FEATURES

Designed to cover vertical joints in siding. Provides a smooth seam.

MATERIAL

6063-T5 .050" ± .005 extruded aluminum alloy with proprietary coating that protects against harsh weather conditions and allows for paint adhesion. For all other finish options refer to page 20.

NOTES

Do not install XtremeTrim® Vertical Siding H Mold on horizontal applications where the exterior flange can catch/hold water.



SHM

DESIGN FEATURES

Designed to cover vertical joints where you transition from panel siding to lap siding. Provides a smooth seam.

MATERIAL

6063-T5 .050" ± .005 extruded aluminum alloy with proprietary coating that protects against harsh weather conditions and allows for paint adhesion. For all other finish options refer to page 20.

NOTES

Do not install XtremeTrim® Transition Vertical Siding H Mold on horizontal applications where exterior flange can catch/hold water.

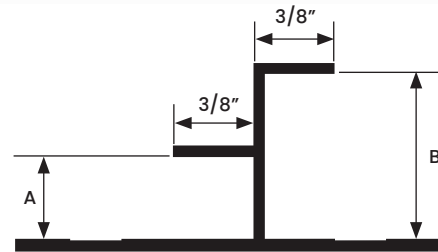
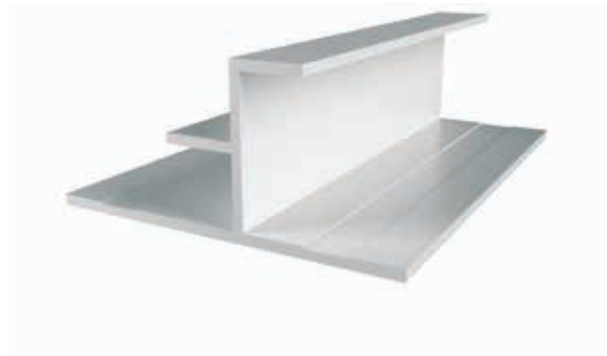
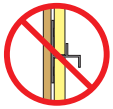

All measurements are nominal

ITEM ID	A	B
SHM51634	3/8"	3/4"

All parts are 10' Length unless otherwise indicated

BRV

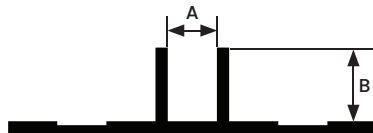
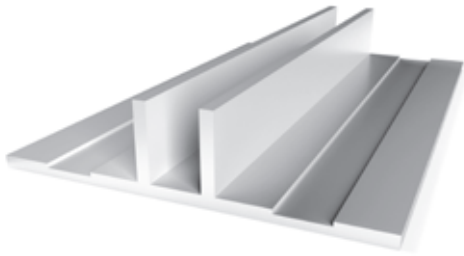

All measurements are nominal

ITEM ID	A	B
BRV14516	1/4"	5/16"
BRV12516*	1/2"	5/16"
BRV1516	1"	5/16"
BRV121	1/2"	1"

All parts are 10' Length unless otherwise indicated

*In Stock in BLACK ANODIZED

DESIGN FEATURES

Vertical Bead Reveal serves as an aesthetic joint between panels. A better, more appealing and secure solution to the "open wall" vertical joint look popular in many areas.

MATERIAL

6063-T5 .045" ± .005 extruded aluminum alloy with proprietary coating that protects against harsh weather conditions and allows for paint adhesion. For all other finish options refer to page 20.

NOTES

Do not install XtremeTrim® Vertical Bead Reveal on horizontal applications where the exterior flange can catch/hold water.



PATENT PENDING

DESIGN FEATURES

Provides a V Groove edge to panel installations.

MATERIAL

6063-T5 .050" ± .005 extruded aluminum alloy with proprietary coating that protects against harsh weather conditions and allows for paint adhesion. For all other finish options refer to page 20.

NOTES

Do not install XtremeTrim® V Groove Reveal on horizontal applications where the exterior flange can catch/hold water.

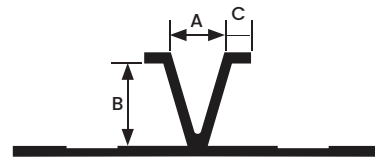
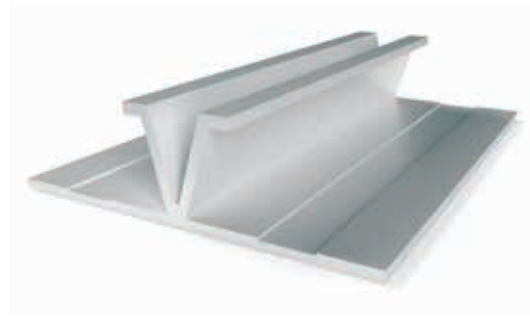
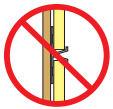

All measurements are nominal

ITEM ID	A	B	C
VR14516	1/4"	3/8"	1/8"
VR12516	1/2"	3/8"	1/8"

All parts are 10' Length unless otherwise indicated

TM

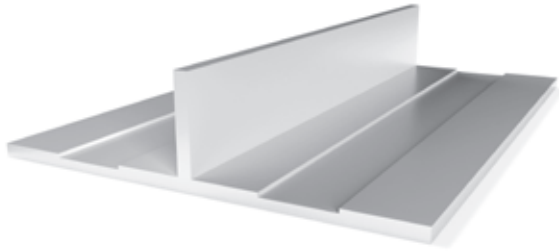

All measurements are nominal

ITEM ID	A
TM112	5/16"

All parts are 10' Length unless otherwise indicated

DESIGN FEATURES

Vertical T Mold serves as a minimal joint between panels.

MATERIAL

6063-T5 .050" ± .005 extruded aluminum alloy with proprietary coating that protects against harsh weather conditions and allows for paint adhesion. For all other finish options refer to page 20.

NOTES

Do not install XtremeTrim® Vertical T Mold on horizontal applications where the exterior flange can catch/hold water.

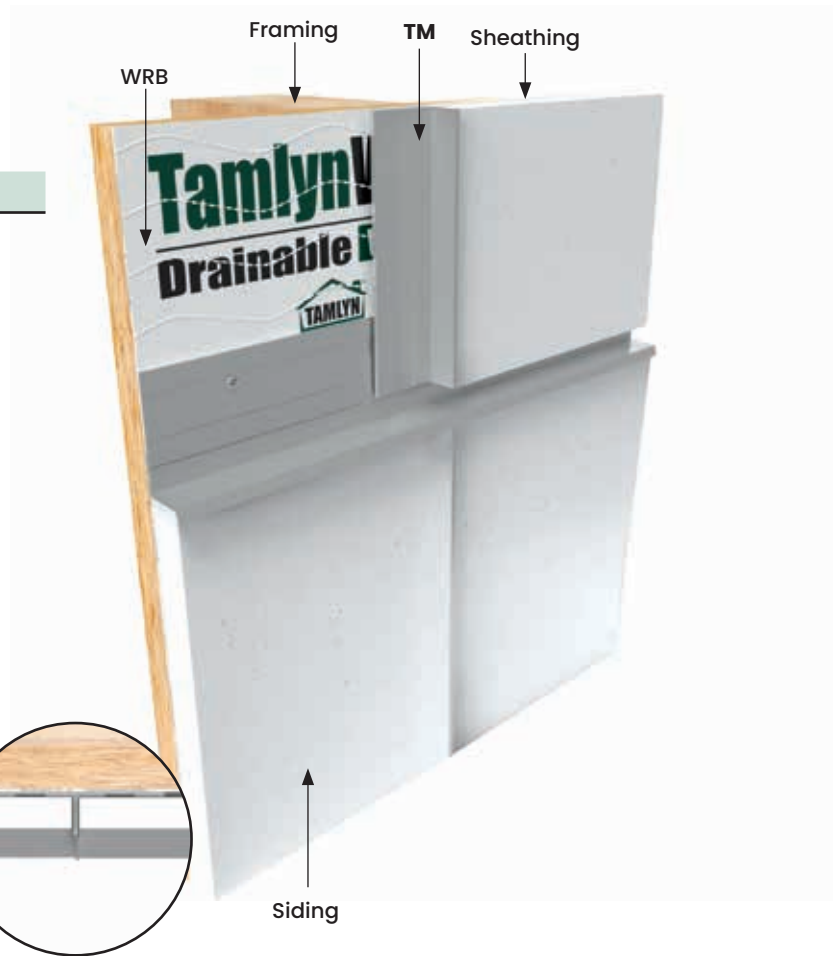
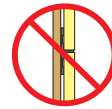

PATENT PENDING

DESIGN FEATURES

Provides a subtle projected modern batten-style vertical.

MATERIAL

6063-T5 .055" ± .005 extruded aluminum alloy with proprietary coating that protects against harsh weather conditions and allows for paint adhesion. For all other finish options refer to page 20.

NOTES

Do not install XtremeTrim® Projected Vertical on horizontal applications where the exterior flange can catch/hold water.

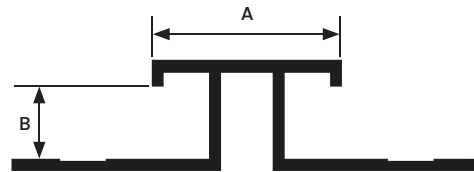
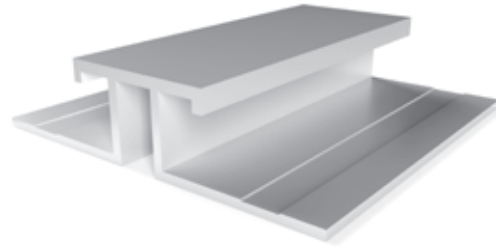

All measurements are nominal

ITEM ID	A	B
PV-100	1"	3/8"

All parts are 10' Length unless otherwise indicated





HORIZONTAL PROFILES

XZH

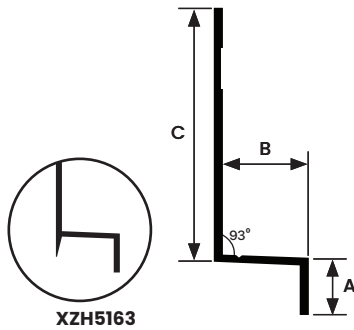

All measurements are nominal

ITEM ID	A	B	C
XZH516*	3/8"	15/32"	1-1/2"
XZH5163	3/8"	15/32"	3-1/2"
XZH716	3/8"	1/2"	1-1/2"
XZH58*	1/2"	3/4"	1-1/2"

All parts are 10' Length unless otherwise indicated

***In Stock in BLACK ANODIZED**

DESIGN FEATURES

XZH - Provides clean and consistent horizontal transition between panels. Designed to work in conjunction with Vertical Reveal and Siding H Mold.

XZH5163 - Design affords greater reveal flexibility up to 2-1/2" while working in conjunction with Vertical Reveal and Siding H-Mold.

MATERIAL

6063-T5 .050" ± .005 extruded aluminum alloy with proprietary coating that protects against harsh weather conditions and allows for paint adhesion. For all other finish options refer to page 20.

NOTES

Do not install XtremeTrim® Horizontal Z on horizontal applications where the exterior flange can catch/hold water.



DESIGN FEATURES

The Horizontal Reveal is a profile that complement the XtremeTrim® Vertical Reveal. Patented retention leg on back prevents flexing with expansion.

MATERIAL

6063-T5 .050" ± .005 extruded aluminum alloy with proprietary coating that protects against harsh weather conditions and allows for paint adhesion. For all other finish options refer to page 20.

NOTES

Do not install XtremeTrim® Horizontal Reveal on horizontal applications where the exterior flange can catch/hold water.

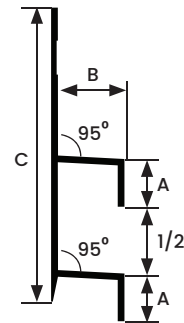

All measurements are nominal

ITEM ID	A	B	C
RH516*	3/8"	15/32"	2"
RH716	3/8"	1/2"	2"

All parts are 10' Length unless otherwise indicated

***In Stock in BLACK ANODIZED**

BRH

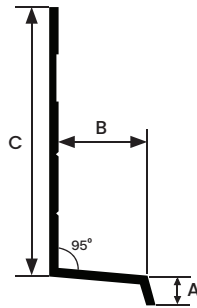

All measurements are nominal

ITEM ID	A	B	C
BRH516*	1/8"	3/8"	1-1/8"
BRH716	1/8"	1/2"	1-1/8"

All parts are 10' Length unless otherwise indicated

***In Stock in BLACK ANODIZED**

DESIGN FEATURES

Designed to work as part of a system with XtremeTrim® Vertical Bead Reveal. XtremeTrim® Horizontal Bead Reveal provides a minimal exposure while providing protection for the top edge of the lower panel.

MATERIAL

6063-T5 .040" ± .005 extruded aluminum alloy with proprietary coating that protects against harsh weather conditions and allows for paint adhesion. For all other finish options refer to page 20.

NOTES

Do not install XtremeTrim® Horizontal Bead Reveal on horizontal applications where the exterior flange can catch/hold water.



DESIGN FEATURES

Provides clean and consistent horizontal transition between panels. Can be used as independent profiles to accommodate design requirements and also the XZS516W can be used with the RV to create a vertical continuous installation and is the horizontal typically used with the RVC.

MATERIAL

6063-T5 .040" ± .005 extruded aluminum alloy with proprietary coating that protects against harsh weather conditions and allows for paint adhesion. For all other finish options refer to page 20.

NOTES

Do not install XtremeTrim® Basic Horizontal Z on horizontal applications where the exterior flange can catch/hold water.

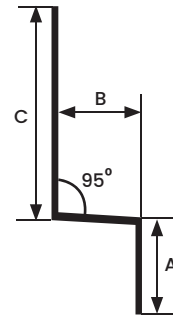

All measurements are nominal

ITEM ID	A	B	C
XZS5168	3/8"	5/16"	3/4"
XZS516W*	3/8"	5/16"	1-1/2"
XZS7168	3/8"	7/16"	1"
XZS588	3/8"	5/8"	1"

All parts are 8' Length unless otherwise indicated.

* XZS516W-10' Length



OUTSIDE CORNERS

XOCR

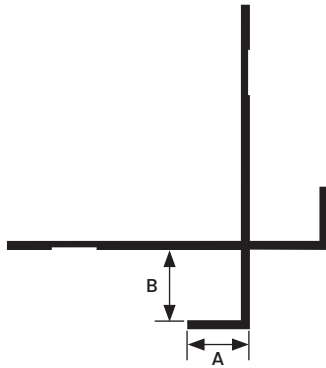

ITEM ID	A	B
XOCR516*	3/8"	3/8"
XOCR716	3/8"	7/16"
XOCR58*	1/2"	5/8"
XOCR34*	5/8"	3/4"
XOCR1	3/8"	1"
XOCR112	3/8"	1-1/2"

All parts are 10' Length unless otherwise indicated

***In Stock in BLACK ANODIZED**

DESIGN FEATURES

Provides a clean open outside corner which complement the Reveal System.

MATERIAL

6063-T5 .050" ± .005 extruded aluminum alloy with proprietary coating that protects against harsh weather conditions and allows for paint adhesion. For all other finish options refer to page 20.

NOTE

Do not install XtremeTrim® Reveal Open Outside Corner on horizontal applications where the exterior flange can catch/hold water.

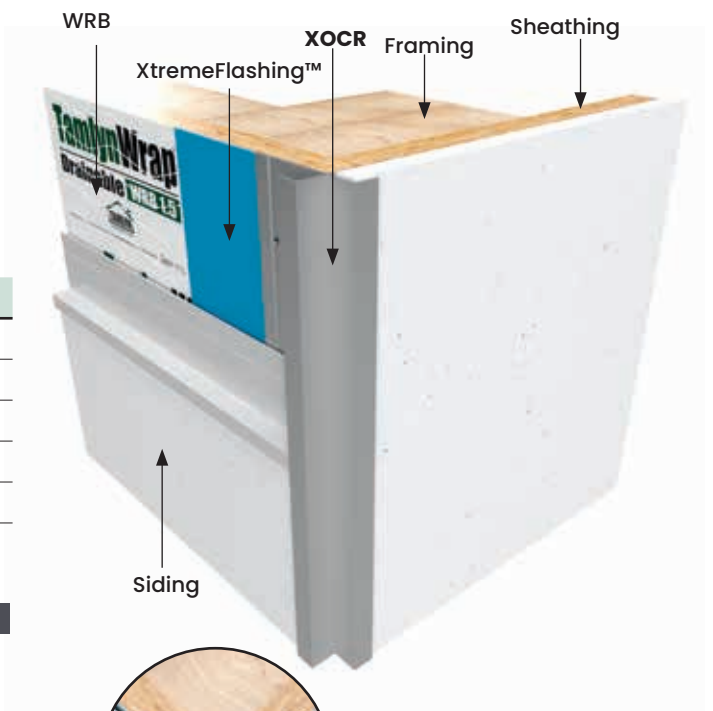

XOCR

DESIGN FEATURES

Provides a clean open outside corner transition which complement the Reveal System.

MATERIAL

6063-T5 .050" ± .005 extruded aluminum alloy with proprietary coating that protects against harsh weather conditions and allows for paint adhesion. For all other finish options refer to page 20.

NOTE

Do not install XtremeTrim® Transition Reveal Open Outside Corner on horizontal applications where the exterior flange can catch/hold water.

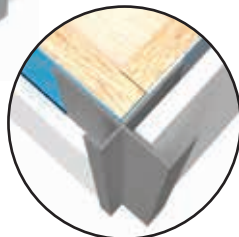
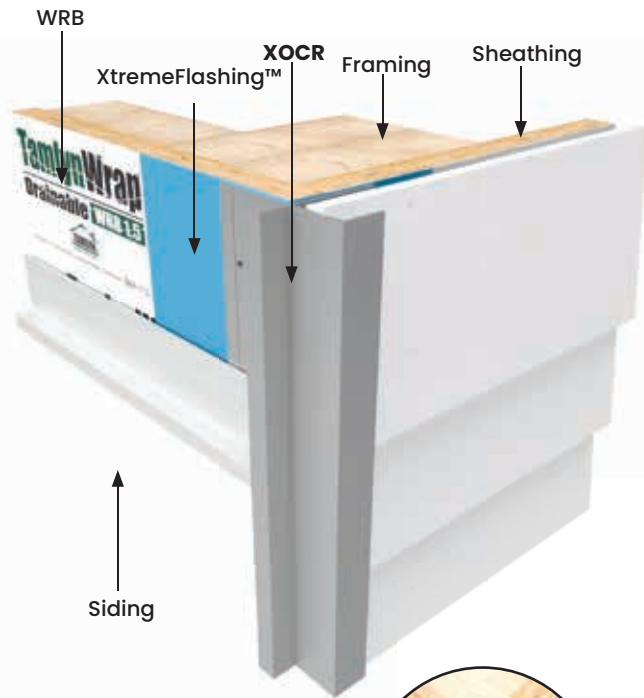
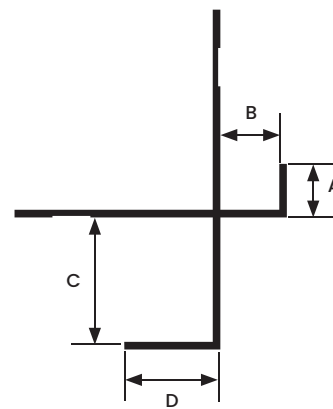
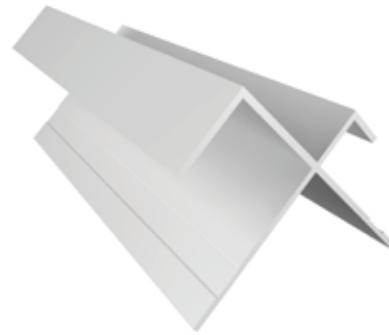

ITEM ID	A	B	C	D
XOCR51634	3/8"	3/8"	3/4"	5/8"
XOCR51612	3/8"	3/8"	1-1/2"	3/8"

All parts are 10' Length unless otherwise indicated

XOCR-135

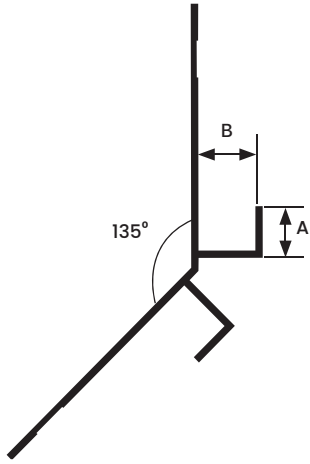

All measurements are nominal

ITEM ID	A	B
XOCR516-135	3/8"	3/8"

All parts are 10' Length unless otherwise indicated

DESIGN FEATURES

Corresponds visually to standard XOCR but designed for 135° applications. Complement the Reveal System. Works in conjunction with Vertical Reveal.

MATERIAL

6063-T5 .050" ± .005 extruded aluminum alloy with proprietary coating that protects against harsh weather conditions and allows for paint adhesion. For all other finish options refer to page 20.

NOTE

Do not install XtremeTrim® 135° Reveal Open Outside Corner on horizontal applications where the exterior flange can catch/hold water.

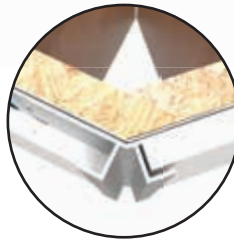
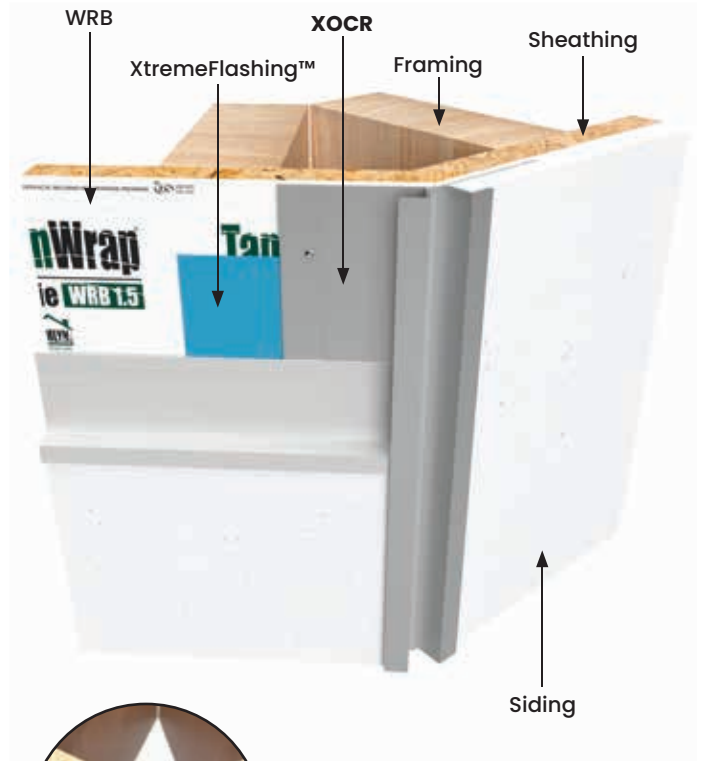

XOCRM

DESIGN FEATURES

Provides a clean, open outside corner which complement the Bead or Reveal System with minimal visible face edges. Precise panel cut is required.

MATERIAL

6063-T5 .050" ± .005 extruded aluminum alloy with proprietary coating that protects against harsh weather conditions and allows for paint adhesion. For all other finish options refer to page 20.

NOTE

Do not install XtremeTrim® Reveal Open Outside Corner Minimum Face on horizontal applications where the exterior flange can catch/hold water.

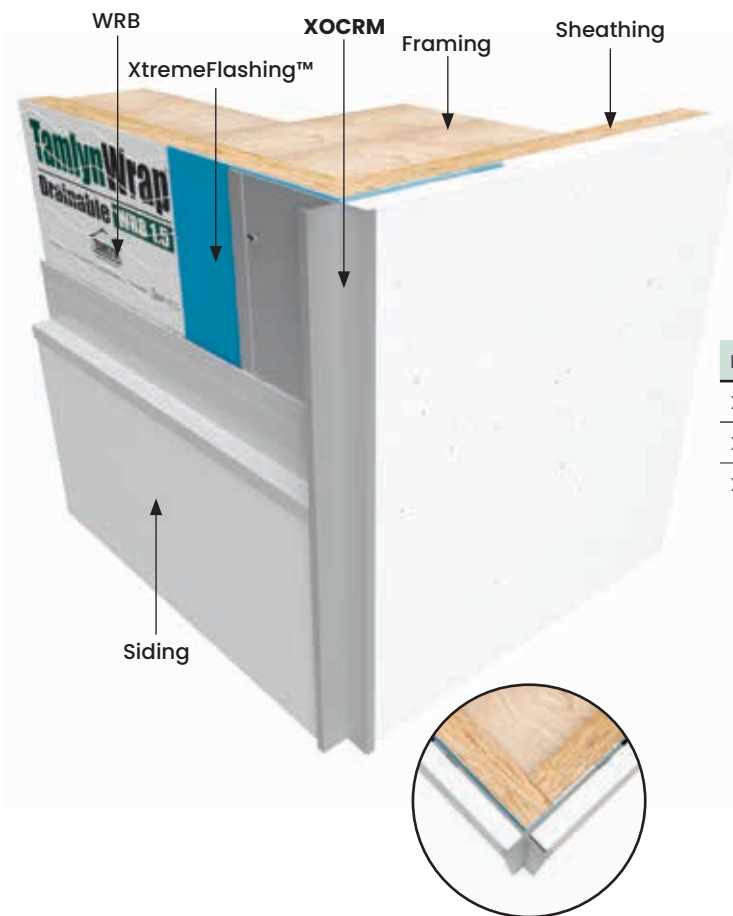
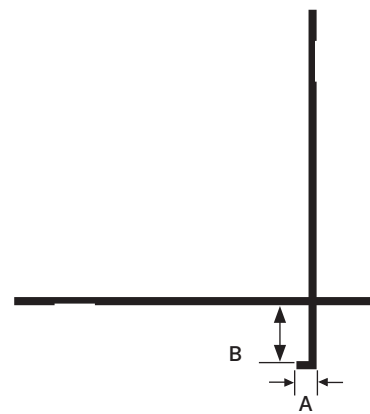

All measurements are nominal

ITEM ID	A	B
XOCR516M	1/8"	3/8"
XOCR716M	1/8"	7/16"
XOCR34M	1/8"	3/4"

All parts are 10' Length unless otherwise indicated

XOCRMA



DESIGN FEATURES

Produces a clean durable outside corner for siding panels. Tamlyn's XtremeTrim Multi Angle Outside Corner changes the industry standard detail for non 90 degree outside corners. Designers, architects, and contractors can now comfortably design and build multi angle corners to maximize lot size for interurban construction and keep a clean trim line along corners.

MATERIAL

6063-T5 .045" ± .005 extruded aluminum alloy with proprietary coating that protects against harsh weather conditions and allows for paint adhesion.

For all other finish options refer to page 20 in TAMLYN's Complete Product Catalog.

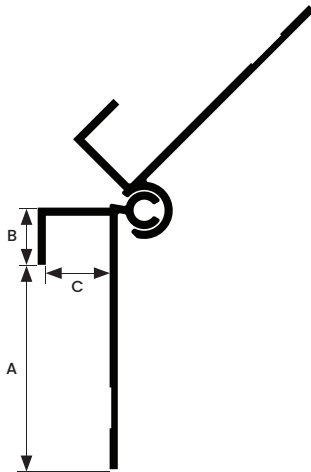

All measurements are nominal

ITEM ID	A	B	C
XOCRMA516	1-1/4	7/20	39/100

All parts are 10' Length unless otherwise indicated

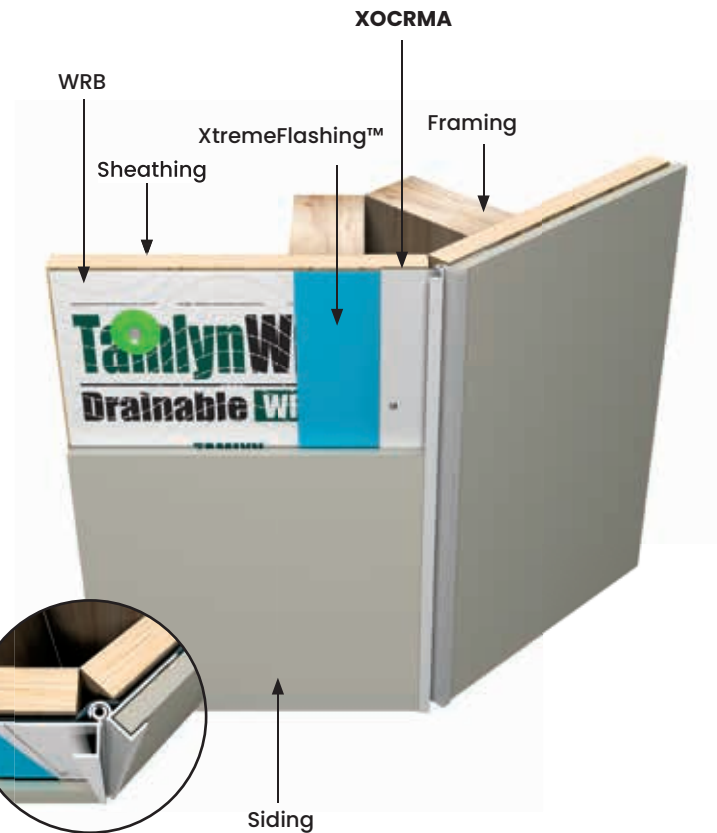

XOCLP

DESIGN FEATURES

Offers a clean outside corner for various siding materials. Works well with all vertical options.

MATERIAL

6063-T5 .050" ± .005 extruded aluminum alloy with proprietary coating that protects against harsh weather conditions and allows for paint adhesion. For all other finish options refer to page 20.

NOTE

Do not install XtremeTrim® Low Profile Outside Corner on horizontal applications where the exterior flange can catch/hold water.

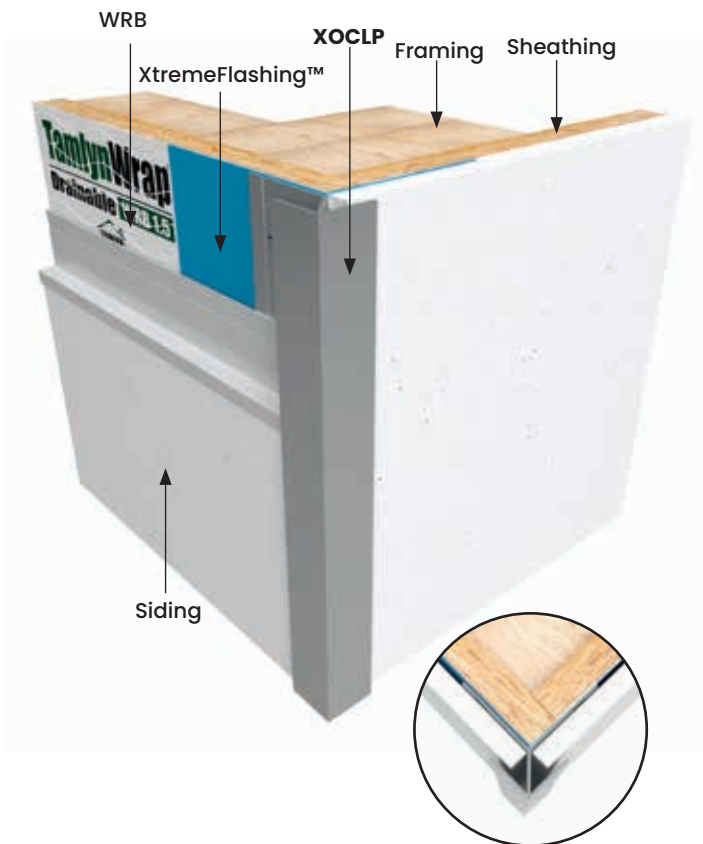
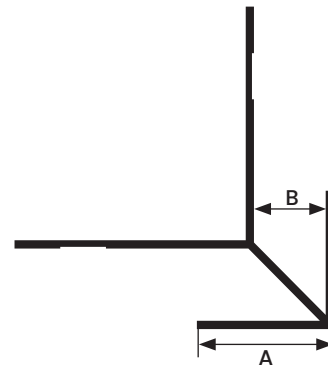

All measurements are nominal

ITEM ID	A	B
XOCLP516*	3/4"	3/8"
XOCLP716	1"	7/16"
XOCLP58*	1-1/8"	5/8"
XOCLP34*	1-1/2"	3/4"
XOCLP1	1-1/2"	1"
XOCLP114	1-3/4"	1-1/4"

All parts are 10' Length unless otherwise indicated

***In Stock in BLACK ANODIZED**

XOCLP

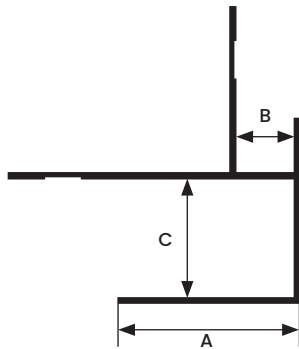
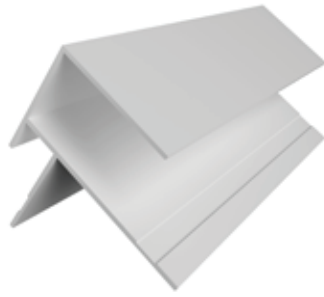

All measurements are nominal

ITEM ID	A	B	C
XOCLP51634	1-1/2"	3/8"	3/4"

All parts are 10' Length unless otherwise indicated

DESIGN FEATURES

Provides a clean outside corner for transitions.

MATERIAL

6063-T5 .050" ± .005 extruded aluminum alloy with proprietary coating that protects against harsh weather conditions and allows for paint adhesion. For all other finish options refer to page 20.

NOTE

Do not install XtremeTrim® Low Profile Outside Corner on horizontal applications where the exterior flange can catch/hold water.



XOCLP-135

DESIGN FEATURES

Corresponds visually to standard XOCLP profiles but designed for 135° applications. Works well with all vertical options.

MATERIAL

6063-T5 .050" ± .005 extruded aluminum alloy with proprietary coating that protects against harsh weather conditions and allows for paint adhesion. For all other finish options refer to page 20.

NOTE

Do not install XtremeTrim® 135° Low Profile Outside Corner on horizontal applications where the exterior flange can catch/hold water.

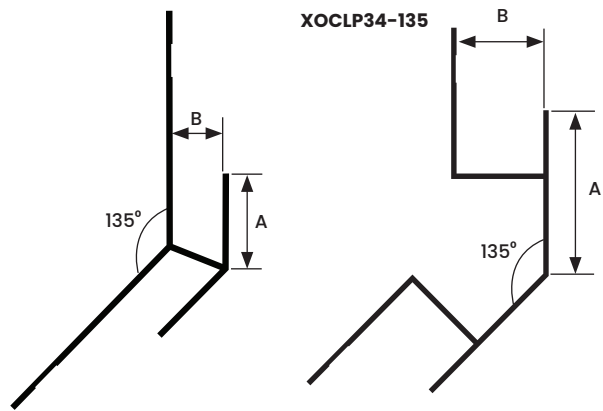
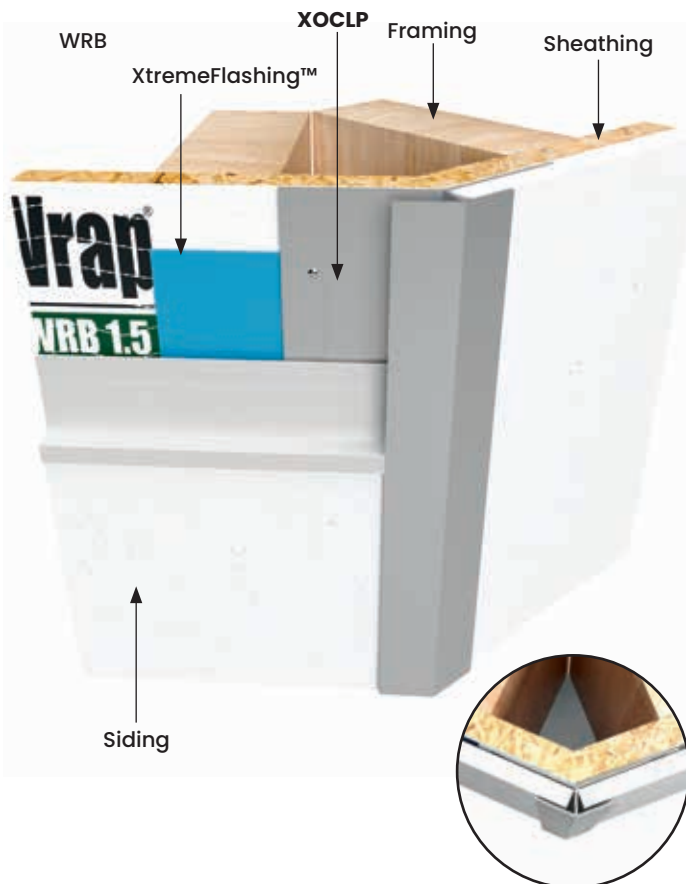

All measurements are nominal

ITEM ID	A	B
XOCLP516-135	3/4"	3/8"
XOCLP34-135	1-1/2"	3/4"

All parts are 10' Length unless otherwise indicated

XOCW

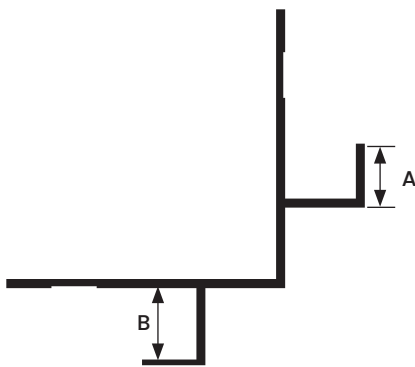
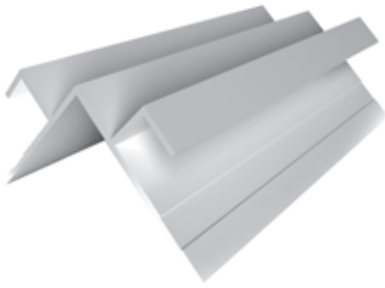

All measurements are nominal

ITEM ID	A	B
XOCW516	3/8"	3/8"
XOCW34	3/4"	3/4"

All parts are 10' Length unless otherwise indicated

DESIGN FEATURES

Stylistically similar to the Reveal Outside Corner, but offering a bolder, wider, more visible outside corner profile effect.

MATERIAL

6063-T5 .050" ± .005 extruded aluminum alloy with proprietary coating that protects against harsh weather conditions and allows for paint adhesion. For all other finish options refer to page 20.

NOTE

Do not install XtremeTrim® Reveal W Outside Corner on horizontal applications where the exterior flange can catch/hold water.

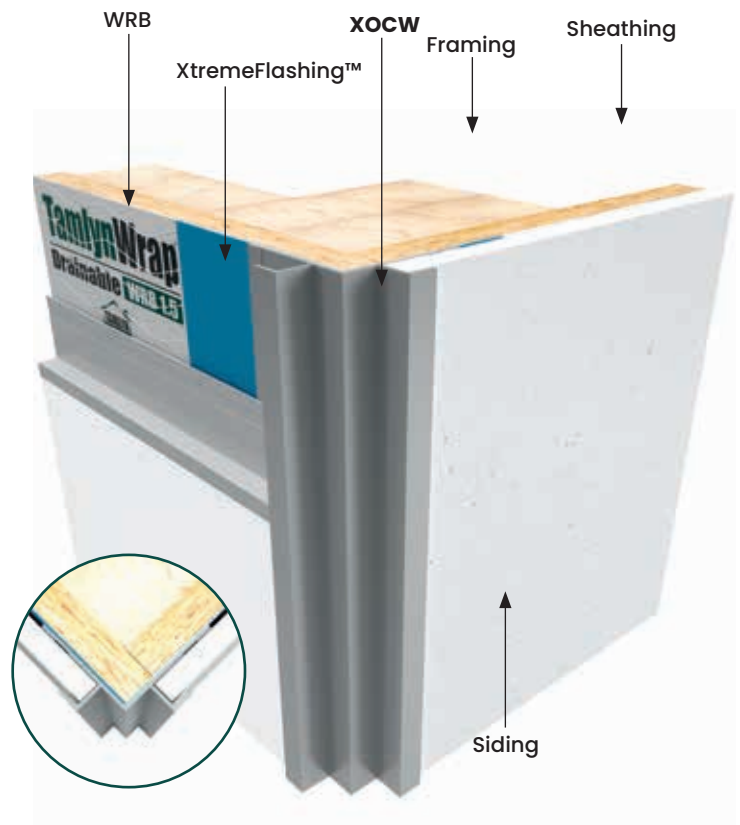

XOCBT

DESIGN FEATURES

Gives a solid appearance with the versatility to be used with mixed materials and any vertical and horizontal profiles.

MATERIAL

6063-T5 .050" ± .005 extruded aluminum alloy with proprietary coating that protects against harsh weather conditions and allows for paint adhesion. For all other finish options refer to page 20.

NOTE

Do not install XtremeTrim® Butted Outside Corner on horizontal applications where the exterior flange can catch/hold water.

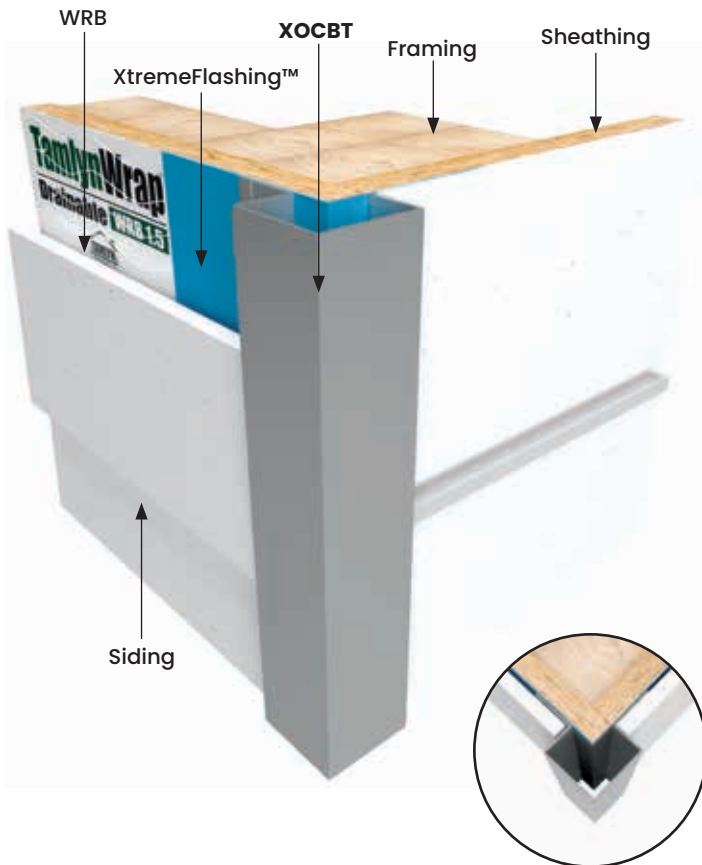
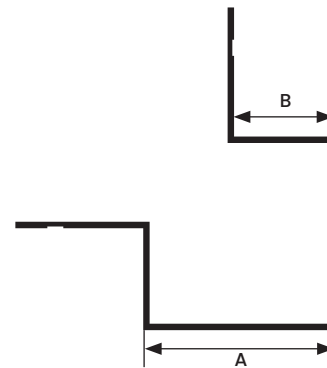

All measurements are nominal

ITEM ID	A	B
XOCBT	1-1/2"	3/4"

All parts are 10' Length unless otherwise indicated

XOCX

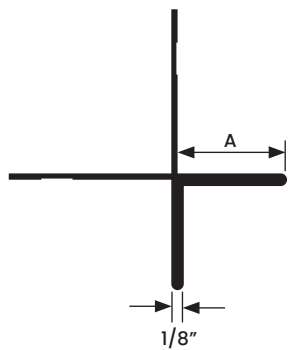
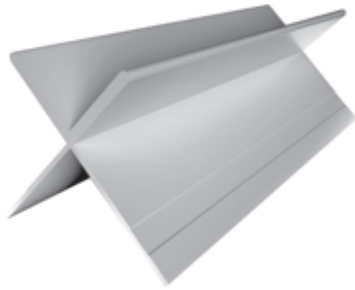

All measurements are nominal

ITEM ID	A
XOCX78	7/8"

All parts are 10' Length unless otherwise indicated

DESIGN FEATURES

Allows a minimal corner style for panel or plank with uncovered edges.

MATERIAL

6063-T5 .050" ± .005 extruded aluminum alloy with proprietary coating that protects against harsh weather conditions and allows for paint adhesion. For all other finish options refer to page 20.

NOTE

Do not install XtremeTrim® Bold X Outside Corner on horizontal applications where the exterior flange can catch/hold water.

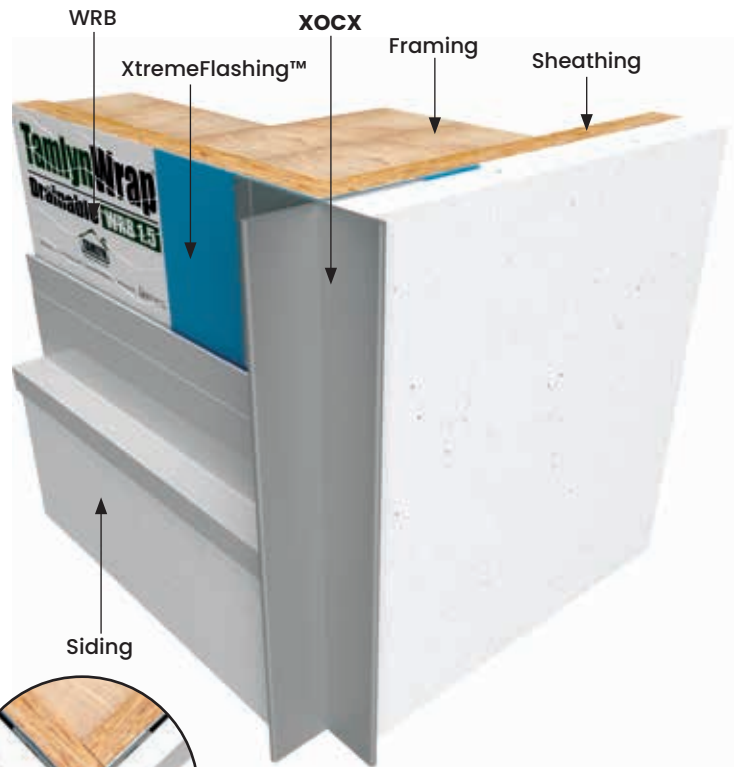

XOCB

DESIGN FEATURES

Provides a smooth, rounded outside corner for vertical siding panels.

MATERIAL

6063-T5 .050" ± .005 extruded aluminum alloy with proprietary coating that protects against harsh weather conditions and allows for paint adhesion. For all other finish options refer to page 20.

NOTE

Do not install XtremeTrim® Bullnose Outside Corner on horizontal applications where the exterior flange can catch/hold water.

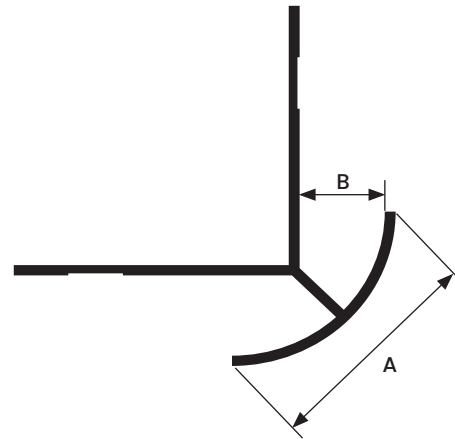
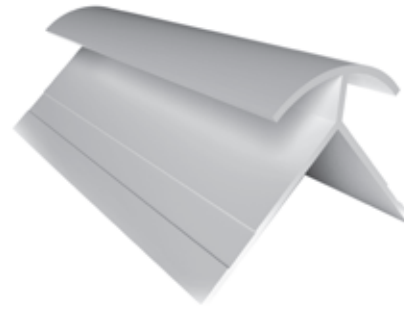

All measurements are nominal

ITEM ID	A	B
XOCB516	1-1/16"	3/8"

All parts are 10' Length unless otherwise indicated

XOCAS

PATENT PENDING

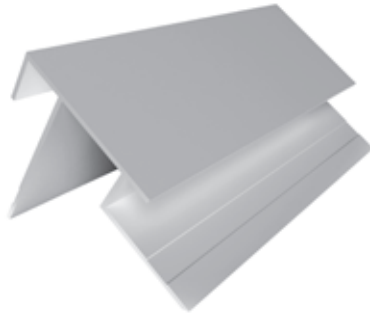

DESIGN FEATURES

Unique asymmetrical square corner which offers a 3:1 exposure.

MATERIAL

6063-T5 .050" ± .005 extruded aluminum alloy with proprietary coating that protects against harsh weather conditions and allows for paint adhesion. For all other finish options refer to page 20.

NOTE

Do not install XtremeTrim® Panel Asymmetrical Square Outside Corner on horizontal applications where the exterior flange can catch/hold water.

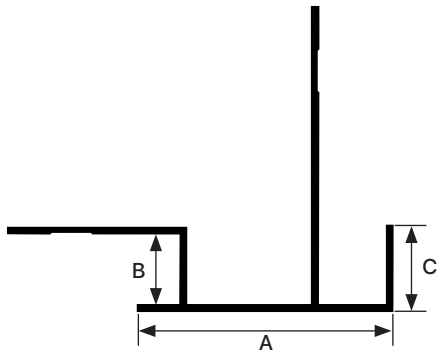

All measurements are nominal

ITEM ID	A	B	C
XOCAS516	1-1/2"	3/8"	1/2"

All parts are 10' Length unless otherwise indicated

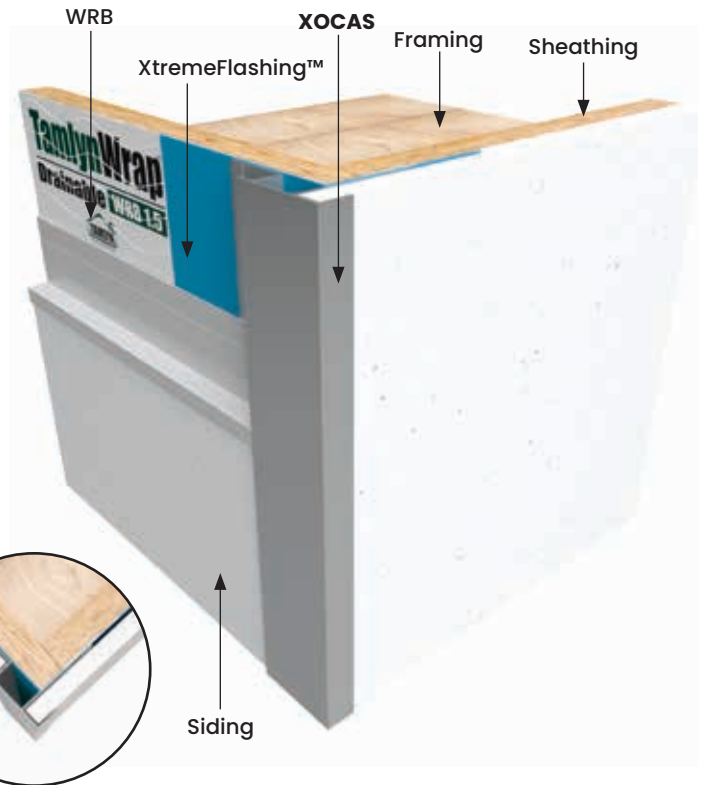

XOCAT

PATENT PENDING

DESIGN FEATURES

Unique asymmetrical corner which offers a 3:1 exposure and a subtle taper.

MATERIAL

6063-T5 .050" ± .005 extruded aluminum alloy with proprietary coating that protects against harsh weather conditions and allows for paint adhesion. For all other finish options refer to page 20.

NOTE

Do not install XtremeTrim® Panel Asymmetrical Tapered Outside Corner on horizontal applications where the exterior flange can catch/hold water.

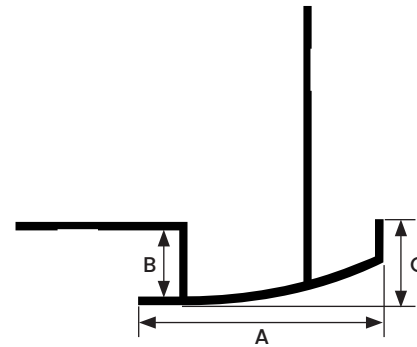
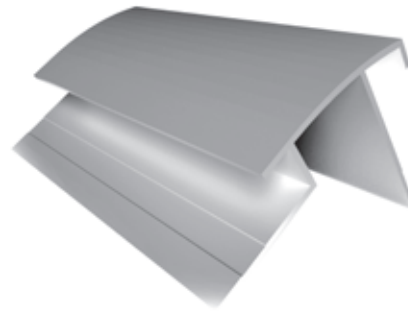

All measurements are nominal

ITEM ID	A	B	C
XOCAT516	1-1/2"	3/8"	1/2"

All parts are 10' Length unless otherwise indicated

XOCBL

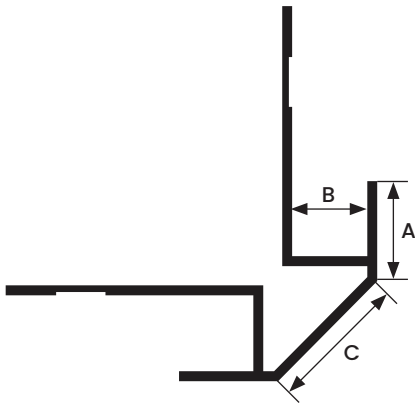
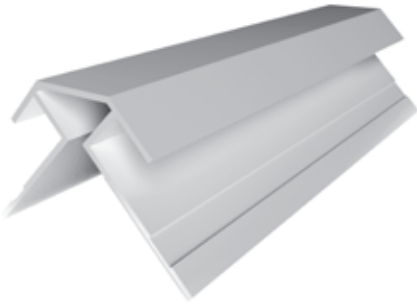

All measurements are nominal

ITEM ID	A	B	C
XOCBL516	1/2"	3/8"	3/4"

All parts are 10' Length unless otherwise indicated

DESIGN FEATURES

Unique design creates an aesthetically attractive chamfer style corner look for a strong durable outside corner with vertical siding panels.

MATERIAL

6063-T5 .050" ± .005 extruded aluminum alloy with proprietary coating that protects against harsh weather conditions and allows for paint adhesion. For all other finish options refer to page 20.

NOTE

Do not install XtremeTrim® Blunt Panel Outside Corner on horizontal applications where the exterior flange can catch/hold water.

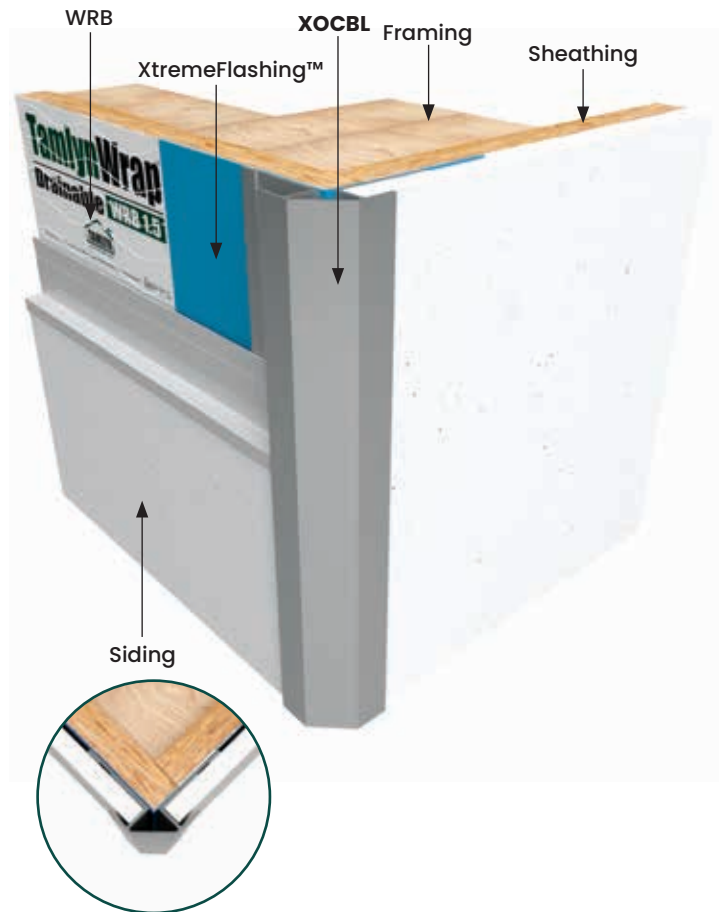

XOCRB

PATENT PENDING

DESIGN FEATURES

Unique corner that provides a chamfered reveal.

MATERIAL

6063-T5 .050" ± .005 extruded aluminum alloy with proprietary coating that protects against harsh weather conditions and allows for paint adhesion. For all other finish options refer to page 20.

NOTE

Do not install XtremeTrim® Blunt Panel Reveal Outside Corner on horizontal applications where the exterior flange can catch/hold water.

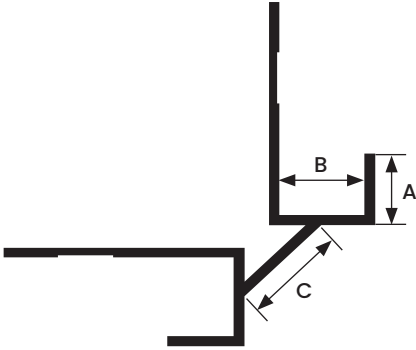
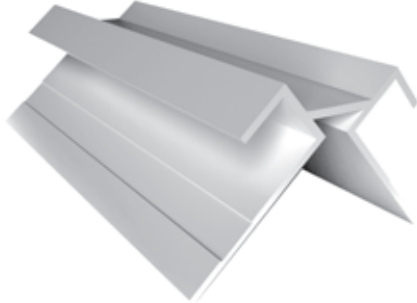

All measurements are nominal

ITEM ID	A	B	C
XOCRB516	3/8"	3/8"	1/2"

All parts are 10' Length unless otherwise indicated

XOCDR

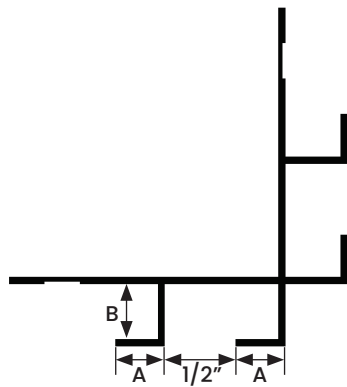
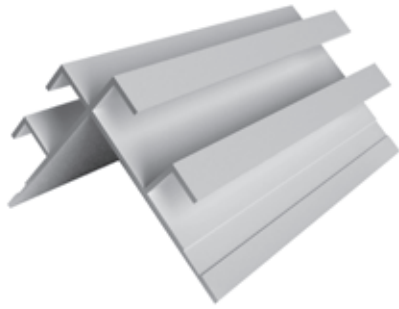

All measurements are nominal

ITEM ID	A	B
XOCDR516	3/8"	3/8"

All parts are 10' Length unless otherwise indicated

DESIGN FEATURES

An outside corner that complement the Vertical Reveal System.

MATERIAL

6063-T5 .050" ± .005 extruded aluminum alloy with proprietary coating that protects against harsh weather conditions and allows for paint adhesion. For all other finish options refer to page 20.

NOTE

Do not install XtremeTrim® Double Reveal Outside Corner on horizontal applications where the exterior flange can catch/hold water.

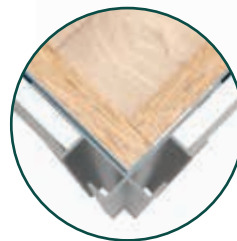
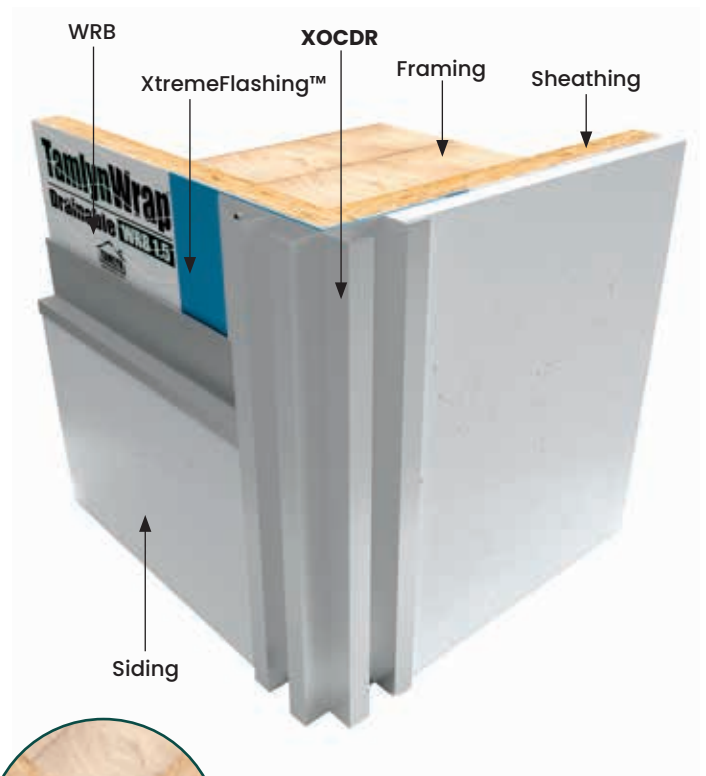

XOCSR

DESIGN FEATURES

A unique outside corner that provide a solid squared corner with a reveal making it a good compliment to either the Reveal or Flat system.

MATERIAL

6063-T5 .050" ± .005 extruded aluminum alloy with proprietary coating that protects against harsh weather conditions and allows for paint adhesion. For all other finish options refer to page 20.

NOTE

Do not install XtremeTrim® Square Reveal Outside Corner on horizontal applications where the exterior flange can catch/hold water.

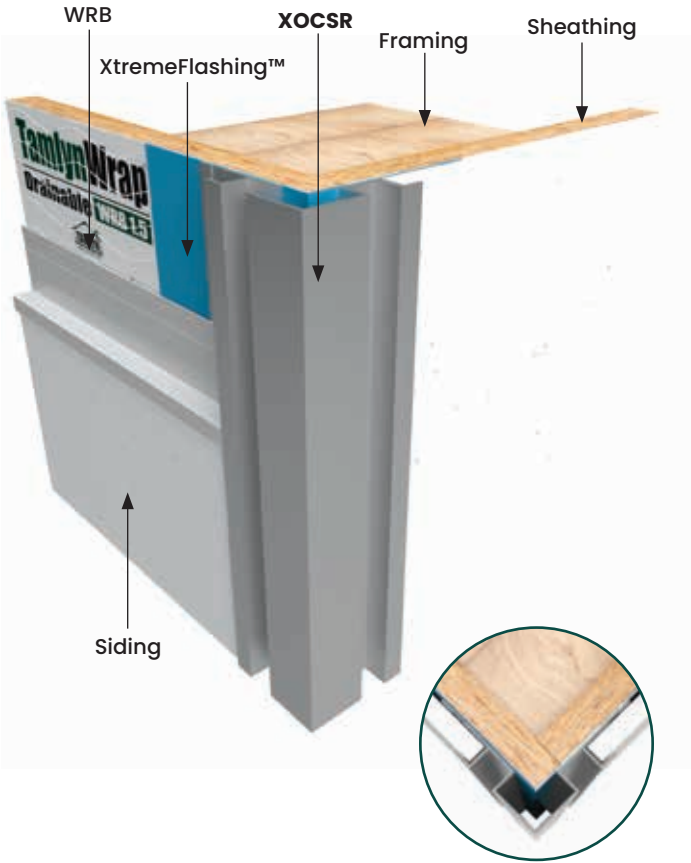
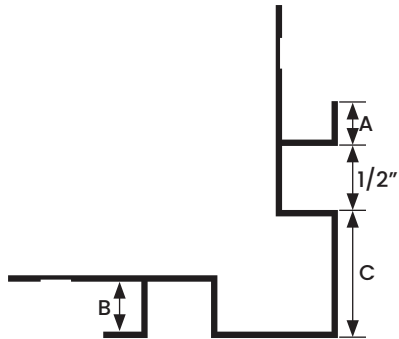
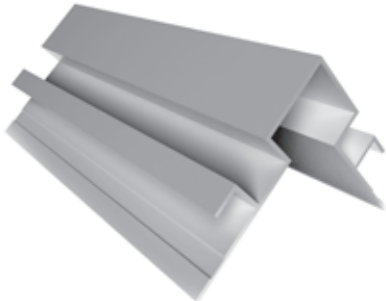

All measurements are nominal

ITEM ID	A	B	C
XOCSR516	3/8"	3/8"	1"

All parts are 10' Length unless otherwise indicated

XOCBN

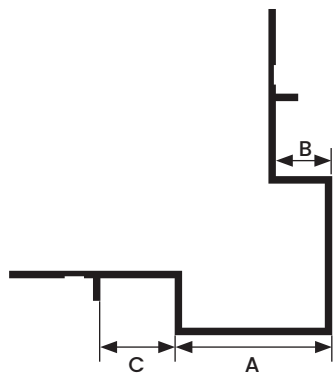
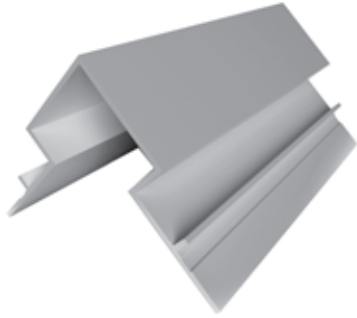

All measurements are nominal

ITEM ID	A	B	C
XOCBN516	1"	3/8"	1/2"

All parts are 10' Length unless otherwise indicated

DESIGN FEATURES

Batten Corner offers a bold, unique corner for vertical siding panels. Tabs create a reveal corner. Pairs well with the Bead system.

MATERIAL

6063-T5 .050" ± .005 extruded aluminum alloy with proprietary coating that protects against harsh weather conditions and allows for paint adhesion. For all other finish options refer to page 20.

NOTE

Do not install XtremeTrim® Batten Panel Outside Corner on horizontal applications where exterior flange can catch/hold water.

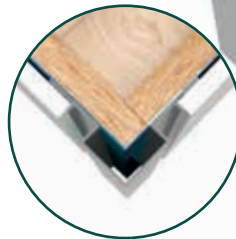
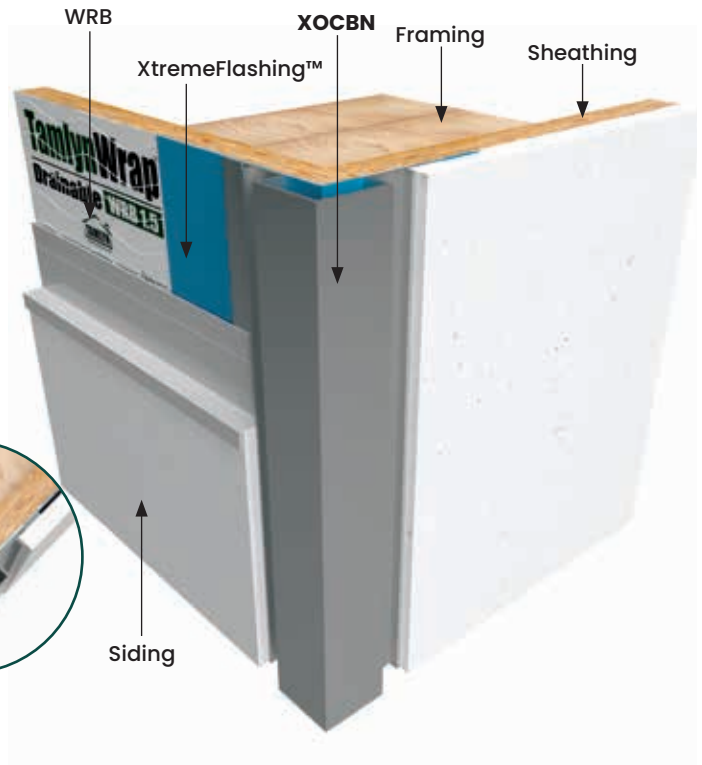
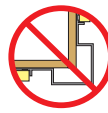

DESIGN FEATURES

A traditional outside corner without the joints, caulked seams and nail holes that butted 1x4s require.

MATERIAL

6063-T5 .050" ± .005 extruded aluminum alloy with proprietary coating that protects against harsh weather conditions and allows for paint adhesion. For all other finish options refer to page 20.

NOTE

Do not install XtremeTrim® 3-1/2" Outside Corner on horizontal applications where the exterior flange can catch/hold water.

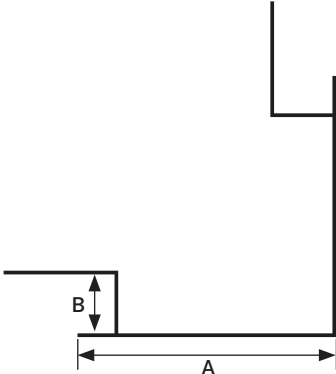
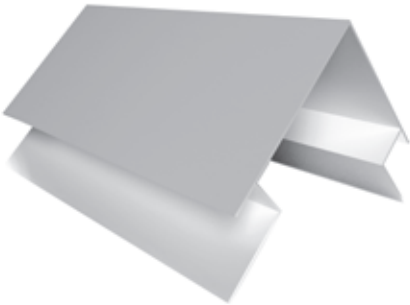

All measurements are nominal

ITEM ID	A	B
XOC312	3-1/2"	3/4"

All parts are 10' Length unless otherwise indicated

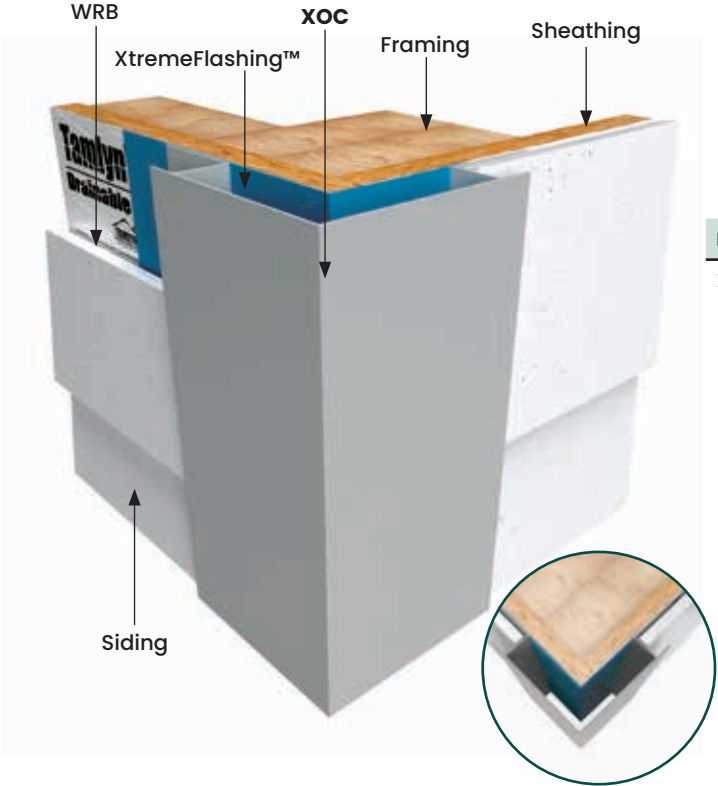



INSIDE CORNERS



DESIGN FEATURES

W Inside Corner provides a minimal exposure for the inside corner. At larger dimensions eliminates wood as a material for inside corners which will split/rot over time.

MATERIAL

6063-T5 .050" ± .005 extruded aluminum alloy with proprietary coating that protects against harsh weather conditions and allows for paint adhesion. For all other finish options refer to page 20.

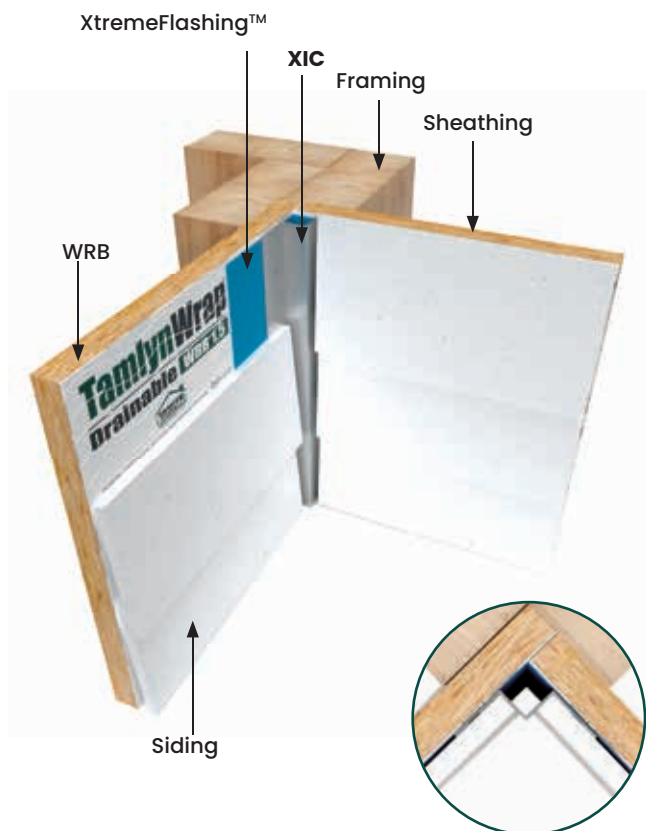
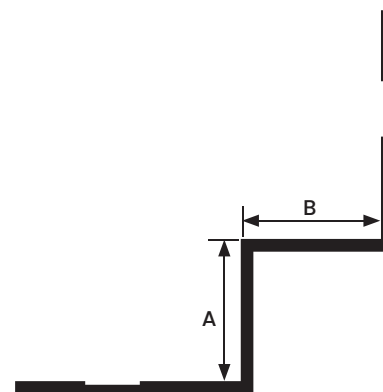

All measurements are nominal

ITEM ID	A	B	SIDING SIZE
XIC516*	1/2"	1/2"	7/16" or smaller
XIC34*	7/8"	7/8"	5/8" or larger
XIC112	1-1/2"	1-1/2"	--

All parts are 10' Length unless otherwise indicated

*In Stock in BLACK ANODIZED

XIC

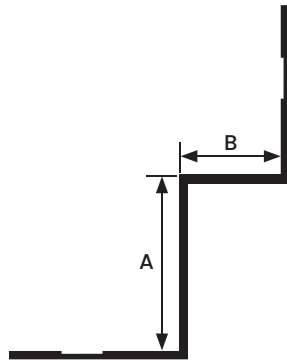
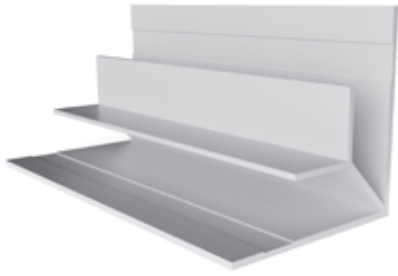

All measurements are nominal

ITEM ID	A	B
XIC51634	1/2"	7/8"

All parts are 10' Length unless otherwise indicated

*In Stock in BLACK ANODIZED

DESIGN FEATURES

W Inside Corner provides a minimal exposure for the inside corner. At larger dimensions eliminates wood as a material for inside corners which will split/rot over time.

MATERIAL

6063-T5 .050" ± .005 extruded aluminum alloy with proprietary coating that protects against harsh weather conditions and allows for paint adhesion. For all other finish options refer to page 20.

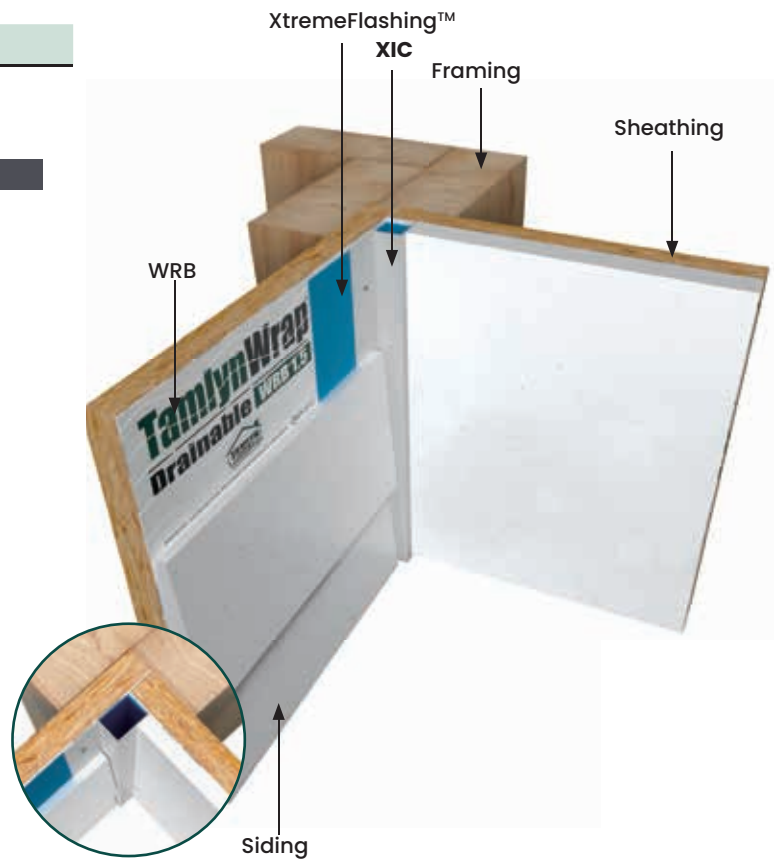

XICLP

DESIGN FEATURES

Faces help to produce a clean and durable inside corner that complement many vertical and horizontal options.

MATERIAL

6063-T5 .050" ± .005 extruded aluminum alloy with proprietary coating that protects against harsh weather conditions and allows for paint adhesion. For all other finish options refer to page 20.

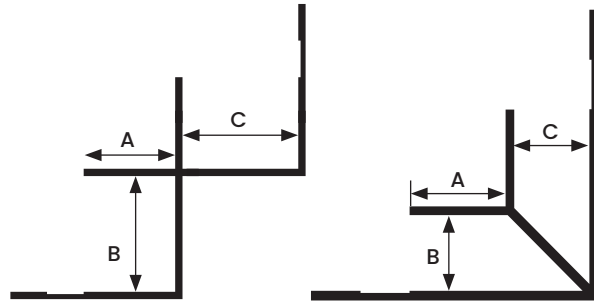
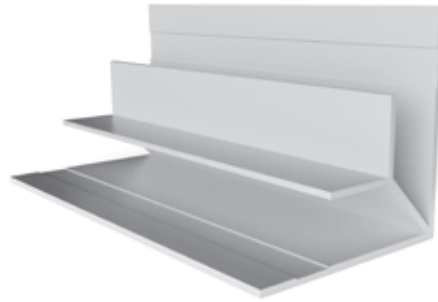

All measurements are nominal

ITEM ID	A	B	C
XICLP516*	3/8"	3/8"	3/8"
XICLP716	3/8"	15/32"	1/2"
XICLP34*	5/8"	3/4"	3/4"
XICLP1	7/16"	1"	1"

All parts are 10' Length unless otherwise indicated

*In Stock in BLACK ANODIZED

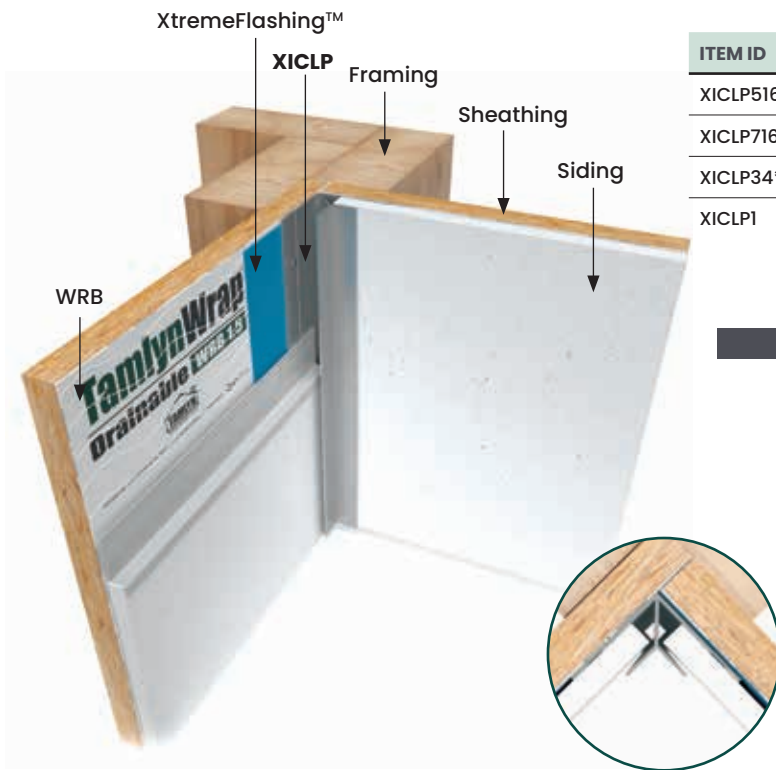

XICLP

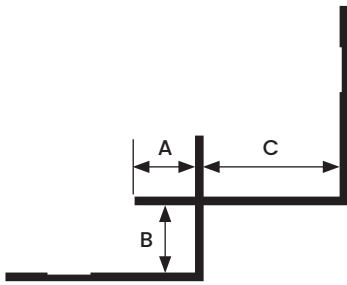
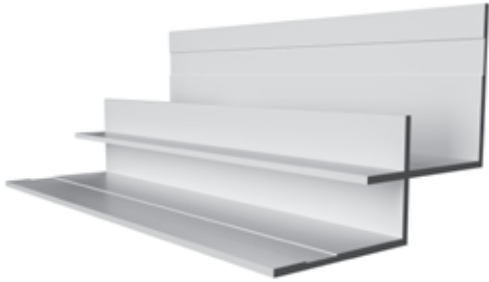

All measurements are nominal

ITEM ID	A	B	C
XICLP51634	3/8"	3/8"	3/4"
XICLP51612	3/8"	3/8"	1-1/2"

All parts are 10' Length unless otherwise indicated

DESIGN FEATURES

Faces help to produce a clean and durable inside corner that complement many vertical and horizontal options.

MATERIAL

6063-T5 .050" ± .005 extruded aluminum alloy with proprietary coating that protects against harsh weather conditions and allows for paint adhesion. For all other finish options refer to page 20.

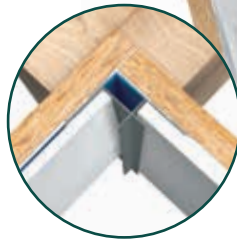
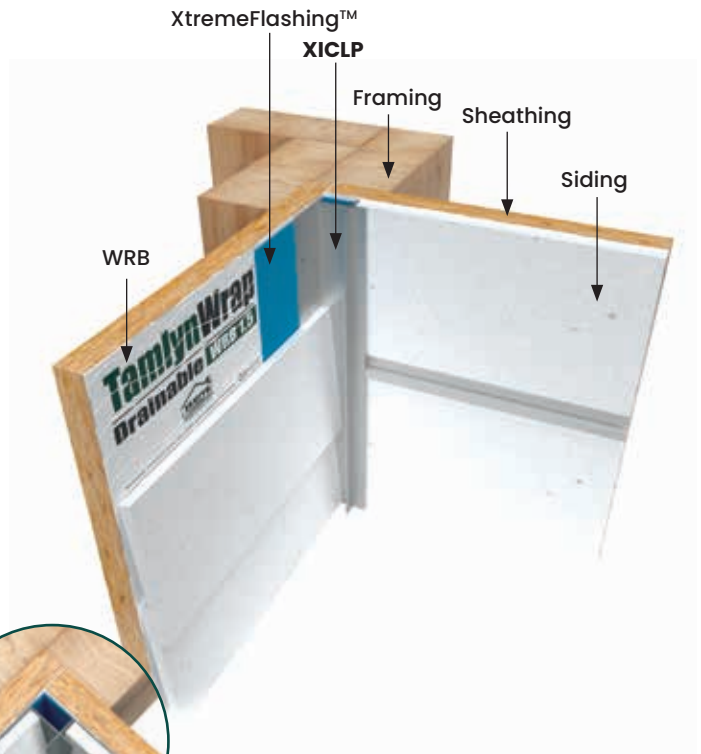

XICLP-135

DESIGN FEATURES

Corresponds visually to standard XICLP profiles but designed for 135° applications.

MATERIAL

6063-T5 .050" ± .005 extruded aluminum alloy with proprietary coating that protects against harsh weather conditions and allows for paint adhesion. For all other finish options refer to page 20.

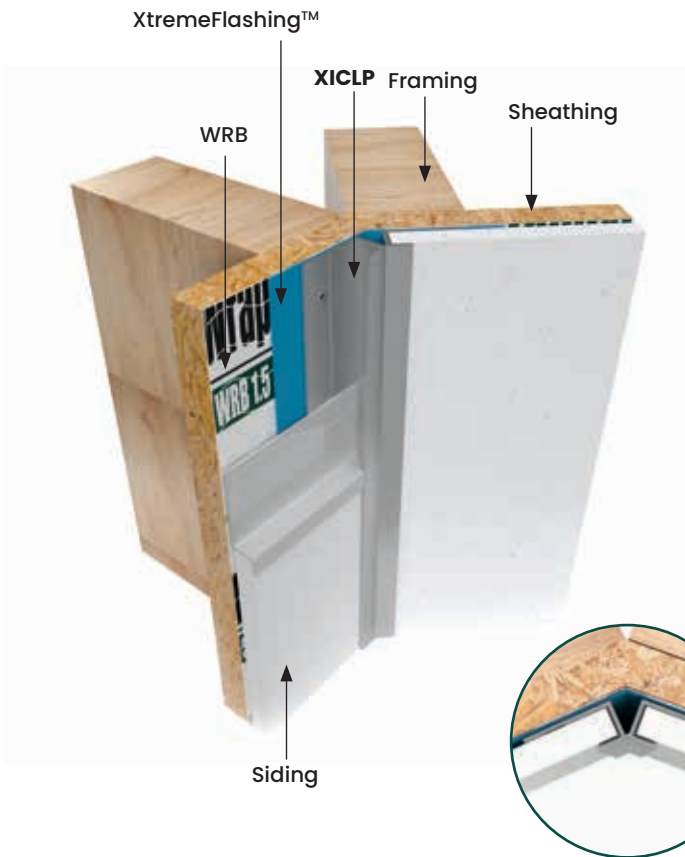
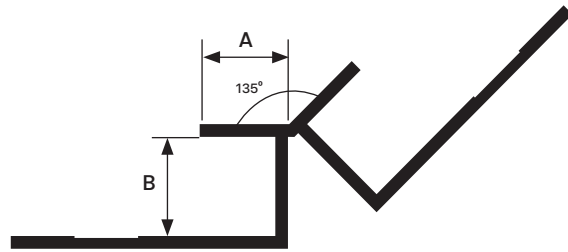
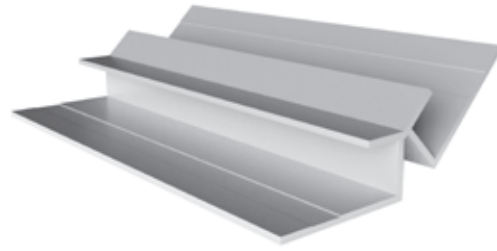

All measurements are nominal

ITEM ID	A	B
XICLP516-135	3/8"	3/8"
XICLP34-135	5/8"	3/4"

All parts are 10' Length unless otherwise indicated

XICR

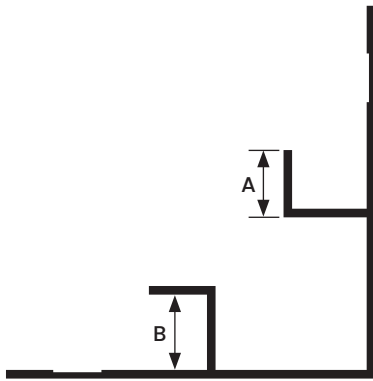
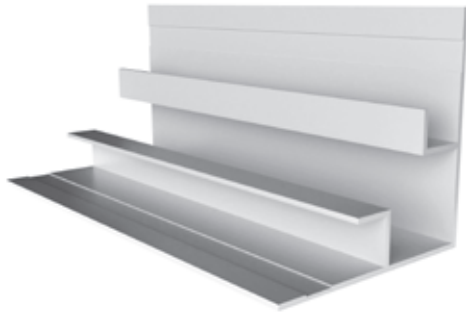

All measurements are nominal

ITEM ID	A	B
XICR516	3/8"	3/8"

All parts are 10' Length unless otherwise indicated

DESIGN FEATURES

Provides a clean, open inside corner which complement the Reveal System.

MATERIAL

6063-T5 .050 " ± .005 extruded aluminum alloy with proprietary coating that protects against harsh weather conditions and allows for paint adhesion. For all other finish options refer to page 20.

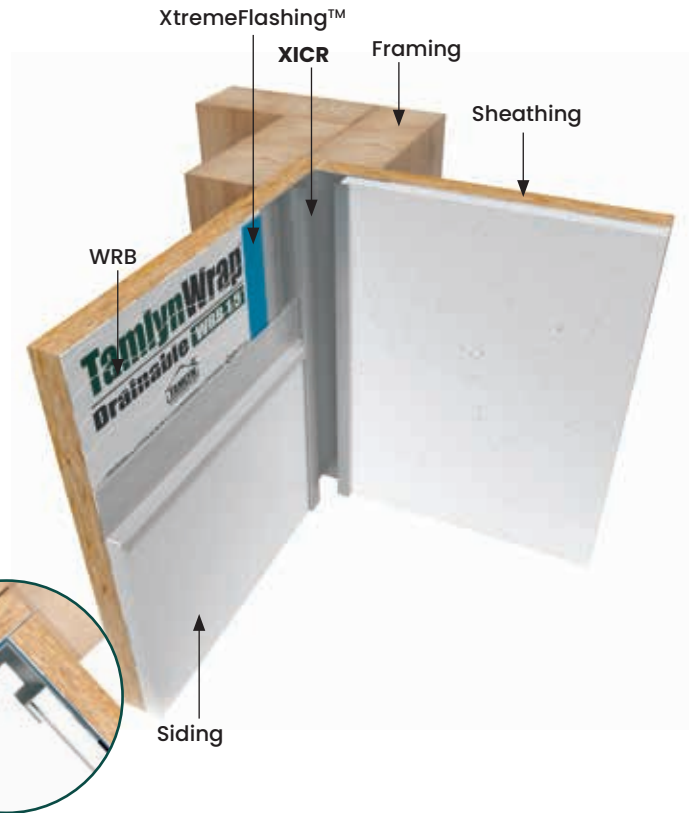

XICRMA

DESIGN FEATURES

Produces a clean durable inside corner for siding panels. Tamlyn's XtremeTrim Multi Angle Inside Corner changes the industry standard detail for non 90 degree outside corners. Designers, architects, and contractors can now comfortably design and build multi angle corners to maximize lot size for interurban construction and keep a clean trim line along corners.

MATERIAL

6063-T5 .045" ± .005 extruded aluminum alloy with proprietary coating that protects against harsh weather conditions and allows for paint adhesion.

For all other finish options refer to page 20 in TAMLYN's Complete Product Catalog.

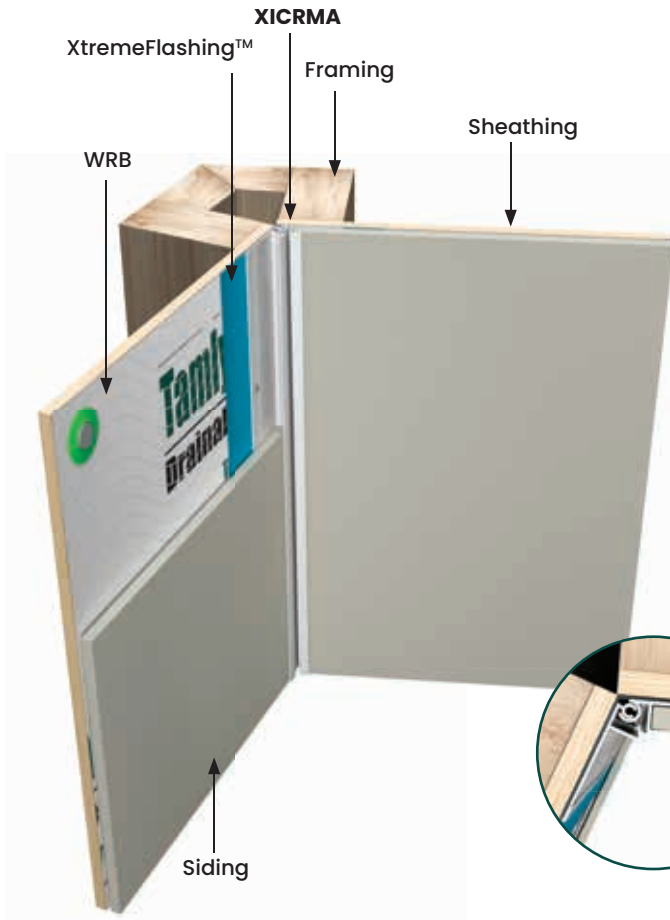
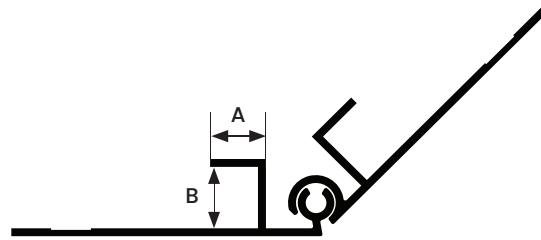

All measurements are nominal

ITEM ID	A	B
XICRMA516	3/8"	3/8"

All parts are 10' Length unless otherwise indicated

XICB

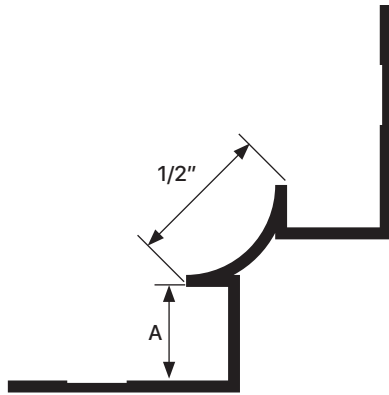
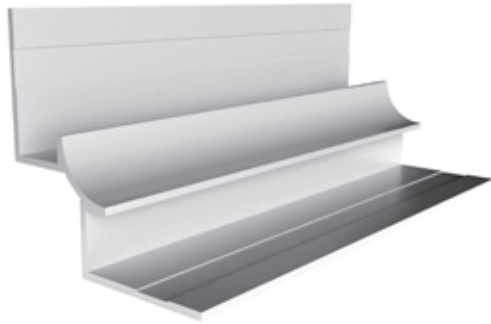

All measurements are nominal

ITEM ID	A
XICB516	3/8"

All parts are 10' Length unless otherwise indicated

DESIGN FEATURES

Provides a smooth, rounded inside corner for vertical siding panels.

MATERIAL

6063-T5 .050" ± .005 extruded aluminum alloy with proprietary coating that protects against harsh weather conditions and allows for paint adhesion. For all other finish options refer to page 20.

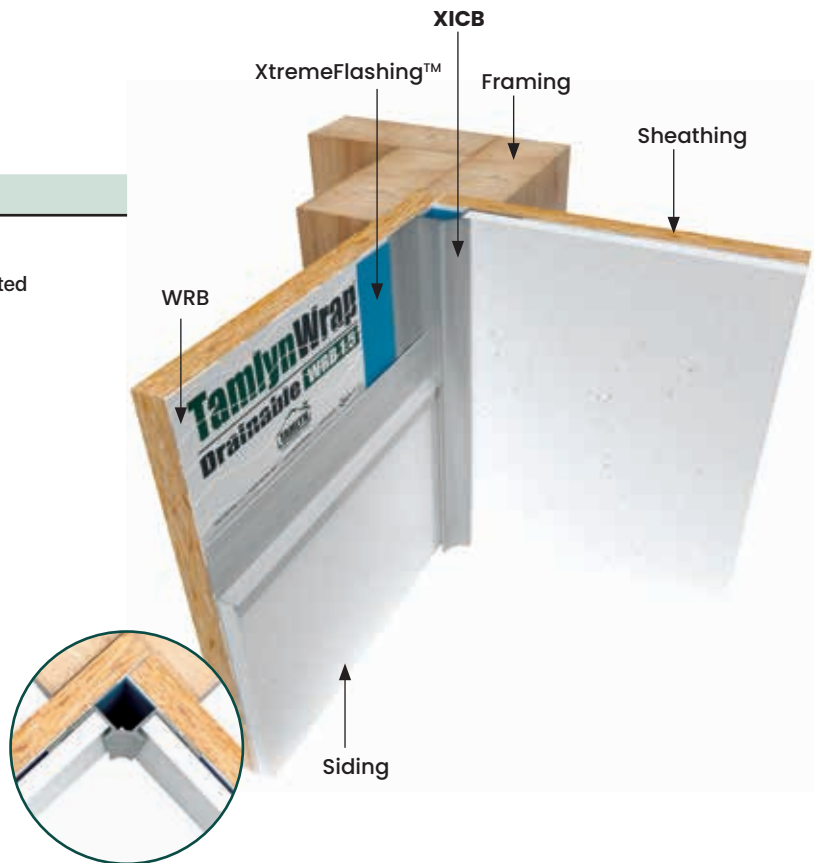

XICBL

DESIGN FEATURES

Unique design creates an aesthetic chamfered inside corner.

MATERIAL

6063-T5 .050 " ± .005 extruded aluminum alloy with proprietary coating that protects against harsh weather conditions and allows for paint adhesion. For all other finish options refer to page 20.

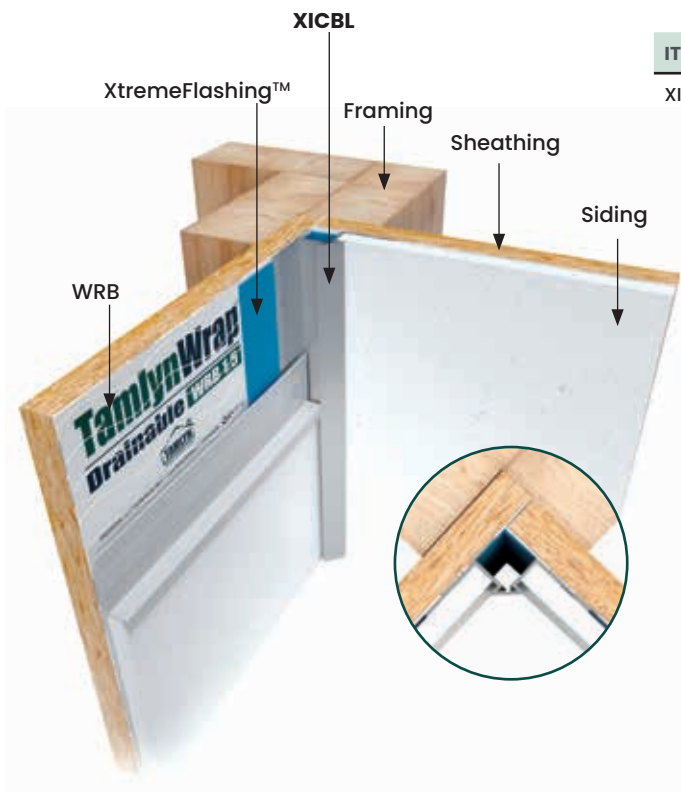
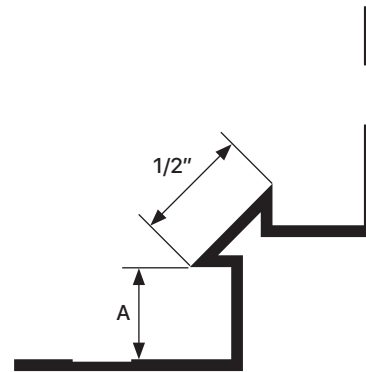
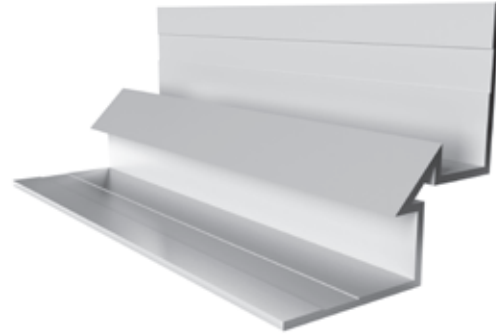

All measurements are nominal

ITEM ID	A
XICBL516	3/8"

All parts are 10' Length unless otherwise indicated

XICBP

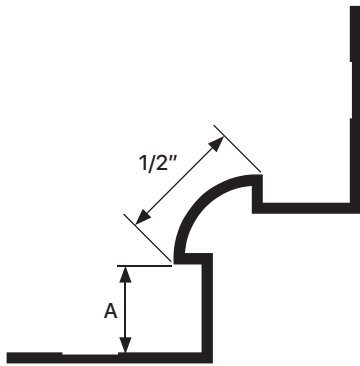

All measurements are nominal

ITEM ID	A
XICBP516	3/8"

All parts are 10' Length unless otherwise indicated

DESIGN FEATURES

Bold inside corner with a round projection.

MATERIAL

6063-T5 .050" ± .005 extruded aluminum alloy with proprietary coating that protects against harsh weather conditions and allows for paint adhesion. For all other finish options refer to page 20.

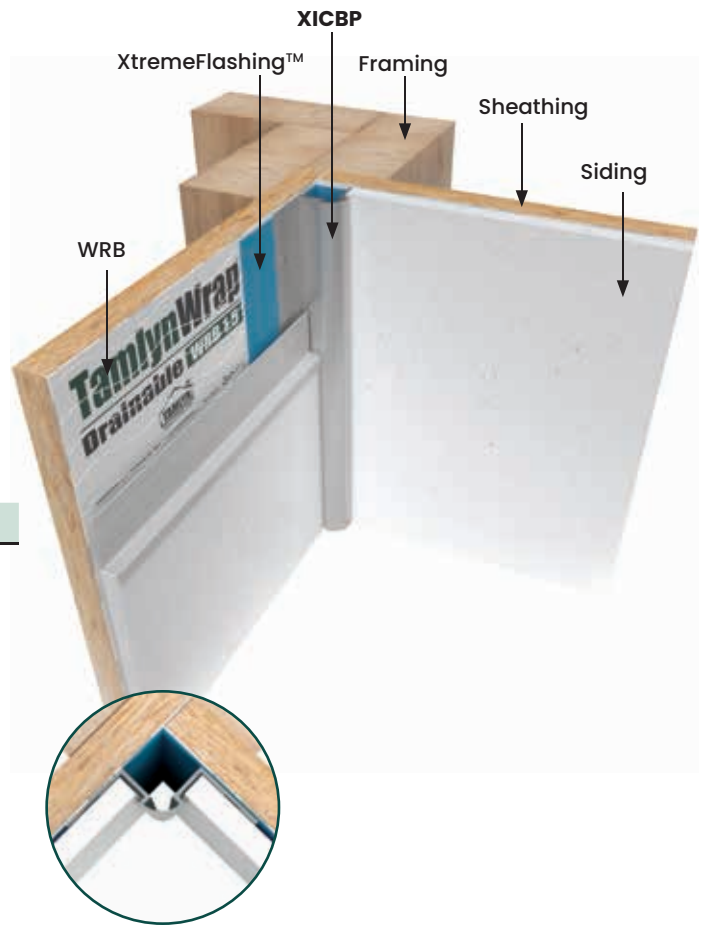



TERMINATION PROFILES

JMH

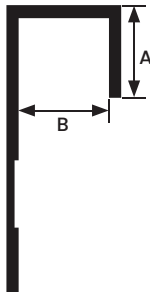
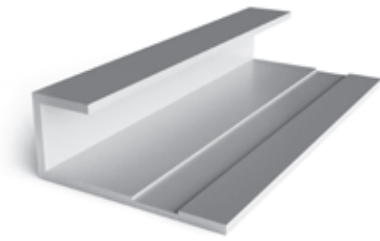

All measurements are nominal

ITEM ID	A	B
JMH516*	3/8"	3/8"
JMH716	3/8"	15/32"
JMH58	1/2"	5/8"
JMH34*	5/8"	3/4"
JMH1	3/8"	1"
JMH114	3/8"	1-1/4"
JMH112	3/8"	1-1/2"
JMH2	1/2"	2"

All parts are 10' Length unless otherwise indicated

*In Stock in BLACK ANODIZED

DESIGN FEATURES

Provides a clean finish at openings, at the edge of various siding materials and at material transitions. Specifically designed to work in conjunction with other profiles.

MATERIAL

6063-T5 .050" ± .005 extruded aluminum alloy with proprietary coating that protects against harsh weather conditions and allows for paint adhesion. For all other finish options refer to page 20.

NOTE

Do not install XtremeTrim® Standard J Mold horizontal applications where the exterior flange can catch/hold water.



DESIGN FEATURES

This is a highly versatile mold that works in complement with RV and RH profiles to continue the double bar look at multiple locations on a wall.

MATERIAL

6063-T5 .050 " ± .005 extruded aluminum alloy with proprietary coating that protects against harsh weather conditions and allows for paint adhesion. For all other finish options refer to page 20.

NOTE

Do not install XtremeTrim® Reveal J Mold on horizontal applications where the exterior flange can catch/hold water.

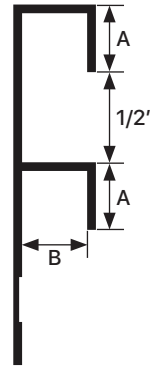
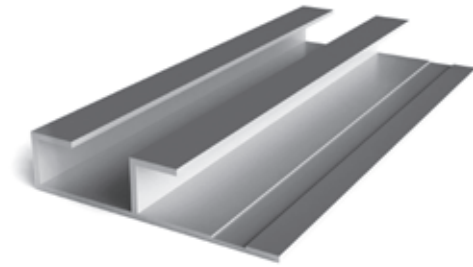

All measurements are nominal

ITEM ID	A	B
JMR516	3/8"	3/8"

All parts are 10' Length unless otherwise indicated

JMS

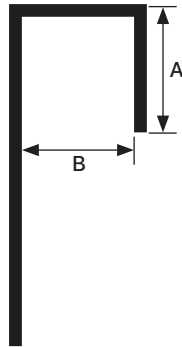
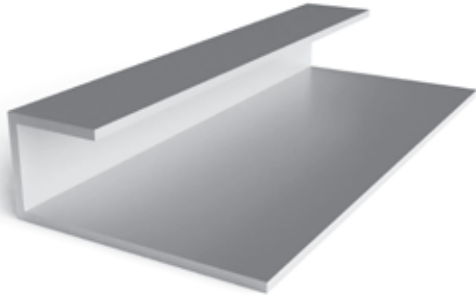

All measurements are nominal

ITEM ID	A	B	LENGTH
JMS5168	3/8"	5/16"	8'
JMS7168	3/8"	7/16"	8'
JMS588	3/8"	5/8"	8'

DESIGN FEATURES

Provides a clean finish at openings, edges of panels and at material transitions. True size designed as an independent profile. Use as a closure/cap piece only.

MATERIAL

6063-T5 .040" ± .005 extruded aluminum alloy with proprietary coating that protects against harsh weather conditions and allows for paint adhesion. For all other finish options refer to page 20.

NOTE

Do not install XtremeTrim® Basic J Mold on horizontal applications where the exterior flange can catch water.



DESIGN FEATURES

Provides a clean finish at openings, at the edge of various siding materials, and at material transitions while creating a reveal break. Complement the Vertical Reveal System.

MATERIAL

6063-T5 .050 " ± .005 extruded aluminum alloy with proprietary coating that protects against harsh weather conditions and allows for paint adhesion. For all other finish options refer to page 20.

NOTE

Do not install XtremeTrim® F Reveal on horizontal applications where the exterior flange can catch/hold water.

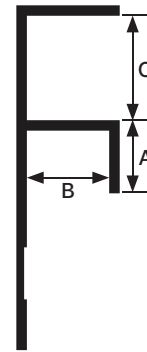
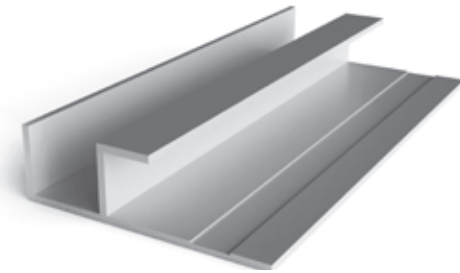

All measurements are nominal

ITEM ID	A	B	C
FR516	3/8"	3/8"	1/2"
FR716	3/8"	15/32"	1/2"
FR34	5/8"	3/4"	3/4"

All parts are 10' Length unless otherwise indicated

F

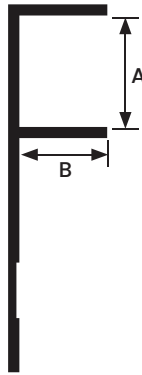
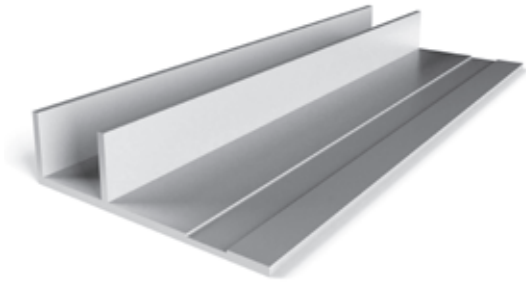

All measurements are nominal

ITEM ID	A	B
F516	1/2"	5/16"

All parts are 10' Length unless otherwise indicated

DESIGN FEATURES

Provides a clean finish at openings, at the edge of various siding materials, and at material transitions while creating a reveal break. Complement the Bead System.

MATERIAL

6063-T5 .050" ± .005 extruded aluminum alloy with proprietary coating that protects against harsh weather conditions and allows for paint adhesion. For all other finish options refer to page 20.

NOTE

Do not install XtremeTrim® F Trim on horizontal applications where the exterior flange can catch/hold water.



DESIGN FEATURES

Simple angle trim that can be adaptively used for multiple applications such as transition from panel to siding. Can also be used for facade/soffit transition and as an abutted stop alongside windows and doors.

MATERIAL

6063-T5 .045 " ± .005 extruded aluminum alloy with proprietary coating that protects against harsh weather conditions and allows for paint adhesion. For all other finish options refer to page 20.

NOTE

Do not install XtremeTrim® L Trim on horizontal applications where the exterior flange can catch/hold water.

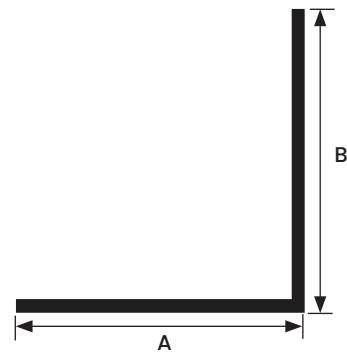
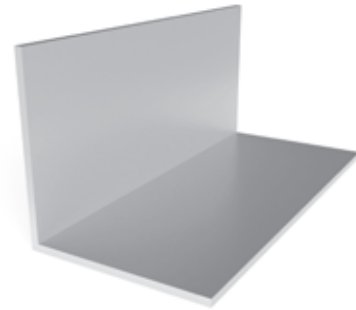

All measurements are nominal

ITEM ID	A	B
XL12	1/2"	1/2"
XL34	3/4"	3/4"
XL1	1"	1"
XL112	1-1/2"	1-1/2"

All parts are 10' Length unless otherwise indicated



SPECIALTY PROFILES

XHM

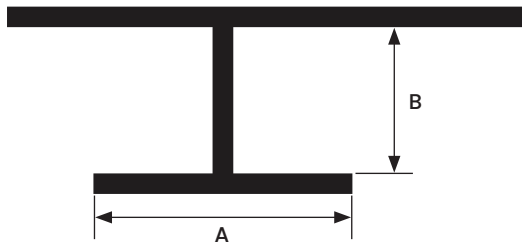
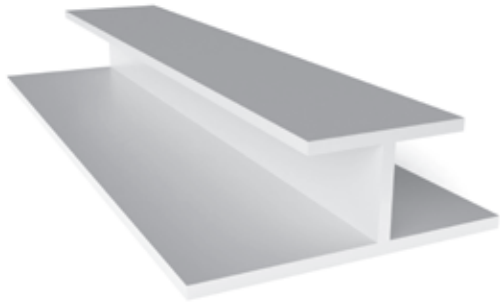

All measurements are nominal

ITEM ID	A	B
XHM148	1/2"	9/32"
XHM5168	1/2"	11/32"

All parts are 8' Length unless otherwise indicated

DESIGN FEATURES

Covers the seams of the soffit material providing a cleaner transition than simply butting the panels end-to-end.

MATERIAL

6063-T5 .045 " ± .005 extruded aluminum alloy with proprietary coating that protects against harsh weather conditions and allows for paint adhesion. For all other finish options refer to page 20.

NOTE

Do not install XtremeTrim® Soffit H Mold horizontal applications where the exterior flange can catch/hold water.

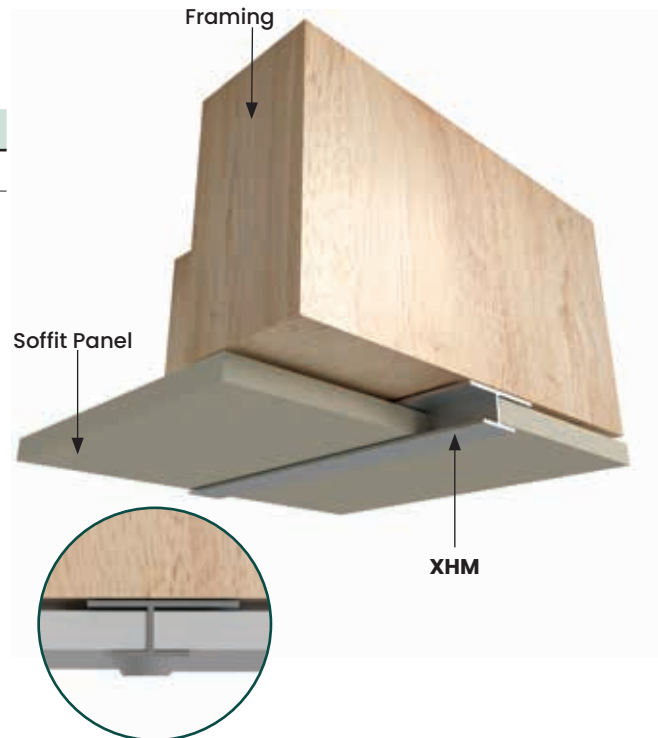

DESIGN FEATURES

Starter/bottom course best for lap siding. Provides ease-of-installation with correct angle. Also works with panel siding.

MATERIAL

6063-T5 .050" ± .005 extruded aluminum alloy with proprietary coating that protects against harsh weather conditions and allows for paint adhesion. For all other finish options refer to page 20.

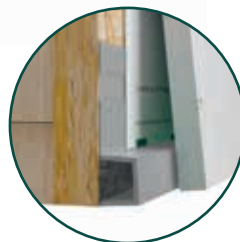
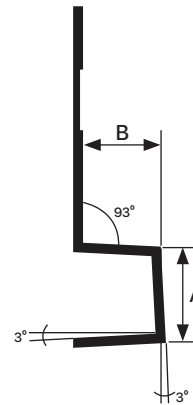

Also works with panel siding

All measurements are nominal

ITEM ID	A	B
XS516	3/8"	5/16"

All parts are 8' Length unless otherwise indicated

***In Stock in BLACK ANODIZED**

XWF

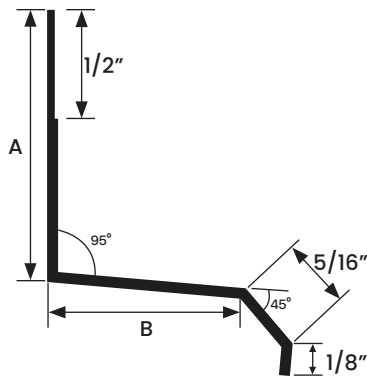
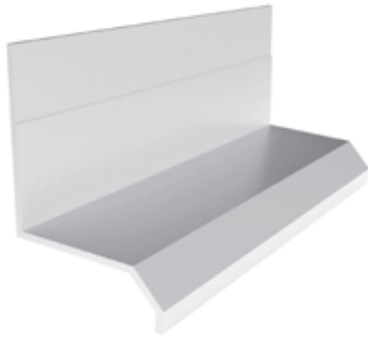

All measurements are nominal

ITEM ID	A	B
XWF78	1-1/4"	7/8"
XWF114	1-3/4"	1-1/4"
XWF112	1-1/4"	1-1/2"
XWF158	1-1/4"	1-5/8"
XWF2	2"	2"

All parts are 10' Length unless otherwise indicated

*In Stock in BLACK ANODIZED

DESIGN FEATURES

Provides an easy to install and long-lasting method of minimizing water penetration. Used over window trim, band boards, panel intersections, and material transitions.

MATERIAL

6063-T5 .045 " ± .005 extruded aluminum alloy with proprietary coating that protects against harsh weather conditions and allows for paint adhesion. For all other finish options refer to page 20.

NOTE

Do not install XtremeTrim® Window Flashing on horizontal applications where the exterior flange can catch/hold water.



SPECIAL ORDER ITEMS

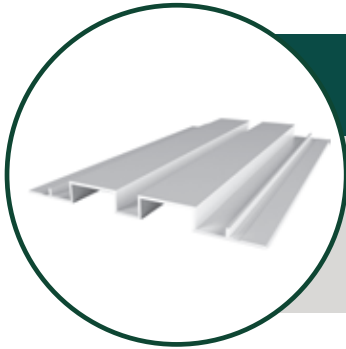

VERTICAL BATTEN REVEAL | RVBN

Unique design duplicates the look of a wood batten without the maintenance headaches while serving as a rust proof flashing between vertical siding. Design does not protrude beyond panel.

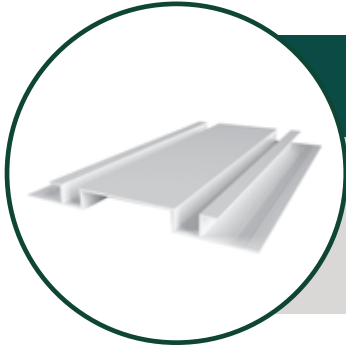

VERTICAL BOARD REVEAL | RVB

Design creates a broad vertical accent between siding panels while not protruding beyond the plane of the facade.

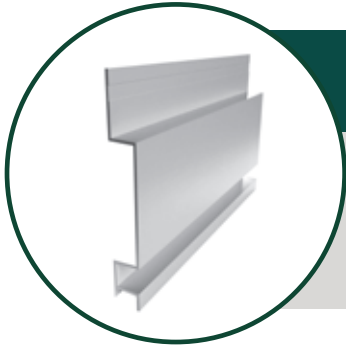

HORIZONTAL BOARD REVEAL | RHB

Design creates a broad horizontal accent within the plane of the wall without protruding beyond. Patented retention leg on the back prevents flexing with expansion. **US Patent #6,018,924**



1 X 2 BOARD OUTSIDE CORNER | XOC12

An outside corner that replicates a 1" x 2" for Board and Batten or Lap.

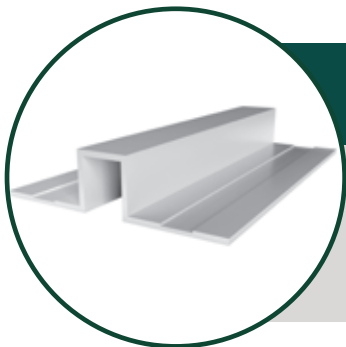

VERTICAL BOX T MOLD | TMB

Vertical Box T Mold serves as a wider, distinct joint between panels.

TAMLYN[®]

FAMILY. VALUE. SERVICE.



LOCATIONS

Houston
Dallas
Reno
Mexico City
Seoul
Sao Paulo
Edinburgh



ANNIVERSARY CELEBRATION
1971 30 YEARS 2001

TAMLYN



TAMLYN Corporate Headquarters

13623 Pike Rd, Stafford, TX 77477

www.tamlyn.com | office: 800-334-1676 | info@tamlyn.com