

DESIGN FEATURES

Create a curved seam line on any wall! Can be used in conjunction with drywall, panel installation and wrapped surface finishes such as fabric or vinyl wall coverings.

Available in 10' length. 6063 T5 aluminum with standard clear anodized or primed finish. Anodized color and powder coating finishes available with custom color matching.

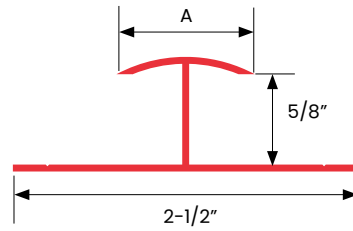
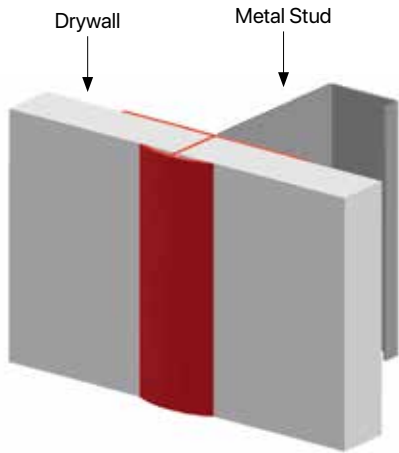
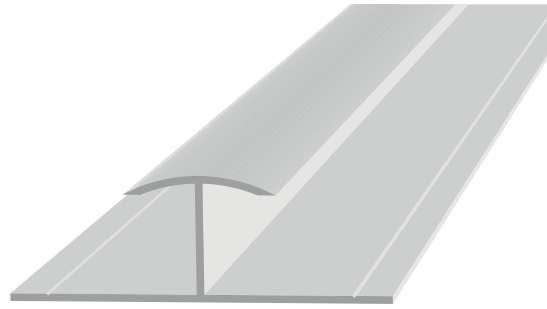

ITEM ID	A
MHC-12	1/2"
MHC-100	1"

