

BFF



DESIGN FEATURES

Flush finish design with less material allows for easy install without compromising the modern design. Ideal for transitioning between drywall and other materials or drywall and floors as a base profile. Ridged face provided for tape and float and pre-punched holes for easy install (hole placement may vary), adhesive is recommended for secure installation. Can be used in conjunction with drywall, panel installation and wrapped surface finishes such as fabric or vinyl wall coverings.

Available in 10' length. 6063 T5 aluminum with standard clear anodized or primed finish. Anodized color and powder coating finishes available with custom color matching.

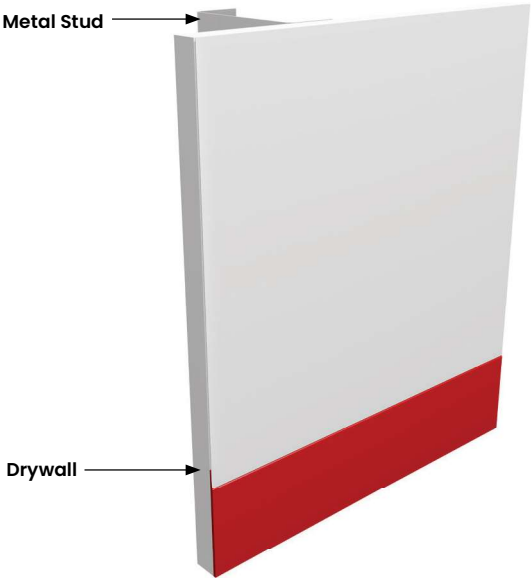

ITEM ID	A
BFF-250	2 - 1/2"
BFF-300	3"
BFF-350	3 - 1/2"
BFF-400	4"

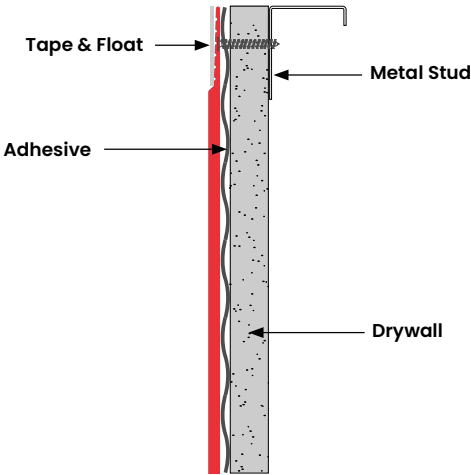

XtremeInterior™ profiles are subject to alterations with or without notice.