

XICLP

DESIGN FEATURES

Faces help to produce a clean and durable inside corner that complement many vertical and horizontal options.

MATERIAL

6063-T5 .050" ± .005 extruded aluminum alloy with proprietary coating that protects against harsh weather conditions and allows for paint adhesion. For all other finish options refer to page 20.

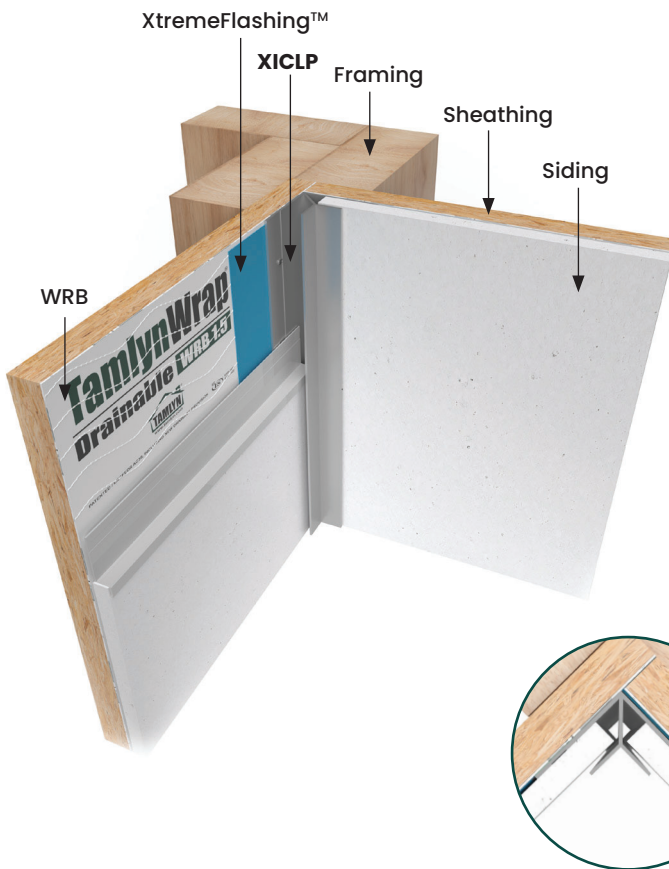
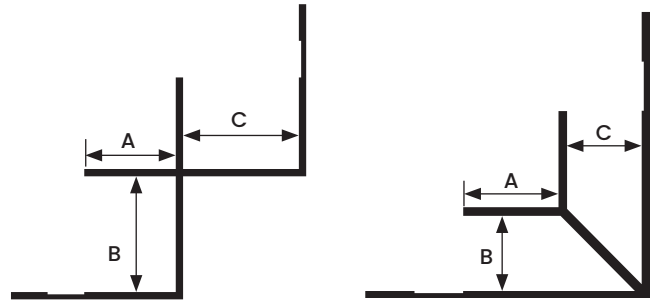
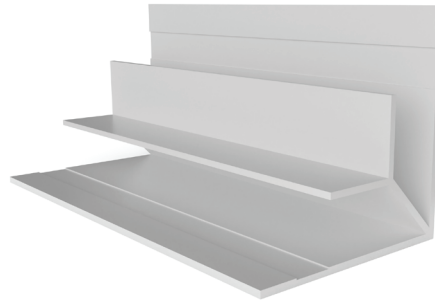

All measurements are nominal

ITEM ID	A	B	C
XICLP516*	3/8"	3/8"	3/8"
XICLP716	3/8"	15/32"	1/2"
XICLP34*	5/8"	3/4"	3/4"
XICLP1	7/16"	1"	1"

All parts are 10' Length unless otherwise indicated

*In Stock in BLACK ANODIZED