

DESIGN FEATURES

Simple and minimalist corner profile designed to provide protection for the edges of your 1/8" wall panels. Ridged face provided for tape and float and panel adhesive. Pre-punched holes for easy install (hole placement may vary). Can be used in conjunction with drywall, FRP & FRL installation and wrapped surface finishes such as fabric or vinyl wall coverings.

Available in 10' length. 6063 T5 aluminum with standard clear anodized or primed finish. Anodized color and powder coating finishes available with custom color matching.

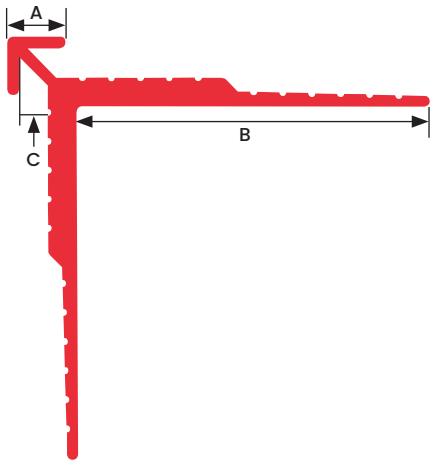
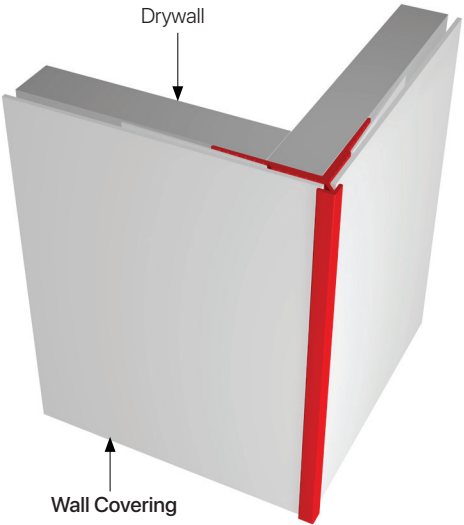

ITEM ID	A	B	C
MPOC	1/4"	1-1/2"	1/8"

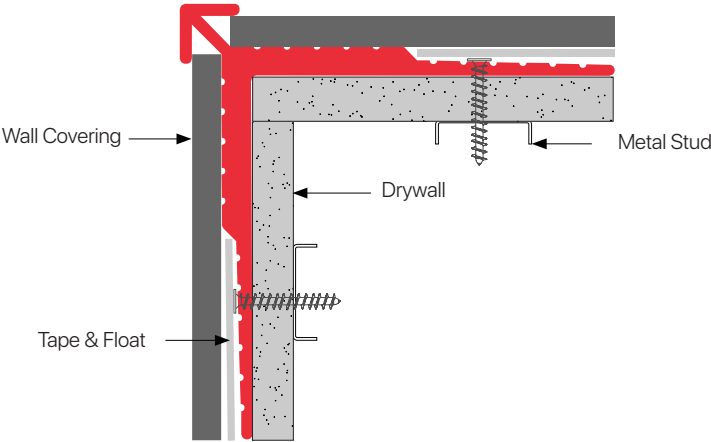

XtremeInterior™ profiles are subject to alterations with or without notice.